

ALL-PRO



RECESSED LIGHTING
THE ALL-PRO ADVANTAGE

ALL-PRO



ALL-PRO housings and trims are available in a variety of sizes ideal for any room of the house. Different style trims provide almost any desired lighting effect.



ALL-PRO housings are available to solve special lighting situations such as sloped ceilings. These housings allow the light to be aimed straight down regardless of ceiling pitch.

TABLE OF CONTENTS

The All Pro Advantage.....	4-7
4" Line Voltage Housings and Trims	8-13
4" Low Voltage Housings and Trims	14-19
5" Housings and Trims	20-29
6" IC Housings and Trims	30-41
6" Non IC Housings and Trims.....	42-53
6" IC "Universal" Housings and Trims	54-64
6" IC Shallow Ceiling Housings and Trims.....	65-71
6" Non-IC Shallow Ceiling Housings and Trims.....	72-77
6" Slope Ceiling Housings and Trims.....	78-81
Numerical Index.....	82





Conserve heating and air conditioning costs by using IC rated ALL-PRO housings that maintain an unbroken insulation barrier. IC AIR-TITE housings and trims also minimize drafts and prevent moisture damage in unconditioned attic spaces.



ALL-PRO remodel housings can be installed from below the ceiling in existing ceilings. Cut a hole in the ceiling using the template provided, bring power to fixture with flexible cable, make wiring connections and install housing.



ALL-PRO new construction housings are designed for installation in new construction or in existing ceilings where there is access above the ceiling. Hanger bars include a pre-installed nail and junction boxes are equipped with push-in wire connectors to simplify installation.

ALL-PRO

THE ALL-PRO ADVANTAGE



Full Line of Housings

- 4", 5", 6" Aperture Sizes
- AIR-TITE™
- Remodel
- Non-IC
- Shallow Ceiling
- New Construction
- Slope Ceiling
- Insulated Ceiling
- "No-Bracket-Bracket"
- Low Voltage



ALL-NAIL Bar Hanger

- Bar hangers have pre-installed nails.
- Bar hangers are pre-installed on housings.
- Integral T-Grid ceiling clip - No additional clips needed.
- Bar hangers can be re-oriented 90°.
- Bar hangers can be shortened without tools.



THE ALL-PRO ADVANTAGE



Locking Screw & Multiple Crimp Points

- Patented regressed screw locks hanger bars in position - regressed design does not interfere with ceiling material.
- Screw can be tightened with slotted or phillips screwdriver or nut driver.
- Five bar hanger locking points on the housing allow the downlight to stay in place during drywalling.



Push-In Wire Connectors

- Push-in wire connectors speed installation - simply strip and insert supply wires into connectors. No additional wire nuts are required.
- Standard on every ALL-PRO housing.
- Integral wire traps for non-metallic sheathed cable - no additional connectors necessary.
- Knockouts for metallic cable and rigid conduit connectors.
- Rated for through branch circuit wiring.



ALL-PRO

THE ALL-PRO ADVANTAGE

airtite™

COOPER Lighting



LISTINGS AND CODES

- ALL-PRO housings and trims are UL and cUL listed in appropriate categories
- Wide choice of AIR-TITE housings and trims to meet state codes as qualified per test standard ASTM-E283.
- Meets AIR-TITE Code standards of:
 - California Title 24
 - IEEC
 - New York - ECC
 - Washington State EC
- ALL-PRO housings and trims are part of the Cooper Lighting family of products



“No-Socket-Bracket” System

- “No-Socket-Bracket” housings and socket supporting trims speed installation of multiple units.
- Provides consistent lamp position in multiple units.



THE ALL-PRO ADVANTAGE



Wide Trim Selection

- Trim retention system choices include:
 - Torsion springs - Friction clips - Coil springs
- Many trims available in choice of torsion springs or friction clips.



Contractor Friendly Trim Rings

- All-Pro trims feature an extra wide trim ring.
- Helps hide any cutout irregularities.
- ERT707 and ERT709 trims in white and black baffle include both narrow style and wide style trim ring - use one, discard the other.



High Gloss Appliance White Finish

- Fingerprints don't show.
- Easy to clean.
- Matches appliances.
- Matches electrical devices - wall plates, switches etc.

ALL-PRO

ET400

4" Aperture

Non-IC Housing
for Use In
Uninsulated
Ceilings

Any Insulation
Present Must Be
Kept 3" From
Housing

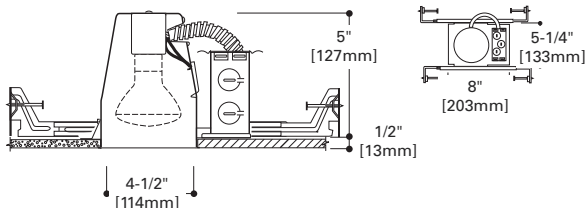

The ET400 is designed for use with small aperture trims. The shallow height allows it to be used in spaces where vertical height is limited. The ET400 can be installed in new construction or where there is access above the ceiling.

Housing: Die-stamped 20 gauge CRS with gray powder coat finish.

Plaster Frame: Housing is secured in plaster frame with spring barbs. The housing can be adjusted in the plaster frame to adjust for different ceiling materials. The housing can be removed from the plaster frame to provide access to the junction box.

Junction Box: Listed for through branch circuit wiring. Positioned to accommodate straight conduit runs. Four conduit knockouts are uniform 1/2" size with true pryout slots. Four "NM" (non-metallic) cable pryouts with integral strain relief also included. Quick-connect wiring connectors included.

Bar Hangers: Pre-installed, captive bar hangers allow housing to be positioned at any point within a 24" joist span. Score lines provided for easy shortening for 12" joists. Integral nail simplifies installation. Bar hangers can be repositioned 90°. Integral T-bar clip snaps onto T-bar spline for quick alignment.

Socket: Fixed position porcelain socket with nickel plated brass screw shell provides consistent lamp positioning. Shipping insert protects socket from overspray.

Thermal Protector: Self resetting thermal protector deactivates fixture if overheating occurs due to improper lamping or misapplied insulation.

- Labels:**
- UL/cUL Listed for Damp location
 - UL/cUL Listed for FeedThrough
 - IP rated for select trims



ET400R

4" Aperture

Non-IC Housing
for Use In
Uninsulated
Ceilings

Any Insulation
Present Must Be
Kept 3" From
Housing

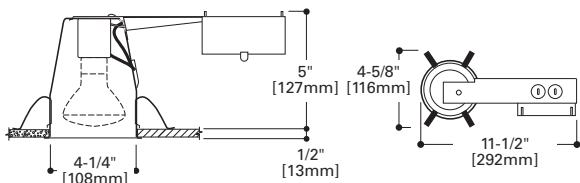

The ET400 is designed for use with small aperture trims. The shallow height allows it to be used in spaces where vertical height is limited. The ET400R can be installed from below the ceiling.

Housing: Die-stamped 20 gauge CRS with gray powder coat finish.

Junction Box: Listed for through branch circuit wiring. Seven conduit knockouts are uniform 1/2" size with true pryout slots. Four "NM" (non-metallic) cable pryouts with integral strain relief also included. Quick-connect wiring connectors included.

Socket: Fixed position porcelain socket with nickel plated brass screw shell provides consistent lamp positioning. Shipping insert protects socket against overspray

Remodel Clips: Four remodel clips secure housing and accommodate 1/2" and 5/8" ceiling thickness.

Thermal Protector: Self resetting thermal protector deactivates fixture if overheating occurs due to improper lamping or misapplied insulation.

Labels:

- UL/cUL Listed for Damp Location
- UL/cUL Listed for FeedThrough



ALL-PRO

EI400AT



4" Aperture
IC AIR-TITE
Housing for
Insulated
Ceilings

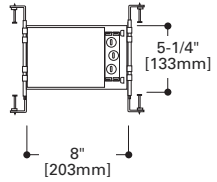
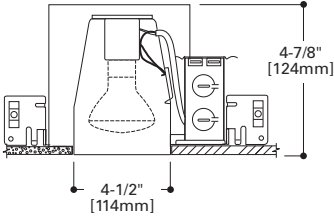

The EI400AT is a small aperture housing for providing accent and task lighting. The EI400AT is designed for use in insulated ceilings where it will be in direct contact with insulation. It is an AIR-TITE housing designed to prevent air flow between living spaces and unconditioned attic areas.



Housing: Double wall aluminum construction helps dissipate heat. Housing is secured in plaster frame with spring barbs. The inner housing can be adjusted in the plaster frame to compensate for different ceiling materials.

Plaster Frame: Galvanized steel construction. The inner housing can be removed from the plaster frame to provide access to the junction box. Plaster frame includes locking screws for hanger bars and cutouts for crimping hanger bars in position.

Junction Box: Listed for through branch circuit wiring. Positioned to accommodate straight conduit runs. Seven conduit knockouts are uniform 1/2" size with true pryout slots. Four "NM" (non-metallic) cable pryouts with integral strain relief also included. Quick-connect wiring connectors included.

Bar Hangers: Pre-installed, captive bar hangers allow housing to be positioned at any point within a 24" joist span. Score lines provided for easy shortening for 12" joists. Integral nail simplifies installation. Bar hangers can be repositioned 90°. Integral T-bar clip snaps onto T-bar spline for quick alignment.

Socket: Fixed position porcelain socket with nickel plated brass screw shell provides consistent lamp positioning. Shipping insert protects socket from overspray.

Thermal Protector: Self resetting thermal protector deactivates fixture if overheating occurs due to improper lamping.

Labels:

- UL/cUL Listed for Damp Location
- UL/cUL Listed for Feed Through
- UL/cUL Listed for Direct Contact with Insulation and combustible material

Meets following restricted air flow and IC requirements:

- State of California Title 24 Low Efficacy IC and AT requirements
- Washington State Energy Code
- International Energy Conservation Code (IECC)
- New York State Energy Conservation Construction Code (NY-ECCC)
- Certified Under ASTM-E283



ALL-PRO

Trims For ET400, ET400R, EI400AT



ERT403

High Gloss Appliance White Trim with Clear Specular Reflector

Clear Specular Reflector

ET400 ET400R	40W R16, 40W A19, 50W PAR20, 50W R20
EI400AT	50W R20, 50W PAR20

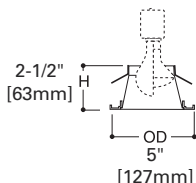

ERT401

High Gloss Appliance White Trim Ring with Black Baffle

Plastic Baffle

ET400 ET400R	50W PAR20, 50W R20
EI400AT	35W R20 (50W PAR20, 50W R20 with H1999 socket extender)



ERT401WHT

High Gloss Appliance White Trim Ring with White Baffle

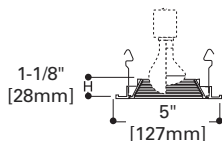

Trims For ET400, ET400R, EI400AT

Metal Baffle

Lamps for ERT413WHT:

ET400 ET400R EI400AT	40W R16, 40W A19, 50W PAR20, 50W R20
----------------------------	-----------------------------------------

Lamps for ERT413:

ET400 EI400AT	45W R20, 40W A19, 50W PAR20, 50W R20
ET400R	40W A19, 50W R20, 50W PAR20

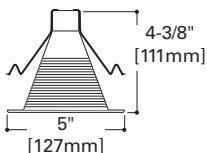

ERT413
High Gloss Appliance White Trim
Ring with Black Baffle



ERT413WHT
High Gloss Appliance White Trim
Ring with White Baffle

Eyeball - 30° Tilt

ET400 ET400R	40W R16, 60W PAR16
EI400AT	40W R16

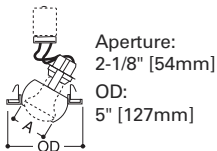

ERT402
High Gloss Appliance White Trim
Ring with White Eyeball



ALL-PRO

ET400LV

4" Aperture

Non-IC Housing for
Use In Uninsulated
Ceilings

Any Insulation
Present Must Be Kept
3" From Housing

12V Low Voltage
MR16 Lamp

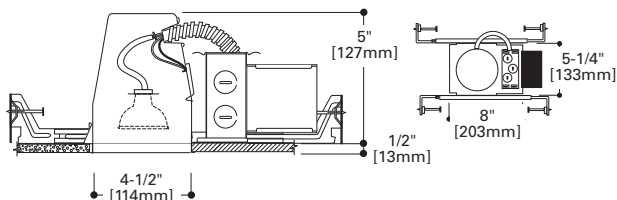

The ET400LV is a small aperture low voltage housing for providing accent and task lighting. The ET400LV is designed for use in non-insulated ceiling or for insulated ceilings but insulation must be kept 3" from all sides of the housing.

Housing: Die-stamped 20 gauge CRS with gray powder coat finish.

Plaster Frame: Housing is secured in plaster frame with spring barbs. The housing can be adjusted in the plaster frame to adjust for different ceiling materials. The housing can be removed from the plaster frame to provide access to the junction box.

Junction Box: Listed for through branch circuit wiring. Positioned to accommodate straight conduit runs. Four conduit knockouts are uniform 1/2" size with true pryout slots. Four "NM" (non-metallic) cable pryouts with integral strain relief also included. Quick-connect wiring connectors included.

Socket: Ceramic socket with reflector for bi-pin MR16 lamps.

Bar Hangers: Pre-installed, captive bar hangers allow housing to be positioned at any point within a 24" joist span. Score lines provided for easy shortening for 12" joists. Integral nail simplifies installation. Bar hangers can be repositioned 90°. Hangers fit onto T-bar spline for quick alignment.

Transformer: 120V Integral magnetic transformer steps line voltage down to lamp operating voltage. For MR16 lamps up to 50W.

Thermal Protector: Self resetting thermal protector deactivates fixture if overheating occurs due to improper lamping or misapplied insulation.

Labels

- UL/cUL Listed for Damp Location
- UL/cUL Listed for Feed Through
- IP Listed



ET400LVR

4" Aperture

Non-IC Housing for
Use In Uninsulated
Ceilings

Any Insulation
Present Must Be
Kept 3" From Housing

12V Low Voltage MR16
Lamp

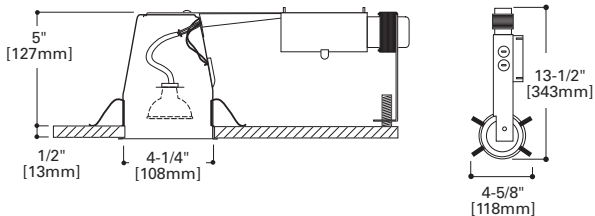

The ET400LVR is a small aperture low voltage remodel housing for providing accent and task lighting. The ET400LVR is designed for use in non-insulated existing ceiling or for insulated ceilings but insulation must be kept 3" from all sides of the housing. It can be installed from below the ceiling.

Housing: Die-stamped 20 gauge CRS with gray powder coat finish.

Junction Box: U.L. listed for through branch circuit wiring. Six conduit knockouts are uniform 1/2" size with true pryout slots. Four "NM" (non-metallic) cable pryouts with integral strain relief also included. Quick-connect wiring connectors included.

Socket: Ceramic socket with reflector disc for bi-pin MR16 lamps.

Remodel Clips: Four remodel clips secure housing and accommodate 1/2" and 5/8" ceiling thickness.

Transformer: 120V integral magnetic transformer steps line voltage down to lamp operating voltage. For MR16 lamps up to 50W.

Support: Helps support weight of junction box and transformer. Threaded stem can be adjusted for varying ceiling thicknesses.

Thermal Protector: Self resetting thermal protector deactivates fixture if overheating occurs due to improper lamping or misapplied insulation.

Labels

- UL/cUL Listed for Damp Location
- UL/cUL Listed for Feed Through



ALL-PRO

EI400LVAT



4" Aperture

IC AIR-TITE Housing for Insulated Ceilings

12V Low Voltage MR16 Lamp

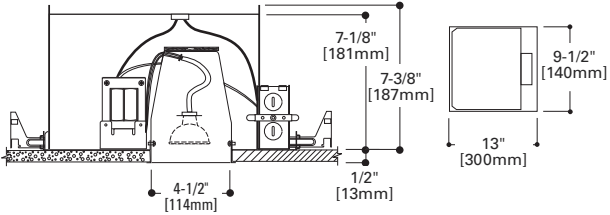

The EI400LVAT housing has an integral low voltage transformer that supplies 12 volts to MR16 lamps. It can be used in ceilings where it will be in direct contact with insulation. The EI400LVAT is suited for use in insulated ceilings in residential and commercial applications. It is an AIR-TITE housing designed to prevent air flow between living spaces and unconditioned attic spaces.



Housing: Double wall aluminum construction for greater heat dissipation. EI400LVAT housing is gasketed to prevent airflow from heated or air conditioned spaces.

Plaster Frame: Inner housing adjusts in plaster frame for ceilings up to 1" thick. Includes locking screws for hanger bars and cutouts for crimping hanger bars in position.

Junction Box: Listed for through branch circuit wiring. Positioned to accommodate straight conduit runs. Seven conduit knockouts are uniform 1/2" size with true pryout slots. Four "NM" (non-metallic) cable pryouts with integral strain relief also included. Quick-connect wiring connectors included.

Bar Hangers: Pre-installed, captive bar hangers allow housing to be positioned at any point within a 24" joist span. Score lines provided for easy shortening for 12" joists. Integral nail simplifies installation. Bar hangers can be repositioned 90°. Hangers fit onto T-bar spline for quick alignment.

Transformer: 120V integral magnetic transformer steps line voltage down to lamp operating voltage.

Thermal Protector: Self resetting thermal protector deactivates fixture if overheating occurs due to improper lamping.

Labels:

- UL/cUL Listed for Damp Location
- UL/cUL Listed for Feed Through
- UL/cUL Listed for Direct Contact with Insulation and combustible material

Meets following requirements:

- State of California Title 24 Low Efficacy IC and Air Tite
- Washington State Energy Code
- International Energy Conservation Code (IECC)
- New York State Energy Conservation Construction Code (NY-ECCC)
- Certified Under ASTM-E283



ALL-PRO

Trims For ET400LV, ET400LVR, EI400LVAT



ERT403LV

High Gloss Appliance White Trim with Clear Specular Reflector



ERT403LVG

High Gloss Appliance White Trim with Gold Reflector

Specular Reflector

- "Cat's paw" retention spring

ET400LV ET400LVR ET400LVAT	12V 50W MR16
----------------------------------	--------------

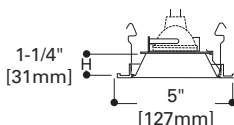

ERT401LV

High Gloss Appliance White Trim with Black baffle



ERT401LVW

High Gloss Appliance White Trim with White Baffle

Baffle

- "Cat's paw" retention spring

ET400LV ET400LVR ET400LVAT	12V 50W MR16
----------------------------------	--------------

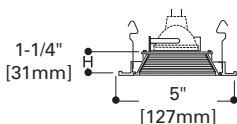

Trims For ET400LV, ET400LVR, EI400LVAT

Eyeball - 30° Tilt

- "Cat's paw" retention spring

ET400LV ET400LVR ET400LVAT	12V 50W MR16
----------------------------------	--------------

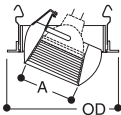

Aperture:
2" [51mm]
OD:
5" [127mm]



ERT402LV
High Gloss Appliance White Trim
with White Eyeball

Slot Aperture

- "Cat's paw" retention spring

ET400LV ET400LVR ET400LVAT	12V 50W MR16
----------------------------------	--------------

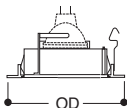

Slot:
1-3/8" x 2-1/8"
[35mm x 54mm]
OD:
5" [127mm]



ERT404LV
High Gloss Appliance White Trim
and Slot



ALL-PRO

ET500

5" Aperture

Non-IC Housing for
Use In Uninsulated
Ceilings

Any Insulation
Present Must Be
Kept 3" From
Housing

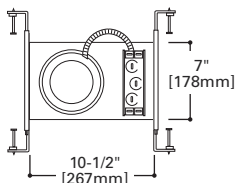
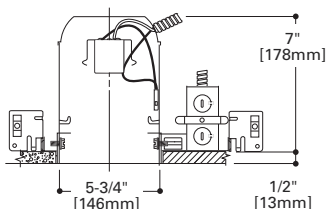

The ALL-PRO ET500 has a 5" aperture designed for PAR20 and PAR30 halogen lamps. The 5" diameter trim size makes this series the right choice for applications where dramatic yet inconspicuous lighting is required and higher wattages are desired. If the ET500 is used in insulated ceilings, insulation must be kept 3" from all sides of fixture.

Housing: Die-stamped 22 gauge CRS with white powder coat finish. Housing adjusts in plaster frame to accommodate ceiling up to 1-3/8" thick.

Plaster Frame: Galvanized steel construction. The housing can be removed from plaster frame to provide access to the junction box. Regressed locking screw for securing hanger bars. Cutouts for easily crimping hanger bars in position

Junction Box: Listed for through branch circuit wiring. Positioned to accommodate straight conduit runs. Seven conduit knockouts are uniform 1/2" size with true pryout slots. Four "NM" (non-metallic) cable pryouts with integral strain relief also included. Quick-connect wiring connectors included.

Bar Hangers: Pre-installed, captive bar hangers allow housing to be positioned at any point within a 24" joist span. Score lines provided for easy shortening for 12" joists. Integral nail simplifies installation. Bar hangers reposition 90°. Integral T-bar clip snaps onto T-bar spline for quick alignment.

Socket: Porcelain socket with nickel plated brass screw shell snaps into trim for consistent lamp positioning. Shipping insert protects socket from overspray.

Thermal Protector: Self resetting thermal protector deactivates fixture if overheating occurs due to improper lamping or incorrect application of insulation material.

- Labels**
- UL/cUL listed for Damp Location
 - UL/cUL listed for Feed Through
 - IP Rated



ET500R

5" Aperture

Non-IC Housing for
Use In Uninsulated
Ceilings

Any Insulation
Present Must Be
Kept 3" From
Housing

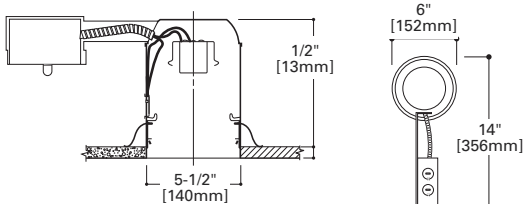

The ALL-PRO ET500R remodel housing has a 5" aperture designed for PAR20 and PAR30 halogen lamps. The five inch" diameter trim size makes this series the right choice for applications where dramatic yet inconspicuous lighting is required and higher wattages are desired. If the ET500R is used in insulated ceilings, insulation must be kept 3" from all sides of fixture. The ET500R can be installed from below the ceiling.

Housing: Die-stamped 22 gauge CRS with white powder coat finish. Housing will slip through 5-1/2" ceiling opening. Integral flange secures fixture against ceiling.

Remodel Clips: Four remodel clips secure housing and accommodate 1/2" and 5/8" ceiling thickness.

Junction Box: Listed for through branch circuit wiring. Positioned to accommodate straight conduit runs. Seven conduit knockouts are uniform 1/2" size with true pryout slots. Four "NM" (non-metallic) cable pryouts with integral strain relief also included. Quick-connect wiring connectors included.

Socket: Porcelain socket with nickel plated brass screw shell, snaps into trim for consistent lamp positioning. Shipping insert protects socket from overspray.

Thermal Protector: Self resetting thermal protector deactivates fixture if an incorrect lamp is used or if ceiling insulation material is not applied correctly.

Labels:

- UL/cUL listed for damp location
- UL/cUL listed for Feed Through
- IP Rated



ALL-PRO

EI500AT

airtite

5" Aperture

IC AIR-TITE
Housing for
Insulated
Ceilings

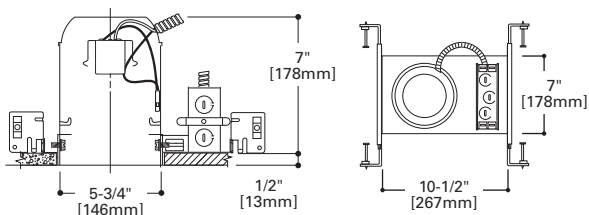

The ALL-PRO EI500AT has a 5" aperture designed for PAR20 and PAR30 halogen lamps. EI500AT is designed for use in insulated ceilings and may be completely covered in insulation. AIR-TITE™ design meets restricted air flow requirements.

Housing: Gasketed die-stamped 20 gauge aluminum. Housing adjusts for ceilings up to 1-3/8" thick. AIR-TITE gasket supplied with housing to complete ASTM-E283 installation.

Plaster Frame: Galvanized steel construction. The housing can be removed from plaster frame to provide access to the junction box. Regressed locking screw secures hanger bars. Cutouts provided for easily crimping hanger bars in position.

Junction Box: Listed for through branch circuit wiring. Positioned to accommodate straight conduit runs. Seven conduit knockouts are uniform 1/2" size with true pryout slots. Four "NM" (non-metallic) cable pryouts with integral strain relief also included. Quick-connect wiring connectors included.

Bar Hangers: Pre-installed, captive bar hangers allow housing to be positioned at any point within a 24" joist span. Regressed set screw locks hanger bars in position. Score lines allow shortening for 12" joists. Integral nail simplifies installation. Bar hangers can be repositioned 90° without tools. Integral T-bar clip snaps onto T-bar spline for quick alignment.

Socket: Porcelain socket with nickel plated brass screw shell, snaps into trim for consistent lamp positioning. Shipping insert protects socket from overspray.

Thermal Protector: Self resetting thermal protector deactivates fixture if overheating occurs due to improper lamping.

Labels:

- UL/cUL Listed for Damp Location
- UL/cUL Listed for FeedThrough
- UL/cUL Listed for Direct Contact with Insulation and combustible material

Meets following restricted air-flow and IC requirements:

- State of California Title 24 Low Efficacy Luminaire IC and AT requirement
- Washington State Energy Code
- International Energy Conservation Code (IECC)
- New York State Energy Conservation Construction Code (NY-ECCC)
- Certified Under ASTM-E283

EI500RAT

air-tite™

5" Aperture
IC AIR-TITE
Housing for
Insulated
Ceilings
Remodel Housing

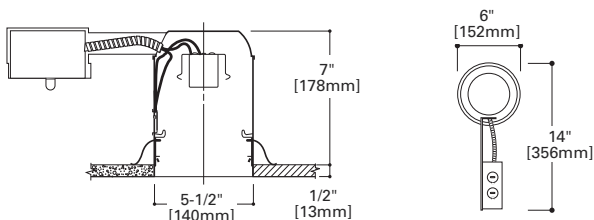

The ALL-PRO EI500RAT housing has a 5" aperture designed for PAR20 and PAR30 halogen lamps. Designed for use in insulated ceilings and may be completely covered in insulation. This is an AIR-TITE housing and meets restricted airflow requirements. The EI500RAT can be installed from below the ceiling.

Housing: Die stamped 20 gauge aluminum. Integral flange secures fixture against ceiling. Pre-installed AIR-TITE gasket completes ASTM-E283 installation.

Remodel Clips: Four remodel clips secure housing and accommodate 1/2" and 5/8" ceiling thickness.

Junction Box: Listed for through branch circuit wiring. Seven conduit knockouts are uniform 1/2" size with true pryout slots. Four cable pryouts simplify NM (non-metallic) cable installation. Quick-connect wiring connectors included.

Socket: Porcelain socket with nickel plated brass screw shell, snaps into trim for consistent lamp positioning. Shipping insert protects socket from overspray.

Thermal Protector: Integral thermal protector deactivates fixture if an incorrect lamp is used or if insulation material is applied incorrectly.

Labels.

- UL/cUL Listed for Damp Location
- UL/cUL Listed for Feed Through
- UL/cUL Listed for Direct Contact with Insulation and combustible material

Meets following restricted air-flow and IC requirements:

- State of California Title 24 Low Efficacy Luminaire IC and AT requirement
- Washington State Energy Code
- International Energy Conservation Code (IECC)
- New York State Energy Conservation Construction Code (NY-ECCC)
- Certified Under ASTM-E283



ALL-PRO

Trims For ET500, ET500R, EI500AT, EI500RAT



ERT520G

High Gloss Appliance White Trim with Gold Reflector Cone



ERT520WHT

High Gloss Appliance White Trim with White Reflector Cone



ERT520

High Gloss Appliance White Trim with Clear Specular Reflector Cone

Reflector Cone

- Torsion Springs pull trim tight to ceiling

ET500 ET500R	75W R30, 75W PAR30, 75W PAR30L, 65W BR30
EI500AT	50W R30, 60W BR30, 75W PAR30
EI500RAT	50W PAR30L, 50W PAR30, 60W BR30

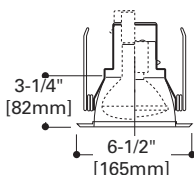

ERT521

High Gloss Appliance White Trim with Clear Specular Reflector



ERT521G

High Gloss Appliance White Trim with Gold Reflector

Reflector

- Torsion Springs pull trim tight to ceiling

ET500 ET500R	60W A19
EI500AT EI500RAT	40W A19

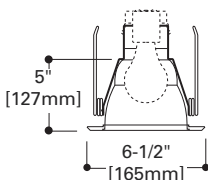

Trims For ET500, ET500R, EI500AT, EI500RAT

Metal Baffle Splay

- Torsion Springs pull trim tight to ceiling

ET500 ET500R	50W R20, 50W PAR20, 75W R30, 75W PAR30
EI500AT	50W PAR20, 50W R20, 65W BR30, 75W PAR30
EI500RAT	30W R20, 35W PAR20, 50W PAR30, 50W PAR30L, 60W BR30

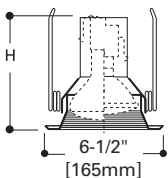

ERT501
High Gloss Appliance White Trim with Black Baffle



ERT501WHT
High Gloss Appliance White Trim with White Baffle

Metal Baffle

- Torsion Springs pull trim tight to ceiling

ET500 ET500R	65W BR30, 75W R30, 75W PAR30
EI500AT	60W BR30, 50W PAR30
EI500RAT	60W BR30, 50W PAR30, 50W PAR30L

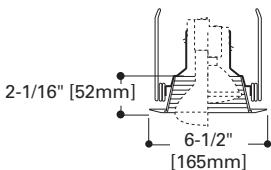

ERT510
High Gloss Appliance White Trim with Black Baffle



ERT510WHT
High Gloss Appliance White Trim with White Baffle

Deep Coilex™ Baffle

- Torsion Springs pull trim tight to ceiling

ET500 ET500R	75W R30, 75W PAR30
-----------------	--------------------

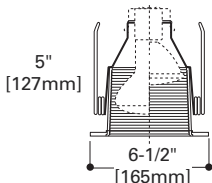

ERT512
High Gloss Appliance White Trim with Black Baffle



ERT512WHT
High Gloss Appliance White Trim with White Baffle

ALL-PRO

Trims For ET500, ET500R, EI500AT, EI500RAT



ERT513WHT

High Gloss Appliance White Trim with White Baffle

Baffle

- Friction Clip retention
- Lamps-ERT513WHT:

ET500 ET500R	75W A19, 65W BR30, 75W R30, 75W PAR30L
EI500AT EI500RAT	65W BR30, 75W PAR30L



ERT513

High Gloss Appliance White Trim with Black Baffle

- Lamps-ERT513:

ET500 ET500R	60W A19, 65W BR30, 75W R30, 75W PAR30L
EI500AT EI500RAT	65W BR30, 50W PAR30L

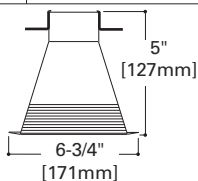

ERT513WHTTS

High Gloss Appliance White Trim with White Baffle and with torsion spring construction

Baffle

- Friction Clip retention
- Lamps-ERT513WHTTS:

ET500 ET500R	75W A19, 65W BR30, 75W R30, 75W PAR30L
EI500AT EI500RAT	65W BR30, 75W PAR30L



ERT513TS

High Gloss Appliance White Trim with Black Baffle and with torsion spring construction

- Lamps-ERT513TS:

ET500 ET500R	60W A19, 65W BR30, 75W R30, 75W PAR30L
EI500AT EI500RAT	65W BR30, 50W PAR30L

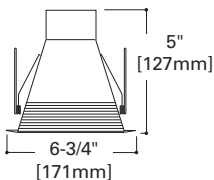

Trims For ET500, ET500R, EI500AT, EI500RAT

Gimbal - 25° Tilt

- Torsion Springs pull trim tight to ceiling

ET500 ET500R	75W PAR30
EI500AT EI500RAT	75W PAR30



ERT560
High Gloss Appliance White Trim with White Gimbal

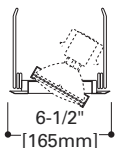

Eyeball 30° Tilt

- Torsion Springs pull trim tight to ceiling

ET500 ET500R EI500AT EI500RAT	75W PAR30
----------------------------------------	-----------



ERT570
High Gloss Appliance White Trim with White Eyeball

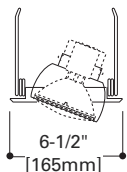

ERT570PB
Polished Brass Trim with Polished Brass Eyeball

Eyeball - 30° Tilt

- Torsion Springs pull trim tight to ceiling

ET500 ET500R EI500AT EI500RAT	50W R20, 50W PAR20
----------------------------------------	--------------------



ERT571
High Gloss Appliance White Trim with White Eyeball

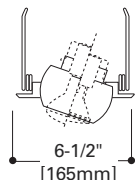

ALL-PRO

Trims For ET500, ET500R, EI500AT, EI500RAT



ERT500

High Gloss Appliance White Splay Trim

Splay Trim

- Torsion Springs pull trim tight to ceiling

ET500 ET500R	65W BR30, 75W R30, 75W PAR30
EI500AT	65W BR30, 75W PAR30, 75W R30
EI500RAT	50W PAR30, 75W PAR30L, 60W BR30

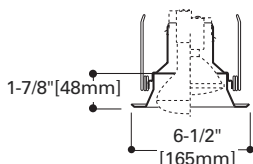

ERT550

High Gloss Appliance White Trim with Frosted Drop Diffuser - AIR-TITE Trim*



Frosted Drop Glass Shower Light

- Torsion Springs pull trim tight to ceiling

ET500 ET500R	75W A19, 75W PAR30
EI500AT EI500RAT	40W A19, 50W PAR30

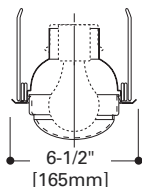

ERT551

High Gloss Appliance White Trim with Frosted Lens



Frosted Glass Lens Shower Light

- Torsion Springs pull trim tight to ceiling

ET500 ET500R	60W A19, 50W PAR30, 50W PAR30L, 65W BR30
EI500AT EI500RAT	35W PAR30L

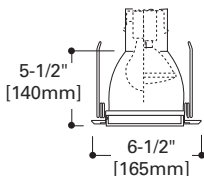

Trims For ET500, ET500R, EI500AT, EI500RAT

Fresnel Glass Lens Shower Light

- Wet location listed for use in showers

ET500 ET500R	60W A19, 50W PAR30, 50W PAR30L, 65W BR30
EI500AT EI500RAT	35W PAR30L

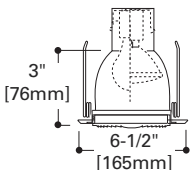

ERT552

High Gloss Appliance White Trim with Fresnel lens



Wall Wash

- Torsion Springs pull trim tight to ceiling

ET500 ET500R	50W TB19, 60W A19, 60W BT15, 60W MB19
-----------------	------------------------------------------

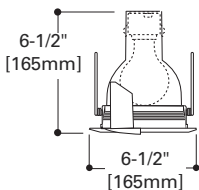

ERT530

High Gloss Appliance White Trim with White Scoop and Black Baffle



ERT530WHT

High Gloss Appliance White Trim with White Scoop and White Baffle



ALL-PRO

EI700

6" Aperture

IC Housing for
Insulated
Ceilings

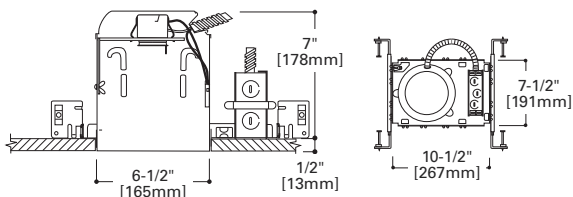

The ALL-PRO EI700 housing is designed for use in insulated ceilings where the housing will be in direct contact with insulation material.

Housing: Aluminum construction for greater heat dissipation.

Socket Plate: Rigid socket plate adjusts and locks without tools for various lamp sizes.

Plaster Frame: Housing adjusts in plaster frame to accommodate up to 1-3/4" thick ceilings. Plaster frame includes locking screw for securing hanger bars and cutouts for crimping hanger bars in position.

Junction Box: Listed for through branch circuit wiring. Positioned to accommodate straight conduit runs. Seven conduit knockouts are uniform 1/2" size with true pryout slots. Four pryouts with integral strain relief simplify non-metallic sheathed cable installation. Quick-connect wiring connectors included.

Bar Hangers: Pre-installed, captive bar hangers allow housing to be positioned at any point within a 24" joist span. A set screw locks housing in position. Score lines allow field shortening for 12" joists. Integral nail simplifies installation. Bar hangers can be repositioned 90° without tools. Integral T-bar clip snaps onto T-bar spline for quick alignment.

Socket: Porcelain socket with nickel plated brass screw shell. Shipping insert protects socket against overspray

Thermal Protector: Self resetting thermal protector deactivates fixture if overheating occurs due to improper lamping.

- Labels**
- UL/cUL listed for direct contact with Insulation and Combustible Material
 - UL/cUL Listed for Feed Through
 - UL/cUL Listed for Damp Location
 - IP Rated



EI700R

6" Aperture

IC Housing for
Insulated
Ceilings

Remodel
Housing

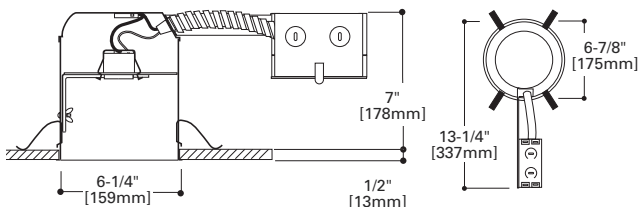

The ALL-PRO EI700R remodel housing is designed for installations where the housing will be in direct contact with insulation. The housing can be installed from below the ceiling.

Housing: Aluminum housing for greater heat dissipation.

Socket Plate: Rigid socket plate adjusts and locks without tools for various lamp sizes.

Junction Box: Listed for through branch circuit wiring. Seven conduit knockouts are uniform 1/2" size with true pryout slots. Four "NM" (non-metallic) cable pryouts with integral strain relief included. Quick-connect wiring connectors included.

Remodel Clips: Four remodel clips secure housing and accommodate 1/2" and 5/8" ceiling thickness.

Socket: Porcelain socket with nickel plated brass screw shell. Shipping insert protects socket against overspray.

Thermal Protector: Self resetting thermal protector deactivates fixture if overheating occurs due to improper lamping.

- Labels**
- UL/cUL Listed for Damp Location
 - UL/cUL Listed for Feed Through
 - UL/cUL Listed for Direct Contact with Insulation and Combustible Material



ALL-PRO

EI700AT

air-tite

6" Aperture

IC AIR-TITE
Housing for
Insulated
Ceilings

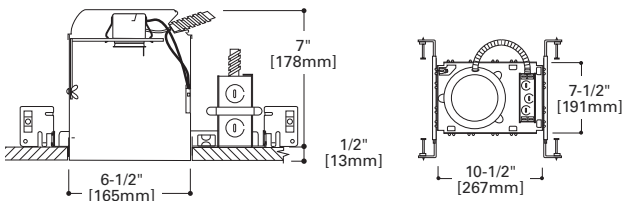

The EI700 housing is designed for use in insulated ceilings where the housing will be in direct contact with insulation. This housing also meets restricted airflow requirements.

Housing: Aluminum construction for greater heat dissipation. Air-Tite gasket supplied with housing to complete ASTM-E283 installation.

Socket Plate: Rigid socket plate adjusts and locks without tools for various lamp sizes.

Plaster Frame: Housing adjusts in plaster frame for up to 1" thick ceilings. Plaster frame has locking screw for hanger bars and cutouts for crimping hanger bars in position.

Junction Box: Listed for through branch circuit wiring. Positioned to accommodate straight conduit runs. Seven conduit knockouts are uniform 1/2" size with true pryout slots. Four pryouts with integral strain relief for non-metallic sheathed cable installation. Quick-connect wiring connectors included.

Bar Hangers: Pre-installed, captive bar hangers allow housing to be positioned at any point within a 24" joist span. A set screw locks bar hangers in position. Score lines allow shortening for 12" joists. Integral nail simplifies installation. Bar hangers can be repositioned 90° without tools. Integral T-bar clip snaps onto T-bar spline for quick alignment.

Socket: Porcelain socket with nickel plated brass screw shell. Shipping insert protect socket from overspray.

Thermal Protector: Self resetting thermal protector deactivates fixture if overheating occurs due to improper lamping.

Labels

- UL/cUL Listed for Damp Location
- UL/cUL Listed for Feed Through
- UL/cUL Listed for Direct Contact with Insulation and Combustible Material

Meets following restricted air-flow and IC requirements:

- Washington State Energy Code
- State of California Title 24 Low Efficacy Luminaire IC and AT
- International Energy Conservation Code (IECC)
- New York State Energy Conservation Construction Code (NY-ECCC)
- Certified Under ASTM-E283

EI700RAT

6" Aperture

IC AIR-TITE
Housing for
Insulated
Ceilings

Remodel
Housing

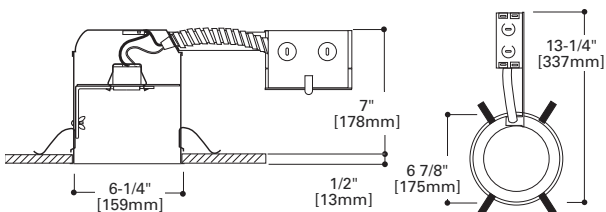

The EI700RAT Remodel Housing is designed for installations where the housing will be in direct contact with insulation. This housing also meets restricted airflow requirements. It can be installed from below the ceiling.

Housing: Aluminum housing for greater heat dissipation. Air-Tite gasket pre-installed with housing for a complete ASTM-E283 installation.

Socket Plate: Rigid socket plate adjusts and locks without tools for various lamp sizes.

Junction Box: Listed for through branch circuit wiring. Seven conduit knockouts are uniform 1/2" size with true pryout slots. Four NM (non-metallic) cable pryouts with integral strain relief included. Quick-connect wiring connectors included.

Remodel Clips: Four remodel clips secure housing and accommodate 1/2" and 5/8" ceiling thickness.

Socket: Porcelain socket with nickel plated brass screw shell. Shipping insert protects socket against overspray.

Thermal Protector: Self resetting thermal protector deactivates fixture if overheating occurs due to improper lamping.

Labels

- UL/cUL Listed for Damp Location
- UL/cUL Listed for Feed Through
- UL/cUL Listed for Direct Contact with Insulation and combustible material

Meets following restricted air-flow and IC requirements:

- State of California Title 24 Low Efficacy Luminaire IC and AT Requirement
- Washington State Energy Code
- International Energy Conservation Code (IECC)
- New York State Energy Conservation Construction Code (NY-ECCC)
- Certified Under ASTM-E283



ALL-PRO

EI700ATNB

*air*tite™

6" Aperture

IC AIR-TITE
Housing for
Insulated
Ceilings

No Socket
Bracket

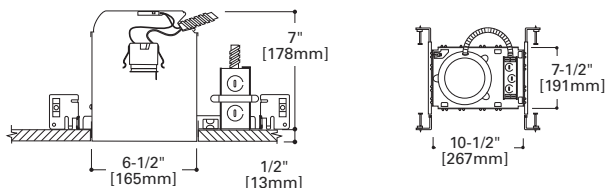

The ALL-PRO EI700ATNB AIR-TITE housing is designed for installations where it will be in direct contact with insulation and it meets restricted air flow requirements. It is designed without a socket plate for use with socket supporting trims only. There is no need to spend time adjusting or disconnecting the socket and removing the socket plate.

Housing: Aluminum construction for greater heat dissipation. Air-Tite gasket supplied with housing to complete ASTM-E283 installation.

Plaster Frame: Housing adjusts in plaster frame 1" to accommodate different ceiling thicknesses.

Junction Box: Listed for through branch circuit wiring. Positioned to accommodate straight conduit runs. Seven conduit knockouts are uniform 1/2" size with true pryout slots. Four "NM" (non-metallic) cable pryouts with integral strain relief. Quick-connect wiring connectors included.

Bar Hangers: Pre-installed, captive bar hangers allow housing to be positioned at any point within a 24" joist span. A set screw locks hanger bars in position. Score lines allow field shortening for 12" joists. Integral nail simplifies installation. Bar hangers can be repositioned 90° without tools. Integral T-bar clip snaps onto T-bar spline for quick alignment.

Socket: Porcelain socket with nickel plated brass screw shell. Shipping insert protects socket against overspray.

Thermal Protector: Self resetting thermal protector deactivates fixture if overheating occurs due to improper lamping.

Labels

- UL/cUL Listed for Damp Location
- UL/cUL Listed for Feed Through
- UL/cUL Listed for Direct Contact with Insulation and combustible material

Meets following restricted air-flow and IC requirements:

- State of California Title 24 Low efficacy Luminaire IC and AT requirement
- Washington State Energy Code
- International Energy Conservation Code (IECC)
- New York State Energy Conservation Construction Code (NY-ECCC)
- Certified Under ASTM-E283

EI700NB

6" Aperture

IC Housing for
Insulated
Ceilings

No Socket
Bracket

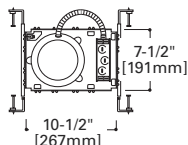
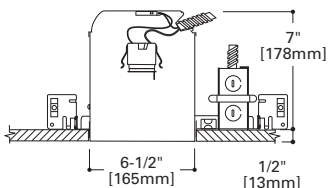

The ALL-PRO EI700ATNB housing is designed for installations where it will be in direct contact with insulation. It is designed without a socket plate for use with socket supporting trims only. There is no need to spend time adjusting or disconnecting the socket and removing the socket plate.

Housing: Aluminum construction for greater heat dissipation.

Plaster Frame: Housing adjusts in plaster frame 1-3/4" to accommodate different ceiling thicknesses.

Junction Box: Listed for through branch circuit wiring. Positioned to accommodate straight conduit runs. Seven conduit knockouts are uniform 1/2" size with true pryout slots. Four "NM" (non-metallic) cable pryouts with integral strain relief. Quick-connect wiring connectors included.

Bar Hangers: Pre-installed, captive bar hangers allow housing to be positioned at any point within a 24" joist span. A set screw locks housing in position. Score lines allow field shortening for 12" joists. Integral nail simplifies installation. Bar hangers can be repositioned 90° without tools. Integral T-bar clip snaps onto T-bar spline for quick alignment.

Socket: Porcelain socket with nickel plated brass screw shell. Shipping insert protects socket against overspray.

Thermal Protector: Self resetting thermal protector deactivates fixture if overheating occurs due to improper lamping.

Labels

- UL/cUL Listed for Damp Location
- UL/cUL Listed for Feed Through
- UL/cUL Listed for Direct Contact with Insulation and combustible material



ALL-PRO

Trims For EI700, EI700R, EI700AT, EI700RAT,
EI700ATNB, EI700NB



ERT710G

High Gloss Appliance White Trim
with Gold Reflector

Specular Reflector

- Coil Spring retention

EI700 EI700AT	75W R30, 65W BR30, 50W PAR30, 75W PAR30L
EI700R EI700RAT	50W PAR30, 75W PAR30L, 65W BR30, 75W R30



ERT710

High Gloss Appliance White Trim
with Clear Specular Reflector

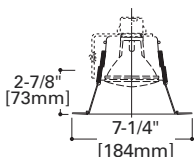

ERT712

High Gloss Appliance White Trim
with White reflector

White Reflector

- Socket supporting trim
- ERT712 - Friction clip retention
- ERT712TS - Torsion spring retention

EI700 EI700AT EI700R EI700RAT EI700NB EI700ATNB	40W A19, 65W BR30, 75W PAR30, 75W PAR30L, 75W R30, 90W BR40
----------------------------------------------------------------	----------------------------------------------------------------------



ERT712TS

High Gloss Appliance White Trim
with White Reflector and Torsion
Spring Construction

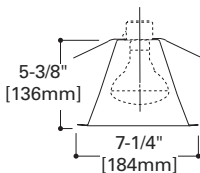

ERT712

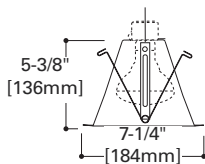

ERT712TS



Trims For EI700, EI700R, EI700AT, EI700RAT, EI700ATNB, EI700NB

Metal Baffle

- Coil spring retention
- Two trim rings (narrow and wide), supplied with trim

EI700	
EI700AT	50W PAR30, 65W BR30,
EI700R	75W R30, 75W PAR30L
EI700RAT	

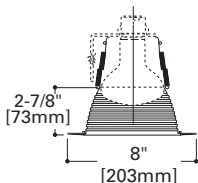

ERT707
High Gloss Appliance White Trim
with Black Baffle



ERT707WHT
High Gloss Appliance White Trim
with White Baffle

Black Metal Baffle

- Socket supporting trim
- ERT713 - Friction clip retention
- ERT713TS - Torsion spring retention

EI700	
EI700AT	40W A19, 65W BR30,
EI700R	75W PAR30, 75W PAR30L,
EI700RAT	90W BR40

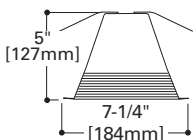

ERT713

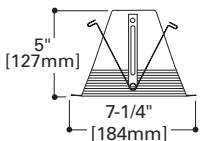

ERT713TS



ERT713TS
High Gloss Appliance White Trim
with Black Baffle and Torsion
Spring Construction



ERT713
High Gloss Appliance White Trim
with Black Baffle



ALL-PRO

Trims For EI700, EI700R, EI700AT, EI700RAT,
EI700ATNB, EI700NB



ERT713WHT

High Gloss Appliance White Trim with White Baffle



ERT713WHTTS

High Gloss Appliance White Trim with White Baffle and Torsion Spring Construction



Metal Baffle

- Socket supporting trim
- ERT713WHT - Friction clip retention
- ERT713WHTTS - Torsion spring retention

EI700	40W A19, 65W BR30, 75W PAR30, 75W PAR30L, 75W R30, 90W BR40
EI700AT	
EI700R	
EI700RAT	
EI700NB	
EI700ATNB	

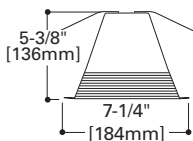

ERT713WHT

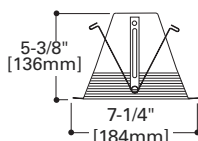

ERT713WHTTS



ERT713LTS

High Gloss Appliance White Trim with Black Baffle and Torsion Spring Construction



ERT713L

High Gloss Appliance White Trim with Black Baffle

Black Metal Baffle

- Provides deeper lamp regression for BR lamps
- ERT713LTS - Torsion spring retention
- ET713L - Friction clip retention

EI700	75W BR40, 65W BR30, 75W PAR30L
EI700AT	
EI700R	
EI700RAT	
EI700NB	
EI700ATNB	

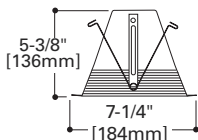

ERT713LTS

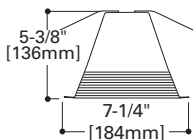

ERT713L

Trims For EI700, EI700R, EI700AT, EI700RAT, EI700ATNB, EI700NB

Plastic Baffle

- Coil spring retention

EI700 EI700AT EI700R EI700RAT	50W PAR30, 65W BR30, 75W PAR30L
----------------------------------------	---------------------------------------

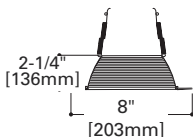

ERT714
High Gloss Appliance White Trim
with Black Baffle



ERT714WHT
High Gloss Appliance White Trim
with White Baffle

Eyeball

- Torsion springs pull trim tight to ceiling

EI700 EI700AT EI700R EI700RAT EI700NB EI700ATNB	75W BR40, 65W BR30, 75W PAR30L
----------------------------------------------------------------	--------------------------------------

Aperture:
3-15/16"
[100mm]
OD:
8" [203mm]

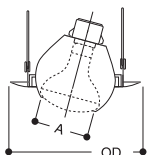

ERT704
High Gloss Appliance White Trim
with White Eyeball



ERT704PB
Polished Brass Trim with
Polished Brass Eyeball

Regressed Eyeball

EI700 EI700AT	50W PAR30
EI700NB EI700ATNB	65W BR30, 75W R30

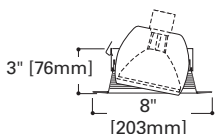

ERT711
High Gloss Appliance White Trim
and Eyeball with Black Baffle

ALL-PRO

Trims For EI700, EI700R, EI700AT, EI700RAT, EI700ATNB, EI700NB



ERT705
High Gloss Appliance White Trim

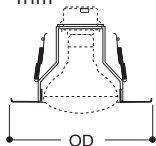

Aperture:
3-7/8" [98mm]
OD:
8" [203mm]

Open

- Coil Spring retention

EI700 EI700AT EI700R EI700RAT EI700NB EI700ATNB	65W BR30, 75W PAR30, 75W PAR30L
----------------------------------------------------------------	---------------------------------------



ERT721
High Gloss Appliance White Trim with Frosted Lens

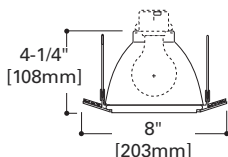

Shower Light with Frosted Glass Lens and Reflector

- Torsion springs pull trim tight to ceiling
- Wet location listed for use in showers

EI700 EI700AT EI700R EI700RAT EI700NB EI700ATNB	40W A19
----------------------------------------------------------------	---------



ERT725
High Gloss Appliance White Trim with Black Baffle



ERT725TS
High Gloss Appliance White Trim with Black Baffle and Torsion Spring Construction

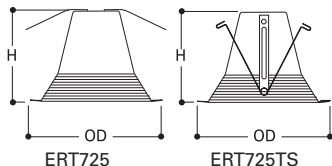

Black Metal Baffle/Splay

- Combination baffle/splay trim
- Socket Supporting trim
- ERT725 - Friction clip retention
- ERT725TS - Torsion spring retention

EI700 EI700AT EI700R EI700RAT EI700NB EI700ATNB	50W PAR30L, 65W BR30
----------------------------------------------------------------	----------------------

Height:
5-3/8" [136mm]
OD:
7-1/4" [184mm]

Trims For EI700, EI700R, EI700AT, EI700RAT, EI700ATNB, EI700NB

White Metal Baffle/Splay

- Combination baffle/splay trim
- Socket Supporting trim
- ERT725WHT - Friction clip retention
- ERT725WHTTS - Torsion spring retention

EI700	40W A19, 50W PAR30L, 65W BR30, 75W PAR30L
EI700AT	
EI700R	
EI700RAT	
EI700NB	
EI700ATNB	



ERT725WHT
High Gloss Appliance White Trim with White Baffle



ERT725WHTTS
High Gloss Appliance White Trim with White Baffle and Torsion Spring Construction

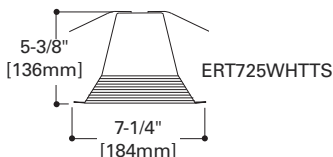
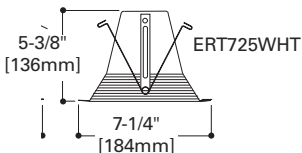

air ¹⁰⁴ *trim*

Shallow Metal Baffle

- Socket Supporting trim
- Friction clip retention

EI700	40W A19, 65W BR30, 75W PAR30L 75W PAR30L
EI700AT	
EI700R	
EI700RAT	
EI700NB	
EI700ATNB	



ERT716
High Gloss Appliance White Trim with White Baffle

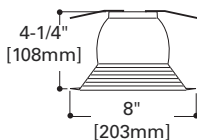

air ¹⁰⁴ *trim*

Shower Light with Glass Fresnel Lens and Reflector

- Torsion springs pull trim tight to ceiling
- Wet location listed for use in showers
- Socket supporting trim

EI700	40W A19
EI700AT	
EI700R	
EI700RAT	
EI700NB	
EI700ATNB	



ERT723
High Gloss Appliance White Trim with Glass Fresnel Lens

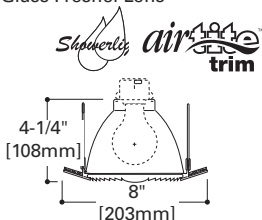

ALL-PRO

ET700

6" Aperture

Non-IC Housing
for Use In
Uninsulated
Ceilings

Any Insulation
Present Must Be
Kept 3" From
Housing

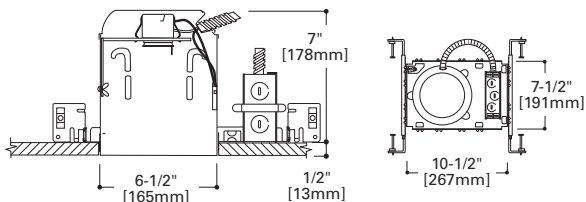

The ALL-PRO ET700 is designed for use in non-insulated ceilings in residential and commercial applications. If ceiling insulation is present, it must be kept 3" from all sides of the fixture.

Housing: Die-stamped 20 gauge CRS with white powder coat finish.

Socket Plate: Rigid socket plate adjusts and locks without tools for various lamp sizes.

Plaster Frame: Housing adjusts in plaster frame to accommodate ceilings up to 1-3/4" thick. Includes locking screw and cutouts for crimping hanger bars in position.

Junction Box: Listed for through branch circuit wiring. Positioned to accommodate straight conduit runs. Seven conduit knockouts are uniform 1/2" size with true pryout slots. Four "NM" (non-metallic) cable pryouts with integral strain relief also included. Quick-connect wiring connectors included.

Bar Hangers: Pre-installed, captive bar hangers allow housing to be positioned at any point within a 24" joist span. A set screw locks bar hangers in position. Score lines allow field shortening for 12" joists. Integral nail simplifies installation. Bar hangers can be repositioned 90° without tools. Integral T-bar spline snaps onto T-bar for quick alignment.

Socket: Porcelain socket with nickel plated brass screw shell. Shipping insert protects socket against overspray

Thermal Protector: Self resetting thermal protector deactivates fixture if overheating occurs due to improper lamping or misapplied insulation.

Labels:

- UL/cUL Listed for Damp Location
- UL/cUL Listed for FeedThrough
- IP Rated



ET700R

6" Aperture

Non-IC Housing
for Use In
Uninsulated
Ceilings

Any Insulation
Present Must
Be Kept 3"
From Housing

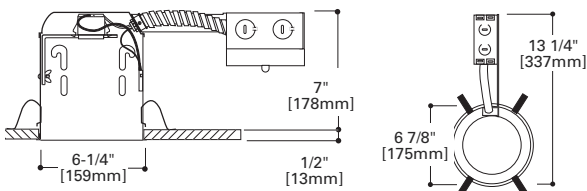

The ALL-PRO ET700R remodel housing is designed for use in non-insulated existing ceilings. If ceiling insulation is present, it must be kept 3" from the fixtures on all sides. The ET700R can be installed from below the ceiling.

Housing: Die-stamped 20 gauge CRS with white powder coat finish.

Socket Plate: Rigid socket plate adjusts and locks without tools for various lamp sizes.

Junction Box: Listed for through branch circuit wiring. Seven conduit knockouts are uniform 1/2" size with true pryout slots. Four "NM" (non-metallic) cable pryouts with integral strain relief included. Quick-connect wiring connectors included.

Remodel Clips; Four remodel clips secure housing and accommodate 1/2" and 5/8" ceiling thickness.

Socket: Porcelain socket with nickel plated brass screw shell. Shipping insert protects socket against overspray.

Thermal Protector: Self resetting thermal protector deactivates fixture if overheating occurs due to improper lamping or misapplied insulation.

Labels:

- UL/cUL Listed for Damp Location
- UL/cUL Listed for Feed Through
- IP Rated



ALL-PRO

Trims For ET700, ET700R

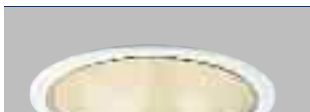

ERT710G

High Gloss Appliance White Trim with Gold Reflector

Specular Reflector

- Coil Spring retention

ET700	65W BR30, 75W R30, 75W PAR30, 150W R40, 150W PAR38
ET700R	65W BR30, 75W R30, 75W PAR30, 75W PAR30L, 150W R40



ERT710

High Gloss Appliance White Trim with Clear Specular Reflector

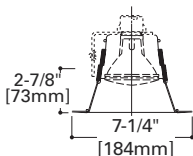

ERT712

High Gloss Appliance White Trim with White reflector

White Reflector

- Socket supporting trim
- ERT712 - Friction clip retention
- ERT712TS - Torsion spring retention

ET700	85W BR30, 120W BR40, 100W R30, 75W PAR30L, 100W A19
ET700R	65W BR30, 75W PAR30L



ERT712TS

High Gloss Appliance White Trim with White reflector and Torsion Spring Construction

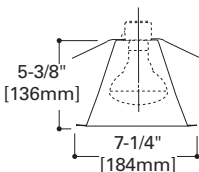

ERT712

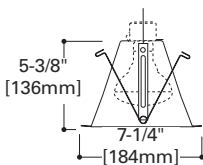

ERT712TS



Trims For ET700, ET700R

Metal Baffle

- Coil spring retention
- Two trim rings (narrow and wide), supplied with trim

ET700	65W BR30, 75W R30, 75W PAR30
ET700R	65W BR30, 75W R30, 75W PAR30, 75W PAR30L, 120W BR40, 150W R40

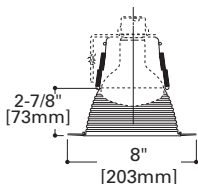

ERT707
High Gloss Appliance White Trim
with Black Baffle



ERT707WHT
High Gloss Appliance White Trim
with White Baffle

Large Aperture Metal Baffle

- Coil spring retention
- Two trim rings (narrow and wide), supplied with trim

ET700	120W R40, 120W PAR38
-------	----------------------

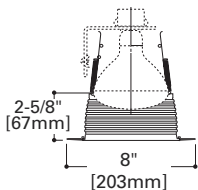

ERT709
High Gloss Appliance White Trim
with Black Baffle



ERT709WHT
High Gloss Appliance White Trim
with White Baffle



ALL-PRO

Trims For ET700, ET700R



ERT713

High Gloss Appliance White Trim with Black Baffle



ERT713TS

High Gloss Appliance White Trim with Black Baffle and Torsion Spring Construction



Black Metal Baffle

- Socket supporting trim
- ERT713 - Friction clip retention
- ERT713TS - Torsion spring retention

ET700	75W PAR30L, 85W BR30, 100W R30, 100W A19, 120W BR40
ET700R	65W BR30, 75W PAR30L

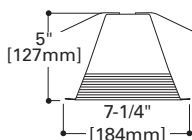

ERT713

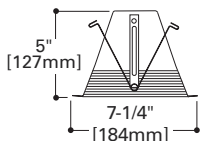

ERT713TS



ERT713WHT

High Gloss Appliance White Trim with White Baffle



ERT713WHTTS

High Gloss Appliance White Trim with White Baffle and Torsion Spring Construction



Metal Baffle

- Socket supporting trim
- ERT713WHT - Friction clip retention
- ERT713WHTTS - Torsion spring retention

ET700	75W PAR30L, 85W BR30, 100W R30, 100W A19, 120W BR40
ET700R	65W BR30, 75W PAR30L

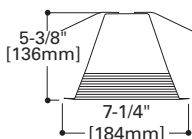

ERT713WHT

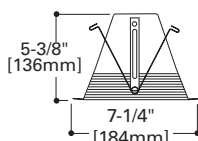

ERT713WHTTS

Trims For ET700, ET700R

Black Metal Baffle

- Provides deeper lamp regression for BR lamps
- ET713L - Friction clip retention
- ERT713LTS - Torsion spring retention

ET700	75W A19, 75W PAR30L, 75W PAR30, 85W BR30, 100W R30, 120W BR40, 150W R40
ET700R	65W BR30, 75W PAR30L, 150W R40



ERT713L
High Gloss Appliance White Trim with Black Baffle



ERT713LTS
High Gloss Appliance White Trim with Black Baffle and Torsion Spring Construction

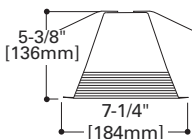

ERT713L

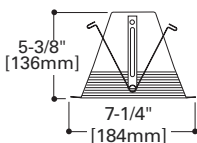

ERT713LTS



Plastic Baffle

- Coil spring retention

ET700	75W R30, 75W PAR30, 75W PAR30L, 85W BR30
ET700R	75W R30, 75W PAR30L, 85W BR30



ERT714
High Gloss Appliance White Trim with Black Baffle



ERT714WHT
High Gloss Appliance White Trim with White Baffle

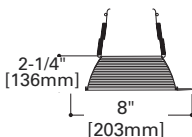

ALL-PRO

Trims For ET700, ET700R



ERT717

High Gloss Appliance White Trim with Black Baffle

Large Aperture Plastic Baffle

- Coil spring retention

ET700	150W PAR30, 150W R40
ET700R	150W R40



ERT717WHT

High Gloss Appliance White Trim with White Baffle

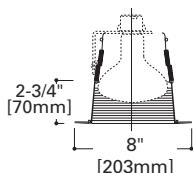

ERT716

High Gloss Appliance White Trim with White Baffle

Shallow Metal Baffle

- Socket Supporting trim
- Friction clip retention

ET700	40W A19, 65W BR30,
ET700R	75W PAR30L, 75W PAR30L

air 101
trim

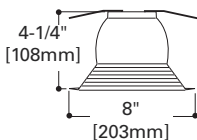

ERT704

High Gloss Appliance White Trim with White Eyeball

Eyeball

- Torsion springs pull trim tight to ceiling

ET700	75W R30, 75W PAR30,
ET700R	75W PAR30L



ERT704PB

Polished Brass Trim with Polished Brass Eyeball

Aperture:
3-15/16"
[100mm]
OD:
8" [203mm]

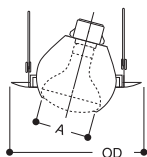

Trims For ET700, ET700R

Regressed Eyeball

ET700	65W BR30, 75W R30, 75W PAR30
-------	---------------------------------

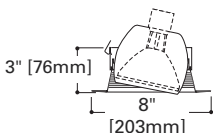

ERT711
High Gloss Appliance White Trim
and Eyeball with Black Baffle

Open

- Coil spring retention

ET700	65W BR30, 75W R30, 75W PAR30
ET700R	65W R30, 75W R30, 75W PAR30, 75W PAR30L



Aperture:
3-7/8" [98mm]
OD:
8" [203mm]

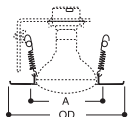

ERT706
High Gloss Appliance White Trim

Large Aperture Open

- Coil Spring Retention

ET700 ET700R	120W BR40, 150W R40
-----------------	---------------------



Aperture:
5-3/16"
[131mm]
OD:
8" [203mm]

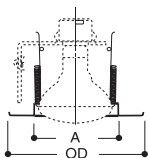

ERT708
High Gloss Appliance White Trim

Albalite Lens Shower Light

- Wet Location listed for use in showers
- Torsion spring retention

ET700 ET700R	40W A19, 65W BR30, 75W PAR30L, 75W PAR30L
-----------------	----------------------------------------------

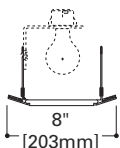

ERT701
High Gloss Appliance White Trim
with Albalite Lens

ALL-PRO

Trims For ET700, ET700R



Drop Opal Plastic Lens Shower Light

- Wet Location listed for use in showers
- Torsion spring retention

ERT702

High Gloss Appliance White Trim with Drop Opal Lens

ET700	60W A19
ET700R	

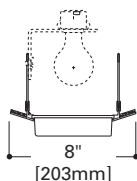

Fresnel Lens Shower Light

- Wet Location listed for use in showers

ERT703

High Gloss Appliance White Trim with Fresnel lens

ET700	60W A19
ET700R	

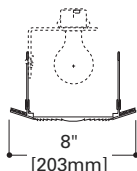

Open

- Coil Spring retention
- Fixed socket position

ERT705

White Trim

ET700	65W BR30, 75W R30,
ET700R	75W PAR30, 75W PAR30L

Aperture:
3-7/8"
[98mm]
OD:
8" [203mm]

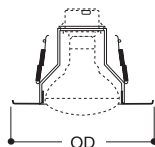

Trims For ET400, ET400R, EI400AT

Shower Light with Frosted Glass Lens and Reflector

- Torsion springs pull trim tight to ceiling
- Wet location listed for use in showers



ERT721
High Gloss Appliance White Trim with Frosted Lens

ET700 ET700R	60W A19
-----------------	---------

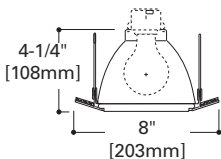

Shower Light with Glass Fresnel Lens and Reflector

- Torsion springs pull trim tight to ceiling
- Wet location listed for use in showers
- Socket supporting trim



ERT723
High Gloss Appliance White Trim with Glass Fresnel Lens

ET700 ET700R	60W A19
-----------------	---------

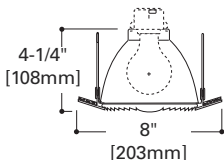

ALL-PRO

Trims For ET700, ET700R



ERT725
High Gloss Appliance White
Trim with Black Baffle



ERT725TS
High Gloss Appliance White
Trim with Black Baffle and
Torsion Spring Construction



Black Metal Baffle/Splay

- Combination baffle/splay trim
- Socket Supporting trim
- ERT725 - Friction clip retention
- ERT725TS - Torsion spring retention

ET700	50W PAR30L, 85W BR30,
ET700R	90W A19, 100W R30

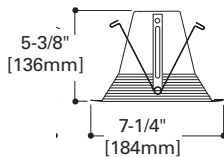

ERT725

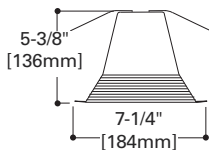

ERT725TS



Trims For ET700, ET700R

White Metal Baffle/Splay

- Combination baffle/splay trim
- Socket Supporting trim
- ET725WHT - Friction clip retention
- ERT725WHTTS - Torsion spring retention

ET700	50W PAR30L, 85W BR30,
ET700R	90W A19, 100W R30

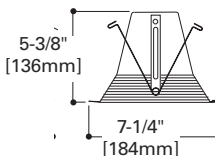

ERT725WHT

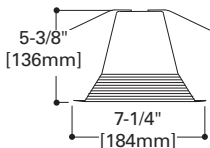

ERT725WHTTS

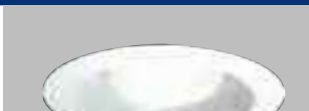

ERT725WHT

High Gloss Appliance White Trim with White Baffle



ERT725WHTTS

High Gloss Appliance White Trim with White Baffle and Torsion Spring Construction

air ¹⁸⁴ *trim*



ALL-PRO

EI700U

6" Aperture

IC Housing for
Insulated
Ceilings

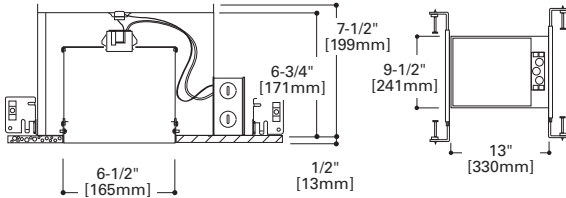

The ALL-PRO EI700U housing is designed to be used in direct contact with insulation. The All-Pro EI700U housing is suited for use in insulated ceilings in residential and commercial applications. The IC construction allows an unbroken insulation barrier to be maintained.

Housing: Double wall aluminum construction for greater heat dissipation. Double wall housing allows higher wattages on select trims than single wall IC housing.

Socket Plate: Fixed socket plate maintains consistent lamp position.

Plaster Frame: Housing adjusts in plaster frame 1" to accommodate different ceiling thicknesses.

Junction Box: Listed for through branch circuit wiring. Accommodates straight conduit runs. Seven conduit knockouts are uniform 1/2" size with true pryout slots. Four "NM" (non-metallic) cable pryouts with integral strain relief also included. Quick-connect wiring connectors included.

Bar Hangers: Pre-installed, captive bar hangers allow housing to be positioned at any point within a 24" joist span. A set screw locks housing in position. Score lines allow shortening for 12" joists. Integral nail simplifies installation. Bar hangers can be repositioned 90° without tools. Integral T-bar spline snaps onto T-bar for quick alignment.

Socket: Porcelain socket with nickel plated brass screw shell. Shipping insert protects socket against overspray.

Thermal Protector: Self resetting thermal protector deactivates fixture if overheating occurs due to improper lamping.

Labels:

- UL/cUL Listed for Damp Location
- UL/cUL Listed for Feed Through
- UL/cUL Listed for Direct Contact with Insulation and combustible material



EI700UAT

air-tite™

6" Aperture

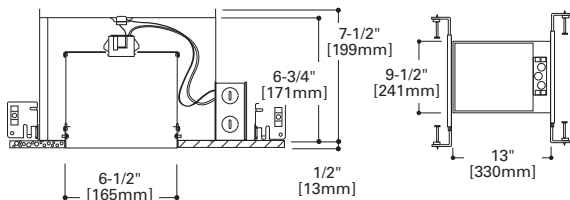
IC AIR-TITE
Housing for
Insulated
Ceilings

The ALL-PRO EI700UAT housing is designed for use in direct contact with insulation. The IC construction allows an unbroken insulation barrier to be maintained and the AIR-TITE construction meets restricted airflow requirements.

Housing: Double wall aluminum construction for greater heat dissipation. Double wall housing allows higher wattages on select trims than single wall housing. Air-Tite gasket pre-installed for ASTM-E283 compliance.

Socket Plate: Fixed socket plate maintains consistent lamp position.

Plaster Frame: Housing adjusts in plaster frame 1" to accommodate different ceiling thicknesses.

Junction Box: Listed for through branch circuit wiring. Accommodates straight conduit runs. Seven conduit knockouts are 1/2" with true pryout slots. Four "NM" (non-metallic) cable pryouts with integral strain relief. Quick-connect wiring connectors.

Bar Hangers: Pre-installed, captive bar hangers allow housing to be positioned at any point within a 24" joist span. A set screw locks housing in position. Score lines allow shortening for 12" joists. Integral nail simplifies installation. Bar hangers can be repositioned 90° without tools. Integral T-bar spline snaps onto T-bar for quick alignment.

Socket: Porcelain socket with nickel plated brass screw shell. Shipping insert protects socket against overspray.

Thermal Protector: Self resetting thermal protector deactivates fixture if overheating occurs due to improper lamping.

Labels:

- UL/cUL Listed for Damp Location
- UL/cUL Listed for Feed Through
- UL/cUL Listed for Direct Contact with Insulation and combustible material

Meets following restricted air-flow and IC requirements:

- State of California Title 24 Low Efficacy Luminaire IC and AT requirement
- Washington State Energy Code
- International Energy Conservation Code (IECC)
- New York State Energy Conservation Construction Code (NY-ECCC)
- Certified Under ASTM-E283

ALL-PRO

Trims For EI700U, EI700UAT



ERT710G

High Gloss Appliance White Trim with Gold Reflector

Specular Reflector

- Coil Spring retention

EI700U EI700UAT	75W PAR30, 75W PAR30L, 85W BR30, 90W BR40, 100W R30, 100W R40, 100W PAR38
--------------------	------------------------------------------------------------------------------------



ERT710

High Gloss Appliance White Trim with Clear Specular Reflector

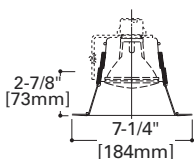

ERT712

High Gloss Appliance White Trim with White reflector

White Reflector

- Socket supporting trim
- ERT712 - Friction clip retention
- ERT712TS - Torsion spring retention

EI700U EI700UAT	60W A19, 75W PAR30, 75W PAR30L, 85W BR30, 100W R30, 120W BR40
--------------------	------------------------------------------------------------------------



ERT712TS

High Gloss Appliance White Trim with White reflector and Torsion Spring Construction

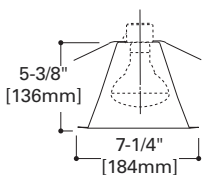

ERT712

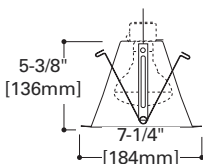

ERT712TS



Trims For EI700U, EI700UAT

Metal Baffle

- Coil spring retention
- Two trim rings (narrow and wide), supplied with trim

EI700U EI700UAT	65W BR30, 75W R30, 75W PAR30, 75W PAR30L, 90W PAR38, 90W BR40, 100W R40
--------------------	----------------------------------------------------------------------------------

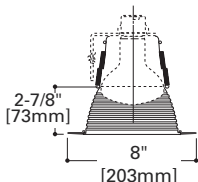

ERT707
High Gloss Appliance White
Trim with Black Baffle



ERT707WHT
High Gloss Appliance White
Trim with White Baffle

Large Aperture Metal Baffle

- Coil spring retention
- Two trim rings (narrow and wide), supplied with trim

EI700U EI700UAT	90W BR40
--------------------	----------

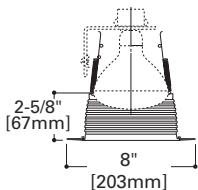

ERT709
High Gloss Appliance White
Trim with Black Baffle



ERT709WHT
High Gloss Appliance White
Trim with White Baffle



ALL-PRO

Trims For EI700U, EI700UAT



ERT713

High Gloss Appliance White Trim with Black Baffle

Black Metal Baffle

- Socket supporting trim
- ERT713 - Friction clip retention
- ERT713TS - Torsion spring retention

EI700U EI700UAT	60W A19, 75W PAR30, 75W PAR30L, 85W BR30, 120W BR40
--------------------	-----------------------------------------------------------



ERT713TS

High Gloss Appliance White Trim with Black Baffle and Torsion Spring Construction

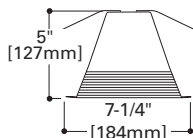

ERT713

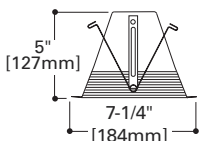

ERT713TS



ERT713WHT

High Gloss Appliance White Trim with White Baffle

Metal Baffle

- Socket supporting trim
- ERT713WHT - Friction clip retention
- ERT713WHTTS - Torsion spring retention

EI700U EI700UAT	60W A19, 75W PAR30, 75W PAR30L, 85W BR30, 100W R30, 120W BR40
--------------------	---------------------------------------------------------------------



ERT713WHTTS

High Gloss Appliance White Trim with White Baffle and Torsion Spring Construction

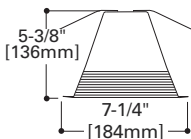

ERT713WHT

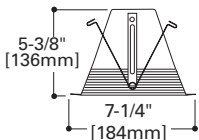

ERT713WHTTS



Trims For EI700U, EI700UAT

Black Metal Baffle

- Provides deeper lamp regression for BR lamps
- ET713L - Friction clip retention
- ERT713LTS - Torsion spring retention

EI700U EI700UAT	40W A19, 75W PAR30, 75W PAR30L, 85W BR30, 120W BR40
--------------------	-----------------------------------------------------------

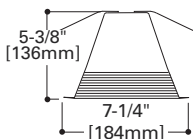

ERT713L

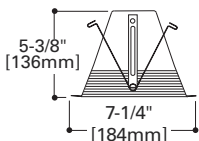

ERT713LTS



ERT713L
High Gloss Appliance White Trim
with Black Baffle



ERT713LTS
High Gloss Appliance White Trim
with Black Baffle and Torsion
Spring Construction



Plastic Baffle

- Coil spring retention

EI700U EI700UAT	65W BR30, 75W PAR30, 75W PAR30L
--------------------	------------------------------------

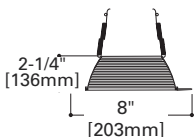

ERT714
High Gloss Appliance White Trim
with Black Baffle



ERT714WHT
High Gloss Appliance White Trim
with White Baffle



ALL-PRO

Trims For EI700U, EI700UAT



ERT704

High Gloss Appliance White Trim with White Eyeball

Eyeball

- Torsion springs pull trim tight to ceiling

EI700U EI700UAT	75W PAR30, 75W PAR30L, 85W BR30, 100W R30
--------------------	-------------------------------------------------



ERT704PB

Polished Brass Trim with Polished Brass Eyeball

Aperture:
3-15/16"
[100mm]
OD:
8" [203mm]

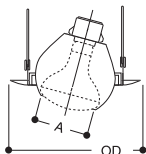

ERT708

High Gloss Appliance White Trim

Large Aperture Open

- Coil Spring Retention

EI700U EI700UAT	100W R40 (Requires H1999 Socket Extender)
--------------------	----------------------------------------------

Aperture:
5-3/16"
[131mm]
OD:
8" [203mm]

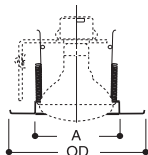

ERT701

High Gloss Appliance White Trim with Albalite Lens

Albalite Lens Shower Light

- Wet Location listed for use in showers
- Torsion spring retention

EI700U EI700UAT	40W A19
--------------------	---------

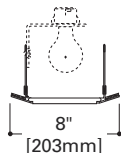

Trims For EI700U, EI700UAT

Drop Opal Plastic Lens Shower Light

- Wet Location listed for use in showers
- Torsion spring retention



EI700U EI700UAT	40W A19
--------------------	---------

ERT702
High Gloss Appliance White Trim with Drop Opal Lens

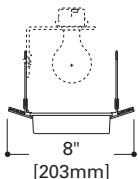

Fresnel Lens Shower Light

- Wet Location listed for use in showers



EI700U EI700UAT	40W A19
--------------------	---------

ERT703
High Gloss Appliance White Trim with Fresnel lens

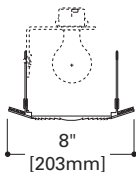

Open

- Coil Spring retention
- Fixed socket position



EI700U EI700UAT	75W PAR30, 75W PAR30L, 85W BR30, 100W R30
--------------------	-------------------------------------------

ERT705
White Trim

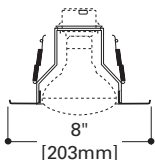

ALL-PRO

Trims For EI700U, EI700UAT



ERT721

High Gloss Appliance White Trim with Frosted Lens



Shower Light with Frosted Glass Lens and Reflector

- Torsion springs pull trim tight to ceiling
- Wet location listed for use in showers

EI700U EI700UAT	60W A19
--------------------	---------

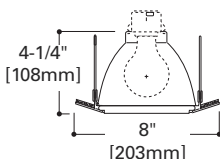

ERT723

High Gloss Appliance White Trim with Glass Fresnel Lens



Shower Light with Glass Fresnel Lens and Reflector

- Torsion springs pull trim tight to ceiling
- Wet location listed for use in showers
- Socket supporting trim

EI700U EI700UAT	60W A19
--------------------	---------

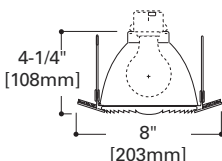

Trims For EI700U, EI700UAT

Black Metal Baffle/Splay

- Combination baffle/splay trim
- Socket Supporting trim
- ERT725 - Friction clip retention
- ERT725TS - Torsion spring retention

EI700U	40W A19, 75W PAR30L,
EI700UAT	85W BR30, 100W R30

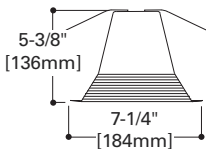

ERT725

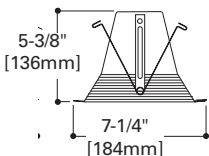

ERT725TS



ERT725

High Gloss Appliance White Trim with Black Baffle



ERT725TS

High Gloss Appliance White Trim with Black Baffle and Torsion Spring Construction

*air*¹⁸⁴
trim

White Metal Baffle/Splay

- Combination baffle/splay trim
- Socket Supporting trim
- ET725WHT - Friction clip retention
- ERT725WHTTS - Torsion spring retention

EI700U	60W A19, 75W PAR30L,
EI700UAT	85W BR30, 100W R30

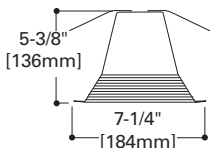

ERT725WHT

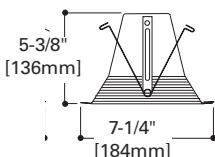

ERT725WHTTS



ERT725WHT

High Gloss Appliance White Trim with White Baffle



ERT725WHTTS

High Gloss Appliance White Trim with White Baffle and Torsion Spring Construction

*air*¹⁸⁴
trim

ALL-PRO

EI2700

6" Aperture

IC Housing for
Insulated
Ceilings

For Shallow
Ceilings

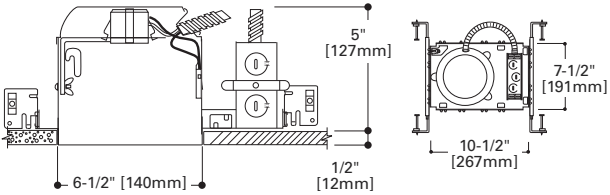

The ALL-PRO EI2700 housing is designed for use in shallow ceilings where 2"x6" joist construction is used. It is also designed for shallow ceilings where insulation is present and where the housing will be in direct contact with insulation.

Housing: Aluminum housing for greater heat dissipation.

Socket Plate: Rigid socket plate adjusts and locks without tools for various lamp sizes.

Plaster Frame: Housing adjusts in plaster frame 1-3/8" to accommodate different ceiling thicknesses.

Junction Box: Listed for through branch circuit wiring. Positioned to accommodate straight conduit runs. Seven conduit knockouts are uniform 1/2" size with true pryout slots. Four "NM" (non-metallic) cable pryouts with integral strain relief also included. Quick-connect wiring connectors included.

Bar Hangers: Pre-installed, captive bar hangers allow housing to be positioned at any point within a 24" joist span. A set screw locks bar hangers in position. Score lines allow shortening for 12" joists. Integral nail simplifies installation. Bar hangers can be repositioned 90° without tools. Integral T-bar clip snaps onto T-bar spline for quick alignment.

Socket; Porcelain socket with nickel plated brass screw shell. Shipping insert protects socket against overspray.

Thermal Protector: Integral Thermal Protector deactivates fixture if an incorrect lamp is used.

Labels:

- UL/cUL Listed for Damp Location
- UL/cUL Listed for Feed Through
- UL/cUL Listed for Direct Contact with Insulation and combustible material



EI2700R

6" Aperture

IC Housing for
Insulated
Ceilings

For Shallow
Ceilings

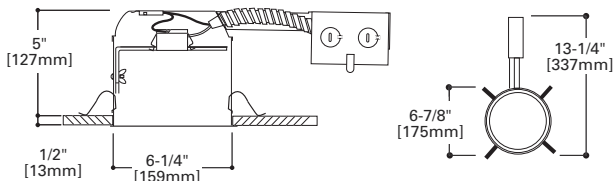

The ALL-PRO EI2700R housing is designed for remodeling use in shallow ceilings where 2" x 6" joist construction is used. It is also designed for use where insulation is present and where the housing will be in direct contact with insulation. The EI2700R can be installed from below the ceiling.

Housing: Aluminum housing for greater heat dissipation.

Socket Plate: Rigid socket plate adjusts and locks without tools for various lamp sizes.

Junction Box: Listed for through branch circuit wiring. Seven conduit knockouts are uniform 1/2" size with true pryout slots. Four "NM" (non-metallic) cable pryouts with integral strain relief are included. Quick-connect wiring connectors included.

Socket: Porcelain socket with nickel plated brass screw shell. Shipping insert protects socket against overspray.

Thermal Protector: Integral Thermal Protector deactivates fixture if an incorrect lamp is used.

Remodel Clips: Four remodel clips secure housing and accommodate 1/2" and 5/8" ceiling thickness.

Labels:

- UL/cUL listed for direct contact with insulation and combustible material
- UL/cUL Listed for Feed Through
- UL/cUL Listed for Damp Location



ALL-PRO

EI2700AT



6" Aperture

IC AIR-TITE
Housing for
Insulated
Ceilings

For Shallow
Ceilings

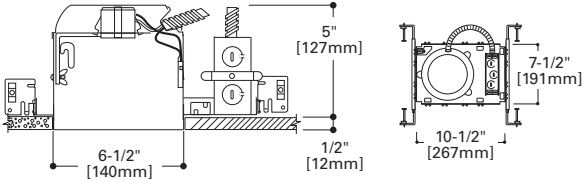

The ALL-PRO EI2700AT housing is designed for use in shallow ceilings where 2" x 6" joist construction is used. It is also designed for use where insulation is present and where the housing will be in direct contact with insulation. The EI2700AT housing has AIR-TITE construction and meets restricted airflow requirements.

Housing: Aluminum housing for greater heat dissipation. Air-Tite gasket supplied with housing to complete ATM-E283 installation.

Socket Plate: Rigid socket plate adjusts and locks without tools for various lamp sizes.

Plaster Frame: Housing adjusts in plaster frame 1" to accommodate different ceiling thicknesses.

Junction Box: Listed for through branch circuit wiring. Positioned to accommodate straight conduit runs. Seven conduit knockouts are uniform 1/2" size with true pryout slots. Four "NM" (non-metallic) cable pryouts with integral strain relief also included. Quick-connect wiring connectors included.

Bar Hangers: Pre-installed, captive bar hangers allow housing to be positioned at any point within a 24" joist span. A set screw locks bar hangers in position. Score lines allow field shortening for 12" joists. Integral nail simplifies installation. Bar hangers can be repositioned 90° without tools. Integral T-Bar hangers fit onto T-Bar spline for quick alignment.

Socket: Porcelain socket with nickel plated brass screw shell. Shipping insert protects socket against overspray.

Thermal Protector: Integral Thermal Protector deactivates fixture if an incorrect lamp is used.



-
- Labels:**
- UL/cUL Listed for Damp Location
 - UL/cUL Listed for Feed Through
 - UL/cUL Listed for Direct Contact with Insulation and combustible material

Meets following restricted air-flow and IC requirements:

- Washington State Energy Code
- State of California Title 24 Low Efficacy Luminaire IC and AT requirement
- International Energy Conservation Code (IECC)
- New York State Energy Conservation Construction Code (NY-ECCC)
- Certified Under ASTM-E283



ALL-PRO

Trims For EI2700, EI2700R, EI2700AT



ERT710G

High Gloss Appliance White Trim with Gold Reflector

Specular Reflector

- Coil Spring retention

EI2700 EI2700AT EI2700R	50W PAR30, 65W BR30, 75W R30, 75W PAR30L
-------------------------------	---------------------------------------------



ERT710

High Gloss Appliance White Trim with Clear Specular Reflector

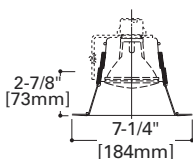

ERT707

High Gloss Appliance White Trim with Black Baffle

Metal Baffle

- Coil spring retention
- Two trim rings (narrow and wide), supplied with trim

EI2700 EI2700AT	50W PAR30, 65W BR30, 75W PAR30L
EI2700R	65W BR30, 75W PAR30L



ERT707WHT

High Gloss Appliance White Trim with White Baffle

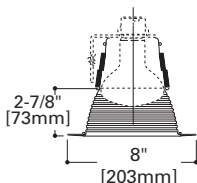

Trims For EI2700, EI2700R, EI2700AT

Plastic Baffle

- Coil spring retention

EI2700 EI2700AT	65W BR30, 50W PAR30, 75W PAR30L
EI2700R	50W PAR30, 60W BR30



ERT714
High Gloss Appliance White Trim
with Black Baffle

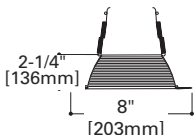

ERT714WHT
High Gloss Appliance White Trim
with White Baffle

Shallow Metal Baffle

- Socket Supporting trim
- Friction clip retention

EI2700 EI2700AT EI2700R	65W BR30, 75W PAR30, 75W PAR30L
-------------------------------	------------------------------------



ERT716
High Gloss Appliance White Trim
with White Baffle

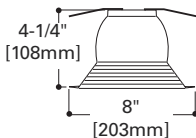

ALL-PRO

Trims For EI2700, EI2700R, EI2700AT



ERT704

High Gloss Appliance White Trim with White Eyeball

Eyeball

- Torsion springs pull trim tight to ceiling

EI2700 EI2700AT	65W BR30, 75W R30, 75W PAR30L
EI2700R	65W BR30, 75W R30, 75W PAR30L



ERT704PB

Polished Brass Trim with Polished Brass Eyeball

Aperture:
3-15/16"
[100mm]
OD:
8" [203mm]

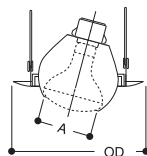

ERT705

White Trim

Open

- Coil Spring retention
- Fixed socket position

EI2700 EI2700AT	50W PAR30L, 60W BR30, 75W PAR30
EI2700R	60W BR30

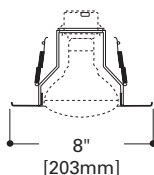

Trims For EI2700, EI2700R, EI2700AT

Shower Light with Frosted Glass Lens and Reflector

- Torsion springs pull trim tight to ceiling
- Wet location listed for use in showers



ERT721
High Gloss Appliance White Trim with Frosted Lens

EI2700 EI2700AT	35W PAR30L
EI2700R	40W A19

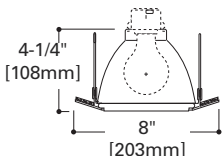

Shower Light with Glass Fresnel Lens and Reflector

- Torsion springs pull trim tight to ceiling
- Wet location listed for use in showers
- Socket supporting trim



ERT723
High Gloss Appliance White Trim with Glass Fresnel Lens

EI2700 EI2700AT	35W PAR30L
EI2700R	40W A19

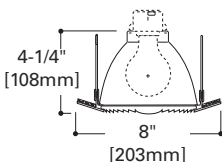

ALL-PRO

ET2700

6" Aperture

Non-IC For Non-insulated Ceilings

For Shallow Ceilings

Insulation Must Be Kept 3" From Housing

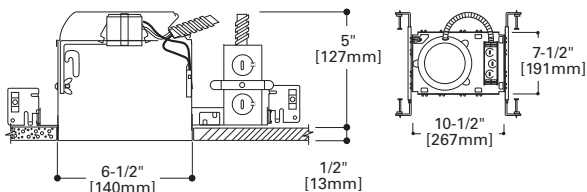

The ALL-PRO ET2700 housing is designed for use in shallow ceilings where 2" x 6" joist construction is used. The ET2700 is designed for non-insulated shallow ceilings. If ceiling insulation is present, it must be kept 3" from the fixtures on all sides.

Housing: Die-stamped 20 gauge CRS with white powder coat finish.

Socket Plate: Rigid socket plate adjusts and locks without tools for various lamp sizes.

Plaster Frame: Housing adjusts in plaster frame 1-3/8" to accommodate different ceiling thicknesses. Includes locking screws for hanger bars and cutouts for crimping hanger bars in position.

Junction Box: Listed for through branch circuit wiring. Positioned to accommodate straight conduit runs. Seven conduit knockouts are uniform 1/2" size with true pryout slots. Four "NM" (non-metallic) cable pryouts with integral strain relief. Quick-connect wiring connectors included.

Bar Hangers: Pre-installed, captive bar hangers allow housing to be positioned at any point within a 24" joist span. A set screw locks bar hangers in position. Score lines allow shortening for 12" joists. Integral nail simplifies installation. Bar hangers can be repositioned 90° without tools. Integral T-bar clip snaps onto T-bar spline for quick alignment.

Socket: Porcelain socket with nickel plated brass screw shell, snaps into trim for consistent lamp positioning. Shipping insert protects socket from overspray.

Thermal Protector: Integral Thermal Protector deactivates fixture if an incorrect lamp is used or if ceiling insulation material is not applied correctly.

Labels:

- UL/cUL Damp Location Listed
- UL/cUL Listed for Feed Through



ET2700R

6" Aperture

Non-IC Remodel
Housing for Non-
insulated
Ceilings

For Shallow
Ceilings

Insulation Must
Be Kept 3" From
Housing

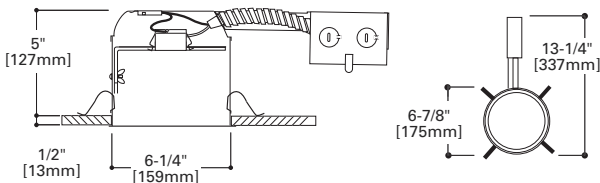

The ALL-PRO ET2700R housing is designed for remodeling use in shallow ceilings where 2" x 6" joist construction is used. The ET2700R is designed for use in ceiling where there is no insulation. If ceiling insulation is present, it must be kept 3" from the fixtures on all sides.

Housing: Die-stamped 20 gauge CRS with white powder coat finish.

Socket Plate: Rigid socket plate adjusts and locks without tools for various lamp sizes.

Junction Box: Listed for through branch circuit wiring. Seven conduit knockouts are uniform 1/2" size with true pryout slots. Four "NM" (non-metallic) cable pryouts with integral strain relief are included. Quick-connect wiring connectors included.

Socket: Porcelain socket with nickel plated brass screw shell. Shipping insert protects socket from overspray.

Thermal Protector: Integral Thermal Protector deactivates fixture if an incorrect lamp is used or if ceiling insulation material is not applied correctly.

Remodel Clips: Four remodel clips secure housing and accommodate ceiling thicknesses from 1/2" to 5/8".

Labels: • UL/cUL listed for Damp Location
• UL/cUL listed for Feed Through



ALL-PRO

Trims For ET2700, ET2700R



ERT710G
High Gloss Appliance White Trim
with Gold Reflector



ERT710
High Gloss Appliance White Trim
with Clear Specular Reflector

Specular Reflector

- Coil Spring retention

ET2700	75W PAR30, 75W PAR30L, 85W BR30, 100W R30
ET2700R	65W BR30, 75W R30, 75W PAR30, 75W PAR30L, 85W BR30

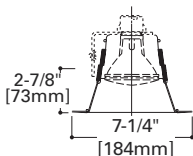

ERT707
High Gloss Appliance White
Trim with Black Baffle



ERT707WHT
High Gloss Appliance White Trim
with White Baffle

Metal Baffle

- Coil spring retention
- Two trim rings (narrow and wide), supplied with trim

ET2700	65W BR30, 75W R30,
ET2700R	75W PAR30, 75W PAR30L

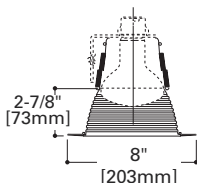

Trims For ET2700, ET2700R

Plastic Baffle

- Coil spring retention

ET2700	75W R30, 75W PAR30, 85W BR30
ET2700R	75W PAR30, 75W PAR30L, 85W BR30

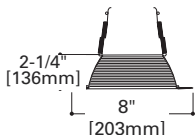

ERT714
High Gloss Appliance White Trim with Black Baffle



ERT714WHT
High Gloss Appliance White Trim with White Baffle

Shallow Metal Baffle

- Socket Supporting trim
- Friction clip retention

ET2700	40W A19, 65W BR30, 75W
ET2700R	PAR30, 75W PAR30L

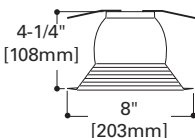

ERT716
High Gloss Appliance White Trim with White Baffle



Eyeball

- Torsion springs pull trim tight to ceiling

ET2700	65W BR30, 75W R30,
ET2700R	75W PAR30, 75W PAR30L

Aperture:
3-15/16"
[100mm]
OD:
8" [203mm]

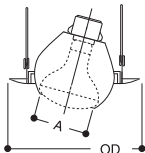

ERT704
High Gloss Appliance White Trim with White Eyeball



ERT704PB
Polished Brass Trim with Polished Brass Eyeball

ALL-PRO

Trims For ET2700, ET2700R



ERT706

High Gloss Appliance White Trim

Open

- Coil spring retention

ET2700 ET2700R	65W BR30, 75W R30, 75W PAR30, 75W PAR30L
-------------------	------------------------------------------------

Aperture:
3-7/8"
[98mm]
OD:
8" [203mm]

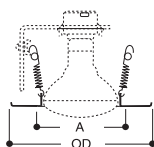

ERT708

High Gloss Appliance White Trim

Large Aperture Open

- Coil spring retention

ET2700	120W BR40, 150W R40
--------	---------------------

Aperture:
3-7/8"
[98mm]
OD:
8" [203mm]

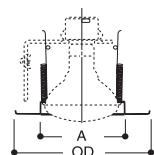

ERT701

High Gloss Appliance White Trim
with Albalite Lens

Albalite Lens Shower Light

- Wet Location listed for use in
showers

ET2700	60W A19
--------	---------

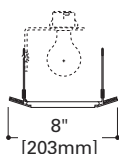

ERT702

High Gloss Appliance White Trim
with Drop Opal Lens

Drop Opal Plastic Lens Shower Light

- Wet Location listed for use
in showers
- Torsion spring retention

ET2700	60W A19
--------	---------

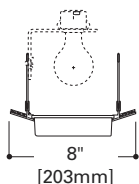

Trims For ET2700, ET2700R

Fresnel Lens Shower Light

- Wet Location listed for use in showers
- Torsion spring retention

ET2700	60W A19
--------	---------

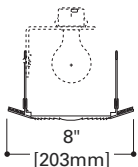

ERT703
High Gloss Appliance White Trim with Glass Fresnel lens

Shower Light with Frosted Glass Lens and Reflector

- Torsion springs pull trim tight to ceiling
- Wet location listed for use in showers

ET2700R	60W A19
---------	---------

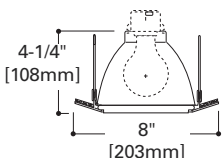

ERT721
High Gloss Appliance White Trim with Frosted Lens



Shower Light with Glass Fresnel Lens and Reflector

- Torsion springs pull trim tight to ceiling
- Wet location listed for use in showers
- Socket supporting trim

ET2700R	60W A19
---------	---------

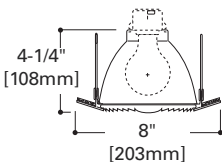

ERT723
High Gloss Appliance White Trim with Glass Fresnel Lens



ALL-PRO

ET4700

6" Aperture

Non-IC for
Non-insulated
Ceilings

Insulation Must
Be Kept 3"
from
Housings

For Slope Ceilings

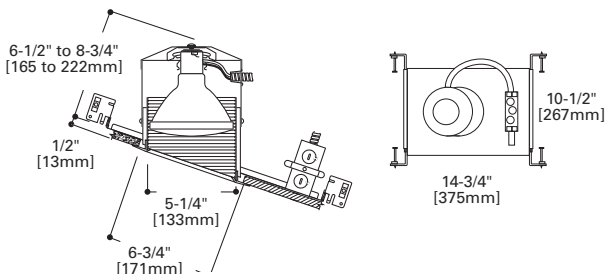

The ALL-PRO ET4700 housing is designed for sloped ceiling installations in ceilings ranging from 2/12 to 6/12 pitch. The socket aiming mechanism allows the lamp to be aimed straight down regardless of ceiling pitch. It is also designed for use in non-insulated ceilings. If insulation is present it must be kept 3" from all sides of the housing.

Housing Features: Thermal protector guards against misuse of insulation materials. Telescoping housing for ceiling construction down to 2"x 8". With deeper ceilings the telescoping feature provides deeper lamp position. Exclusive socket aiming mechanism swivels and rotates to properly align lamp. Slope indicator provides quick and consistent lamp settings (factory set for 3/12 slope).

Junction Box: Listed for through branch circuit wiring. Positioned to accommodate straight conduit runs. Seven conduit knockouts are uniform 1/2" size with true pryout slots. Four "NM" (non-metallic) cable pryouts with integral strain relief also included. Quick-connect wiring connectors included.

Bar Hangers: Pre-installed, captive bar hangers allow housing to be positioned at any point within a 24" joist span. A set screw locks bar hangers in position. Score lines allow field shortening for 12" joists. Integral nail simplifies installation. Bar hangers can be repositioned 90° without tools. Integral T-bar clip clips onto T-bar spline for quick alignment.

Socket: Porcelain socket with nickel plated brass screw shell, snaps into trim for consistent lamp positioning. Shipping insert protects socket from overspray.

Trim: One piece seamless baffle presents a clean finished appearance.

Listings:

- UL/cUL Damp Location Listed
- UL/cUL Listed for FeedThrough

Trims For ET4700

Baffle

- One piece seamless baffle
- Baffle ridges are parallel to floor plane

ET4700	90W PAR38
--------	-----------

Aperture:
5-1/4"
[133mm]
OD:
8" [203mm]

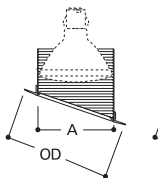

ERT4980
High Gloss Appliance White
Trim with Black Baffle



ERT4980WHT
High Gloss Appliance White Trim
with White Baffle



ALL-PRO

EI4700 EI4700AT

air-tite

6" Aperture
IC Insulated Ceiling
EI4700AT is
IC AIR-TITE
For Slope Ceilings

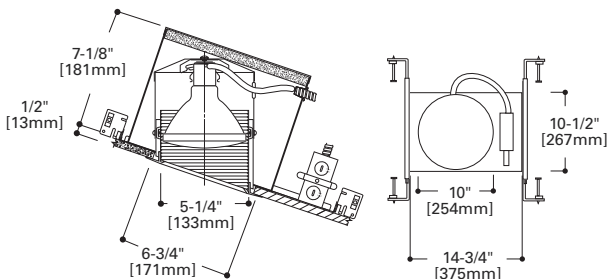

Designed for sloped ceiling installations for ceilings from 2/12 to 6/12 pitch. The socket aiming mechanism allows the lamp to be aimed straight down regardless of ceiling pitch. EI4700AT is sealed and gasketed to limit airflow between attic areas and heated or air conditioned living areas.

Housing Features: Integral thermal protector guards against improper lamping. Housing has AIR-Tite gasket pre-installed for ASTM-E283 compliance. Double wall housing construction. Door in outer housing allows junction box access from below ceiling. Exclusive socket aiming mechanism swivels and rotates to properly align lamp. Slope indicator provides quick and consistent lamp settings (factory set for 3/12 slope).

Junction Box: Listed for through branch circuit wiring. Positioned to accommodate straight conduit runs. Seven conduit knockouts are uniform 1/2" size with true pryout slots. Four "NM" (non-metallic) cable pryouts with integral strain relief. Quick-connect wiring connectors included.

Bar Hangers: Pre-installed, captive bar hangers allow housing to be positioned at any point within a 24" joist span. A set screw is provided to lock bar hangers in position along bar hangers. Score lines provided for easy shortening for 12" joists. Integral nail simplifies installation. Bar hangers can be repositioned 90° without tools. Integral T-bar clip snaps onto T-bar spline for quick alignment.

Trim: One piece seamless baffle presents a clean finished appearance.

Listings:

- UL/cUL Listed for Damp Location
- UL/cUL Listed for FeedThrough
- UL/cUL Listed for Direct Contact with Insulation and combustible material

EI4700AT also meets the following requirements:

- Washington State Energy Code
- State of California Title 24 Low Efficacy Luminaire IC and AT requirement
- International Energy Conservation Code (IECC)
- New York State Energy Conservation Construction Code (NY-ECCC)
- Certified Under ASTM-E283

Trims For ET4700

Baffle

- One piece seamless baffle
- Baffle ridges are parallel to floor plane

EI4700 EI4700AT	90W PAR38
--------------------	-----------

Aperture:
5-1/4"
[133mm]
OD:
8" [203mm]

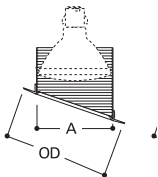

ERT4980
High Gloss Appliance White Trim
with Black Baffle



ERT4980WHT
High Gloss Appliance White Trim
with White Baffle



ALL-PRO

Numerical Index

EI400AT	.10	ERT703	.61
EI400LVAT	.16	ERT703	.77
EI500AT	.22	ERT704	.39, 48
EI500RAT	.23	ERT704PB	.39, 48
EI700	.30	ERT704	.60, 70, 75
EI700R	.31	ERT704PB	.70, 75
EI700RAT	.33	ERT705	.40, 50, 61, 70
EI700AT	.32	ERT706	.49, 76
EI700ATNB	.34	ERT706	.76
EI700NB	.35	ERT707WHT	.37, 45, 57, 68, 74
EI700U	.54	ERT707	.45, 57, 68, 74
EI700UAT	.55	ERT708	.49, 60, 76
EI2700	.64	ERT708	.60
EI2700R	.65	ERT709	.45
EI2700AT	.66	ERT709WHT	.45, 57
EI4700	.80	ERT709	.57
EI4700AT	.80	ERT710G	.36, 44, 56, 68, 74
ERT401WHT	.12	ERT710	.36, 44, 56, 68, 74
ERT401LV	.18	ERT711	.39, 49
ERT401LVW	.18	ERT712	.36, 44, 56
ERT402	.13	ERT712TS	.36, 44, 56
ERT402LV	.19	ERT713TS	.37, 46
ERT403	.12	ERT713	.37, 46, 58
ERT403LV	.18	ERT713WHT	.38, 46, 58
ERT403LVG	.18	ERT713WHTTS	.38, 46, 58
ERT404LV	.19	ERT713LTS	.38, 47, 59
ERT413	.13	ERT713L	.38, 47, 59
ERT413WHT	.13	ERT714	.39, 47, 59, 69, 75
ERT501	.25	ERT714WHT	.39, 47, 59, 69, 75
ERT501WHT	.25	ERT716	.41, 48, 69, 75
ERT510	.25	ERT717	.48
ERT510WHT	.25	ERT717WHT	.48
ERT512	.25	ERT721	.40, 51, 62, 71, 77
ERT512WHT	.25	ERT723	.41, 51, 62, 71, 77
ERT513WHT	.26	ERT725	.40, 41, 52
ERT513	.26	ERT725TS	.40, 41, 52, 63
ERT513WHTTS	.26	ERT725	.52, 63
ERT513TS	.26	ERT725WHT	.53, 63
ERT520G	.24	ERT725WHTTS	.53, 63
ERT520WHT	.24	ERT4980	.79, 81
ERT520	.24	ERT4980WHT	.79, 81
ERT521	.24	ET400	.8
ERT521G	.24	ET400R	.9
ERT560	.27	ET400LV	.14
ERT570	.27	ET400LV	.15
ERT570PB	.27	ET500	.20
ERT571	.27	ET500R	.21
ERT701	.49	ET700	.42
ERT701	.60	ET700R	.43
ERT701	.76	ET2700	.72
ERT702	.50	ET2700	.73
ERT702	.61	ET4700	.78
ERT702	.76		
ERT703	.50		





Cooper Lighting

1121 Highway 74 South
 Peachtree City, Georgia
 30269

P: 770-486-4800

F: 770-486-4801

www.cooperlighting.com

International Sales USA

Cooper Lighting
 1121 Highway 74 South
 Peachtree City, Georgia
 30269

P: 770-486-4800

F: 770-486-4801

Canadian Facilities

Cooper Lighting
 5925 McLaughlin Road
 Mississauga, Ontario L5R 1B8

P: 905-507-4000

F: 905-568-7049

The Cooper Lighting

Family
 Halo
 Metalux
 Lumark
 Sure-Lites
 Neo-Ray
 Corelite
 Portfolio
 Iris
 Shaper
 Lumière
 Invue
 McGraw-Edison
 io
 Fail-Safe
 MWS
 DLS
 RSA
 Ametrix

USA Facilities

Cranbury, New Jersey
 Elk Grove Village, Illinois
 Irving, Texas
 Ontario, California
 Peachtree City, Georgia

Canadian Facilities

Calgary, Alberta

**Your Authorized Cooper Lighting
Distributor is:****Cooper Connection**

 **COOPER** Lighting

 **COOPER** Wiring Devices

 **COOPER** B-Line

 **COOPER** Crouse-Hinds

 **COOPER** Bussmann

 **COOPER** Power Systems

Halo, ALL-PRO, ALL-NAIL and AIR-TITE are valuable trademarks of Cooper Industries in the United States and other countries. You are not permitted to use the Cooper Trademarks without the proper written consent of Cooper Industries.

Cooper Industries Ltd.

600 Travis, Ste. 5800
 Houston, TX 77002-1001
 P: 713-209-8400
www.cooperindustries.com