

# Finger-safe CUBEFuse holders



### Catalog symbols\*

- TCFH(amps)N (600 V UL Listed)
- TCFH(amps)NW (690 V UL Recognized)

\* Each CUBEFuse holder accepts any CUBEFuse up to its amp rating.

### Description

The Bussmann™ series CUBEFuse™ holder is a finger-safe modular system of single-pole 30, 60 and 100 amp holders. All holders are capable of being dovetailed together to create the desired number of poles for the application, including mixed amp ratings. The CUBEFuse holder is available in two versions: the 600 V UL® Listed holders that utilize either the time-delay (TCF) or fast-acting (FCF) CUBEFuse and the 690 V UL Recognized version that utilizes the fast-acting wind CUBEFuse (WCF).

### Ratings

- Volts
  - 600 Vac/dc (UL Listed)
  - 690 Vac/dc (UL Recognized)
- Amps
  - 30, 60, 100
- SCCR
  - 300 kA RMS Sym. (UL Listed)
  - 200 kA RMS Sym. (CSA Certified)
  - 100 kA DC (UL Listed and CSA Certified)
  - 50 kA RMS Sym. (UL Recognized)

### Agency information

- 600 V UL Listed, Guide IZLT, File E14853
- 690 V UL Recognized, Guide IZLT2, File E14853
- CSA Certified, Class 6225-01, File 47235, cURus component Certified
- CE
- RoHS compliant

### Mounting

- 35 mm DIN-Rail
- Panel mount

### Operating and storage temperature range

- -40°C to 80°C (-40°F to 176°F)

Catalog no.	Volts	Amps	Accepts fuse amp range
<b>600 V UL Listed</b>			
TCFH30N		30	1-30
TCFH60N	600	60	1-60
TCFH100N		100	1-100
<b>690 V UL Recognized</b>			
TCFH30NW		30	1-30
TCFH60NW	690	60	1-60
TCFH100NW		100	1-100

### Features

- Finger-safe construction for enhanced electrical safety
- 30, 60 and 100 amp ratings help prevent overfusing by rejecting higher fuse amp ratings
- Smallest installed fuse and holder footprint of any Class J, T or RK installation
- 35 mm DIN-Rail or panel mount for flexible installation
- All holders dovetail together to create the required number of poles
- All holders accept equal and lower amp-rated TCF\_ indicating and TCF\_RN non-indicating time-delay or FCF\_RN fast-acting CUBEFuse — no need for fuse reducers to install a lower-rated CUBEFuse
- Dual wire rated terminals for wiring ease
- Up to 300 kA SCCR withstands high fault currents

**CUBEFuse holder fuse applications**

Holder catalog no.	Volts	CUBEFuse type and amp range		
		TCF and TCF_RN	FCF_RN	WCF_RN
TCFH30N	600	1-30	1-30	
TCFH60N		1-60	1-60	—
TCFH100N		1-100	1-100	
TCFH30NW	690			1-30
TCFH60NW		—	—	1-60
TCFH100NW				1-100

**Conductor ratings and terminal torques**

Ratings are for 75°C Cu AWG conductors. Table values are expressed in AWG range, followed by torque in N•m followed by lb-in in parentheses.

Terminal wire rating	Holder catalog no.		
	TCFH30N / TCFH30NW	TCFH60N / TCFH60NW	TCFH100N / TCFH100NW
Single	8-10 / 2.8 (25) 12-18 / 2.6 (20)	10-14 / 2.6 (20) 4-8 / 3.9 (35)	10-18 / 2.6 (20)** 1-8 / 4.5 (40)†
Dual	10-18 / 2.8 (25)*	10-18 / 2.6 (20) 6-8 / 3.9 (35)	6 / 5.1 (45)†

\* 10-18 AWG stranded, 14-18 AWG solid  
\*\*Solid and stranded

**Carton quantity and weight**

Amp rating	Qty.	Weight per carton lbs (kg)
30	12	2.42 (1.10)
60	12	2.57 (1.17)
100	6	1.38 (0.63)



All CUBEFuse holders dovetail together to create the desired number of poles.

**Dimensions — in (mm)**

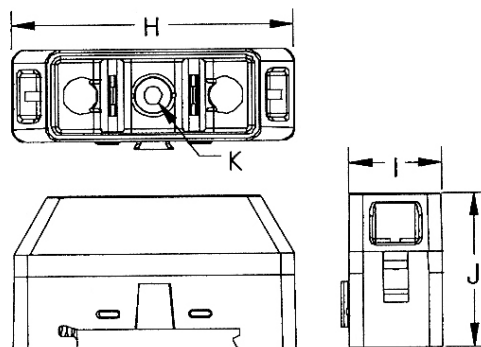

30 and 60 amp holders

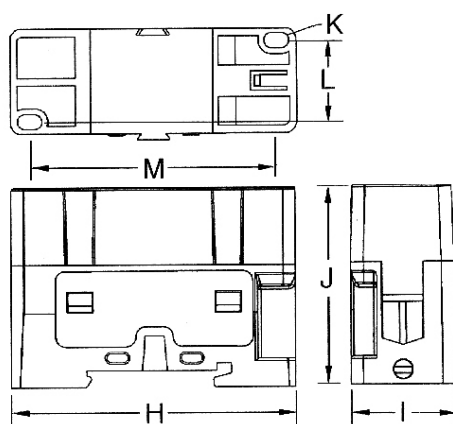

100 amp holder

Amps	H	I	J	K	L	M	Max height with fuse
30	2.3 (58)	0.76 (19)	1.36 (34)	0.15 (4)	—	—	2.36 (60)
60	2.6 (66)	1.03 (26)	1.60 (41)	0.17 (4)	—	—	2.73 (69)
100	2.91 (74)	1.05 (27)	2.01 (51)	0.15 (4)	0.80 (20)	2.51 (64)	3.27 (83)

The only controlled copy of this data sheet is the electronic read-only version located on the Eaton network drive. All other copies of this document are by definition uncontrolled. This bulletin is intended to clearly present comprehensive product data and provide technical information that will help the end user with design applications. Eaton reserves the right, without notice, to change design or construction of any products and to discontinue or limit distribution of any products. Eaton also reserves the right to change or update, without notice, any technical information contained in this bulletin. Once a product has been selected, it should be tested by the user in all possible applications.

**Eaton**  
1000 Eaton Boulevard  
Cleveland, OH 44122  
United States  
Eaton.com

Bussmann Division  
114 Old State Road  
Ellisville, MO 63021  
United States  
Eaton.com/bussmannseries

© 2018 Eaton  
All Rights Reserved  
Printed in USA  
Publication No. 9007 – BU-SB10812  
September 2018

Eaton, Bussmann, CUBEFuse, and Low-Peak are valuable trademarks of Eaton in the US and other countries. You are not permitted to use the Eaton trademarks without prior written consent of Eaton.

CSA is a registered trademark of the Canadian Standards Group  
UL is a registered trademark of the Underwriters Laboratories, Inc.

For Eaton's Bussmann series product information, call 1-855-287-7626 or visit: [Eaton.com/bussmannseries](http://Eaton.com/bussmannseries)

Follow us on social media to get the latest product and support information.

