

Dura-Lag

Dual-Element, Time-Delay Construction Grade Fuses

Class RK5 - 250 Volt

DLN-R
1/10-600A



Catalog Symbol: DLN-R

Current-Limiting
Dual-element, time-delay – 10 seconds (minimum)
at 500% rated current (8 seconds for 0-30A sizes)

Voltage Rating: 250Vac (or less)
125Vdc (1-60A, 125-200A)
250Vdc (225-600A)

Interrupting Rating: 200,000A RMS Symmetrical
20,000A DC

Agency Information:

CE, UL Listed, Std. 248-12, Class RK5, Guide 198E, File E4273 CSA Certified, C22.2 No. 248.12, Class 1422-02, File 53787

Catalog Numbers - Amp Rating

DLN-R-1	DLN-R-15	DLN-R-100
DLN-R-2	DLN-R-20	DLN-R-125
DLN-R-2½	DLN-R-25	DLN-R-150
DLN-R-3	DLN-R-30	DLN-R-175
DLN-R-3½	DLN-R-35	DLN-R-200
DLN-R-4	DLN-R-40	DLN-R-225
DLN-R-5	DLN-R-45	DLN-R-250
DLN-R-6	DLN-R-50	DLN-R-300
DLN-R-6¾	DLN-R-60	DLN-R-400
DLN-R-8	DLN-R-70	DLN-R-600
DLN-R-10	DLN-R-80	—
DLN-R-12	DLN-R-90	—

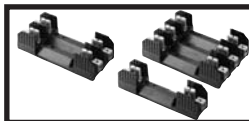

Recommended fuseblocks for Class R 250V fuses
See Data Sheet: 1110

Dimensions - in

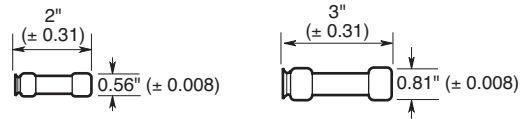

1/10A to 30A

35A to 60A

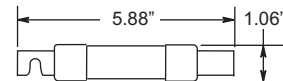

70 to 100A

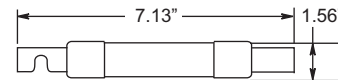

110 to 200A

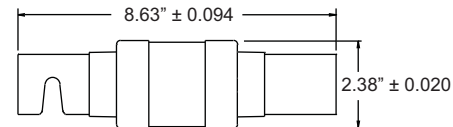

225 to 400A

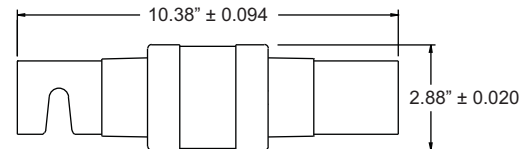

450 to 600A

- Designed for contractor needs.
- Protects industrial equipment and large motors.
- Recommended for AC power distribution system mains, feeders and branch circuits.
- Industry standard time-delay of 10 seconds at 5 times the fuse rating.

Carton Quantity and Weight

Ampere Ratings	Carton Qty.	Weight*	
		Lbs.	Kg.
1-30	10	0.56	0.252
35-60	10	1.38	0.621
70-100	5	1.56	0.702
110-200	1	0.90	0.405
225-400	1	1.80	0.810
450-600	1	3.30	1.485

*Weight per carton.

Time-Current Characteristic Curve-Average Melt

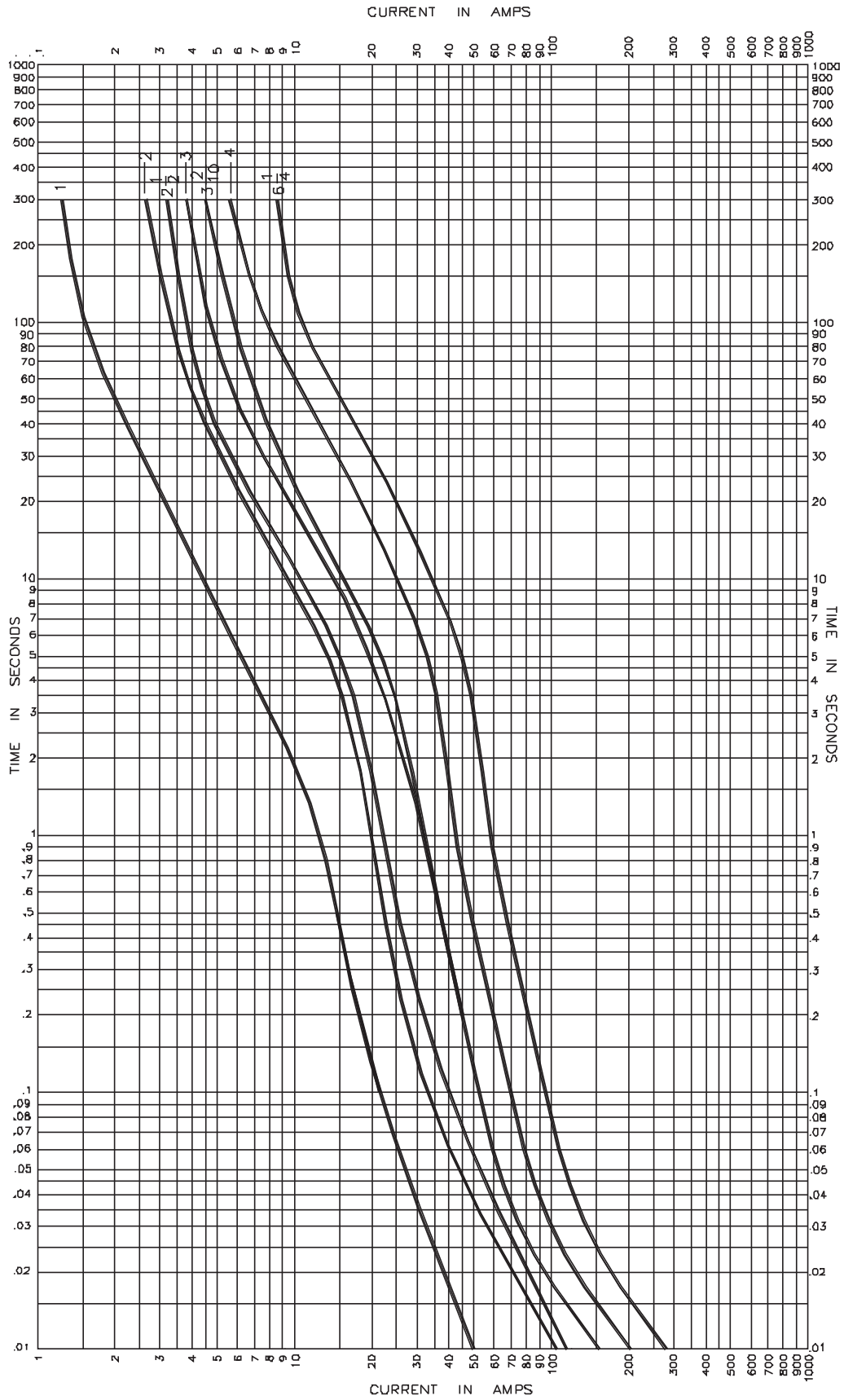

50707-1 Rev. 4-25-98

Time-Current Characteristic Curve-Average Melt

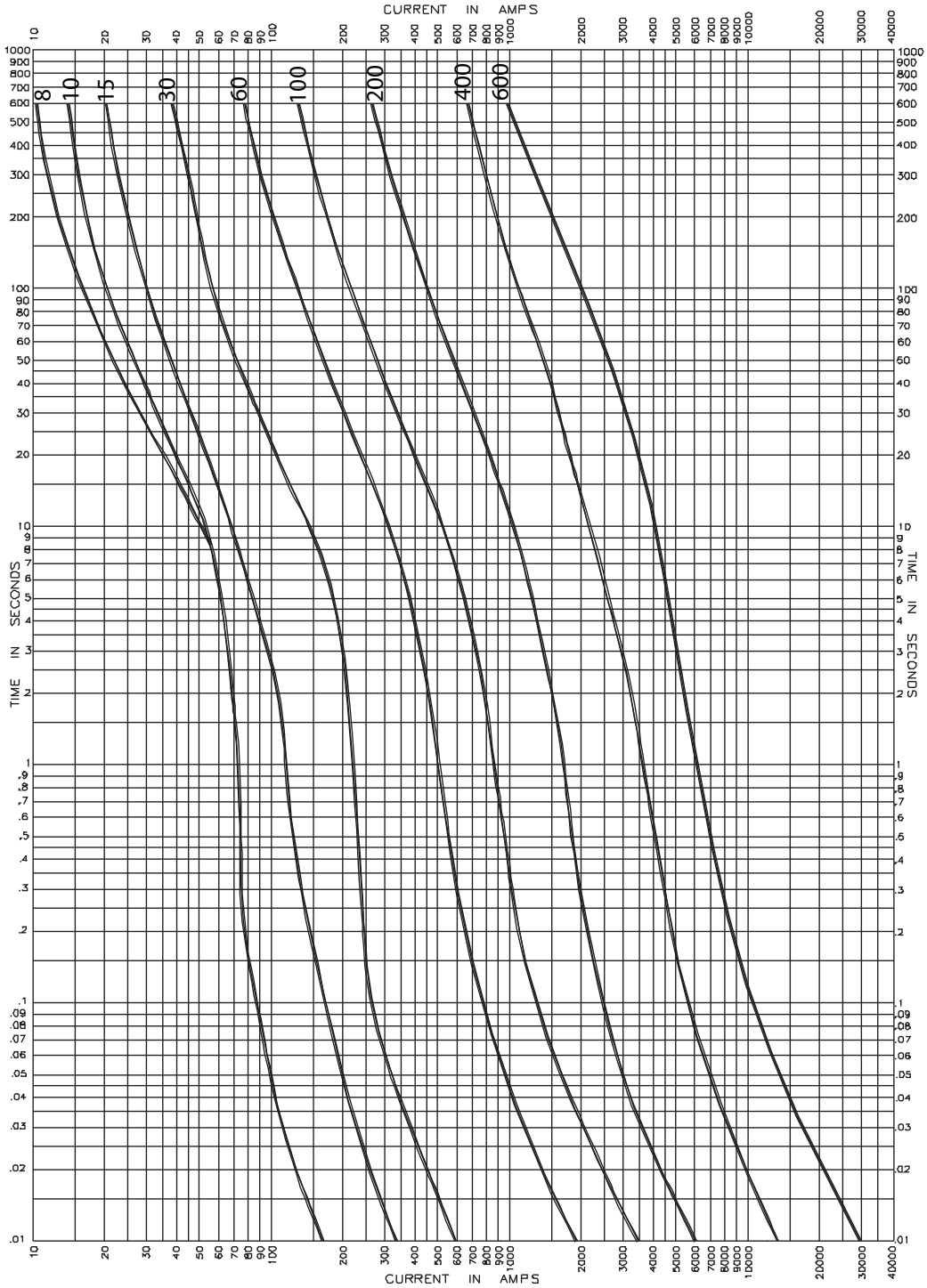

Form 250 Rev. A

The only controlled copy of this Data Sheet is the electronic read-only version located on the Cooper Bussmann Network Drive. All other copies of this document are by definition uncontrolled. This bulletin is intended to clearly present comprehensive product data and provide technical information that will help the end user with design applications. Cooper Bussmann reserves the right, without notice, to change design or construction of any products and to discontinue or limit distribution of any products. Cooper Bussmann also reserves the right to change or update, without notice, any technical information contained in this bulletin. Once a product has been selected, it should be tested by the user in all possible applications.

© 2009 Cooper Bussmann
 St. Louis, MO 63178
www.cooperbussmann.com