

Fuse Specifications

500 VDC/VAC

EVF-250

Catalog Symbol: EVF (FUSE)
Voltage Rating: 500 VDC/VAC
Current Rating: 250 Amps
Short Circuit Rating: 5 kA @ 500 VDC - 2.5 ms TC
 600 Amps or less @ 385 VDC - 2.5 ms TC
Rated Cable: 32 mm² (#2 AWG)
After-Blow Resistance: 1 MΩ minimum resistance between the terminals (<385 V)

% of Rated Current	Blow Times	
	Minimum	Maximum
100%	100 hr.	
135%	500 sec.	3600 sec.
200%	50 sec.	300 sec.
350%	2.0 sec.	10.0 sec.
500%	0.1 sec.	1.0 sec.

Maximum Voltage Drop: 250 mV @ 250 A
Transient Current Cycling: 75,000 cycles of 305A for 15 seconds followed by 280A for 45 seconds followed by zero A for 3 minutes forced air cooling.
Life Cycle: 150,000 cycles of 120% rated current for 10 sec-

onds, followed by zero A for 20 seconds (test results pending).
Drop: 1 meter on to concrete in 3 axes.
Endbell Pull: 3,000 Newtons minimum.
Endbell Torque: 30 NM minimum.
Vibration: 1.5 mm displacement frequency from 10Hz to 55 Hz to 10 Hz in one minute. 2 hours in each of three mutually perpendicular axes. Alternatively, test per SAE J1211. (test results pending).
Accelerated Aging: 60 cycles of the following (test results pending).
 16 hr. at 50% ±5% relative humidity @85°C ±2°C, 75% rated current and vibration (10-200 Hz in 20 min.).
 2 hr. at -30 °C ±2°C.
 2 hr. at 85 °C ±2°C.
 4 hr. at room ambient.
Thermal Shock: 48 cycles under following conditions:
 30 min. @ -30°C ±2°C.
 30 min. @ 85°C ±2°C.
Salt Fog: 16 hour exposure per ASTM B117.
Battery Electrolyte Resistance: Tested per SAE J1888 with:
 Sulfuric acid (specific gravity of 1.31 - 1.33)
 Potassium hydroxide (molarity of 6)

EVF 250 FUSE

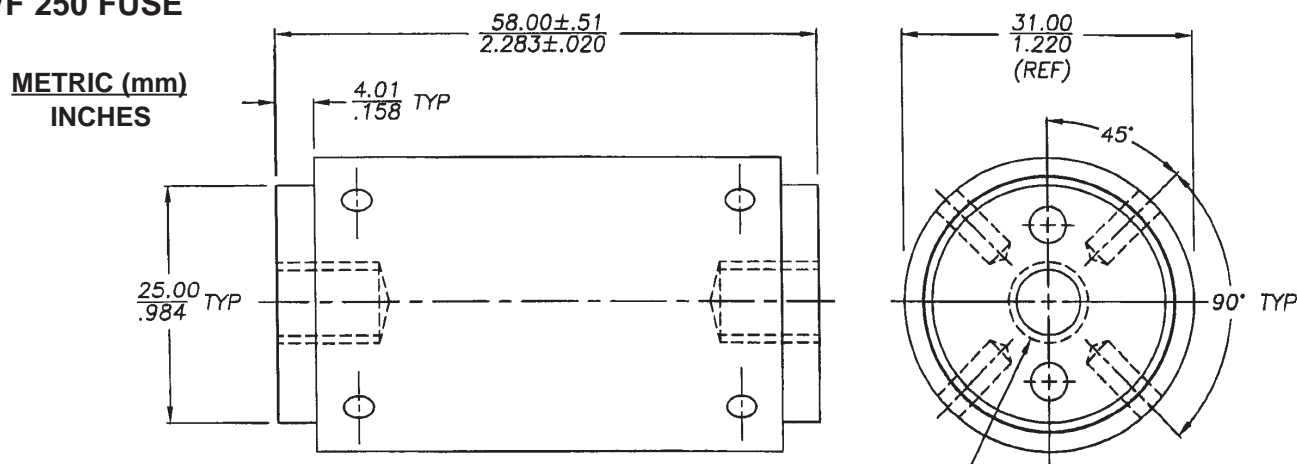

MELAMINE TUBE
 BRASS TERMINALS - SILVER PLATED

ELECTRICAL RATINGS :
 385 VDC FOR CURRENTS LESS THAN 600 AMPS,
 500 VAC/VDC 200,000 AMP INTERRUPTING RATING.

THERMAL SHOCK : 30 MIN. @ EACH -30°C THEN
 +85°C 48 CYCLES

SALT-FOG TEST : PER ASTM B117 FOR 16 HOURS.
 +85°C 48 CYCLES

BATTERY ELECTROLYTE RESISTANCE TEST : SAMPLES BRUSHED
 WITH BATTERY ELECTROLYTE (4% SULFURIC ACID) HEAT AGED
 @ 85°C FOR 96 HOURS.

8M x 1.25 BOTTOM
 TAPPED
 8.00
 .315 MIN.
 THREAD DEPTH
 BOTH ENDS
 (DO NOT EXCEED
 30 NM OR 22 LB/FT
 TORQUE)

Fuse Specifications

500 VDC/VAC

EVF-250

Peak Current in Amperes

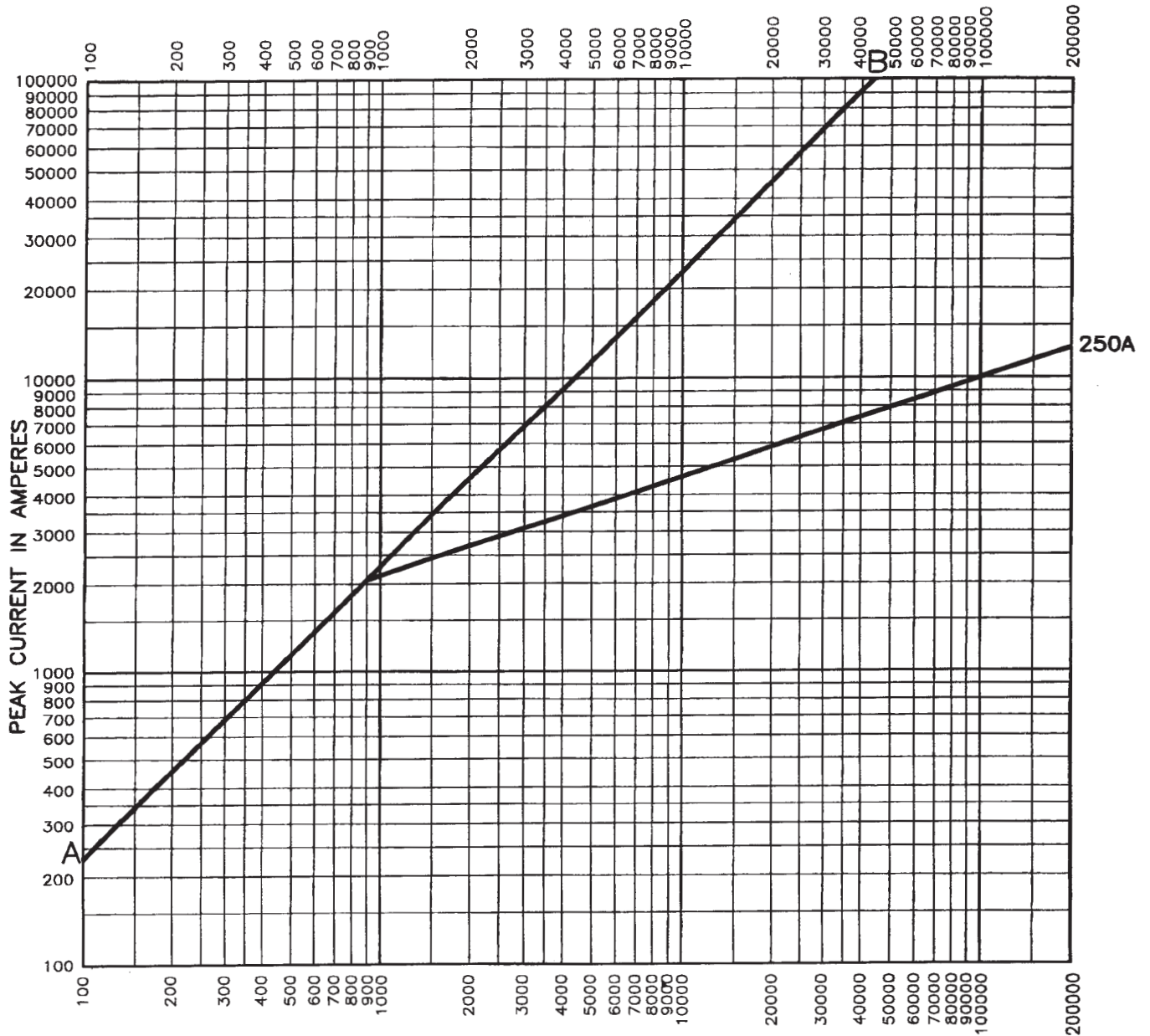

Fuse Specifications

500 VDC/VAC

EVF-250

I^2T (Amperes² Seconds)

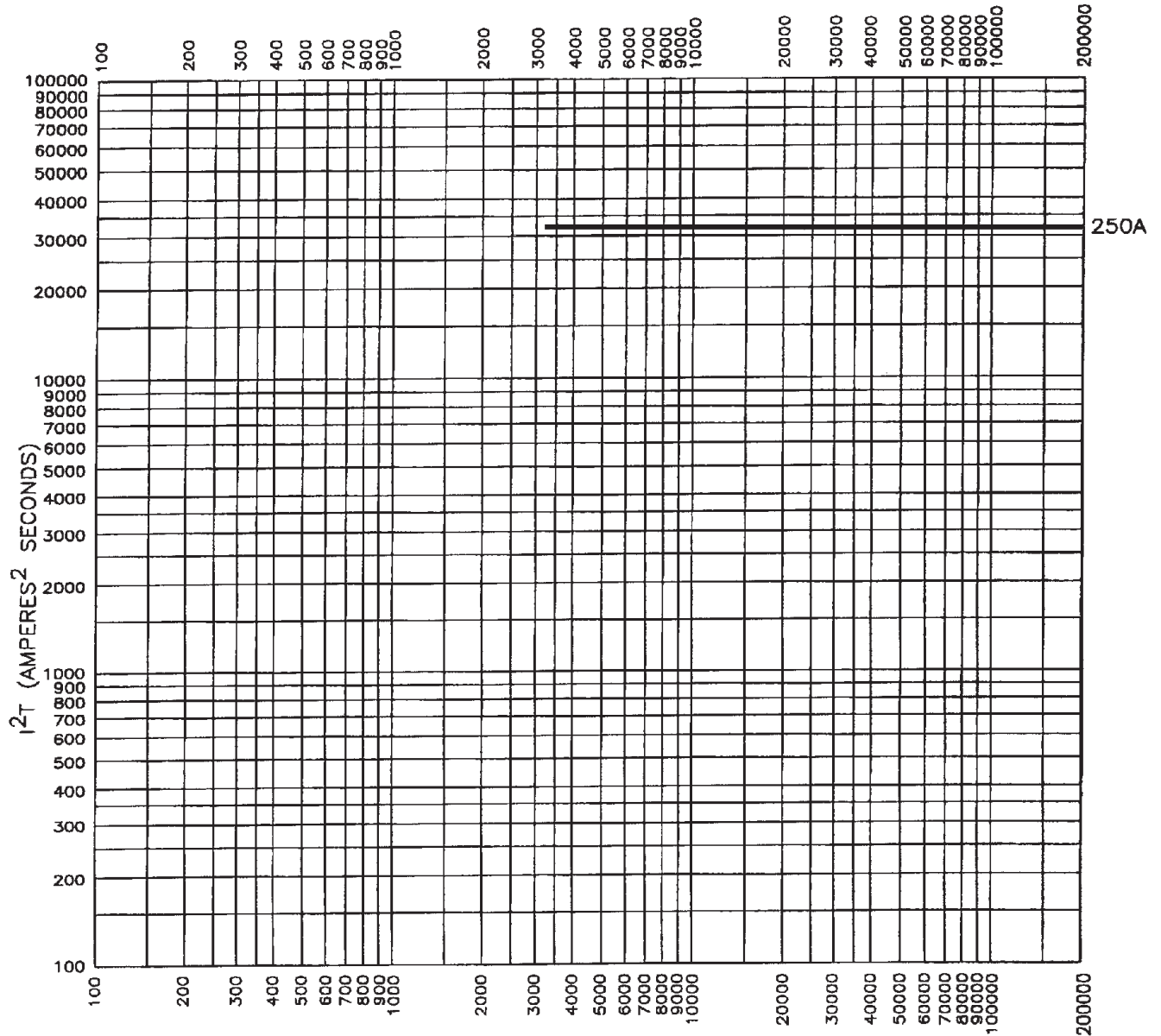

Fuse Specifications

500 VDC/VAC

EVF-250

Time-Current Characteristic Curve Minimum Melting

