

Multi-Power Distribution Blocks

600 Volt, 1520 and 2280 Amps

11970

13016

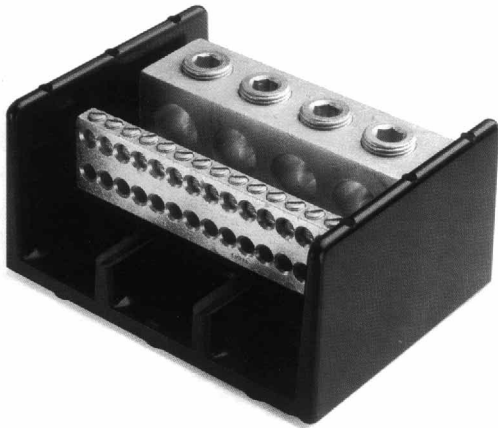

Dimensional Data

Catalog No. 11970, 600V, 1520A

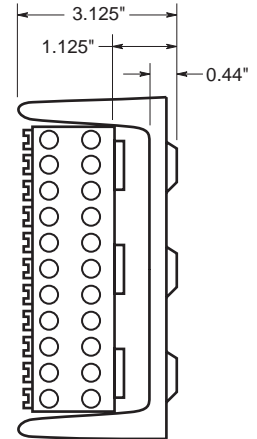
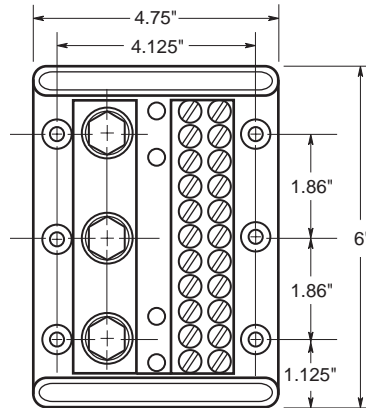

Catalog No. 13016, 600V, 2280A

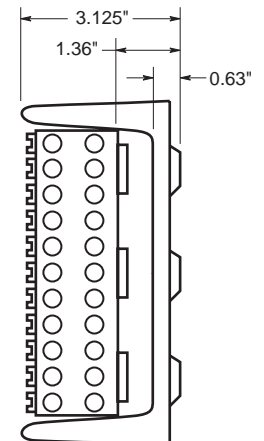
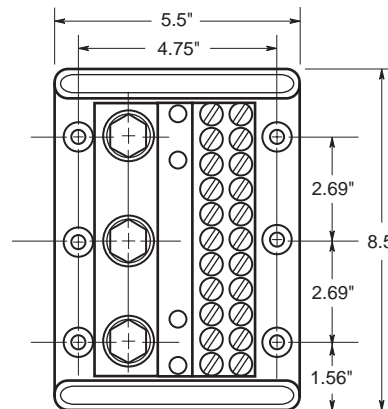

CATALOG SYMBOL: 11970 AND 13016
 MULTI-POWER DISTRIBUTION BLOCKS
 600 VOLTS or less
 U.L. LISTED—(GUIDE # XCFR2, FILE # E62622)

Specifications

Cat. No.	Line Side Wire Range	Available Openings		Load Side Wire Range	Amps	Agency Acceptance
		Line	Load			
11970	500MCM-2Cu-Al	4	28	#4-#14 Cu-Al	1520	U.L.
13016	500MCM-2Cu-Al	6	42	#4-#14 Cu-Al	2280	U.L.

Connector Size Information

- Wire hole openings sized to accept stranded conductors with the number of strands specified in U.L. Standard 486.
- Conductors with a greater number of strands will have a larger diameter and may not fit into the wire hole.
- The table lists strandings specified in U.L. 486.

Conductor Size	Number of Strands
14-2*	7
1-4/0	19
225-500	37

*10, 12, and 14 AWG sizes are usually solid.

The only controlled copy of this BIF document is the electronic read-only version located on the Bussmann Network Drive. All other copies of this BIF document are by definition uncontrolled. This bulletin is intended to clearly present comprehensive product data and provide technical information that will help the end user with design applications. Bussmann reserves the right, without notice, to change design or construction of any products and to discontinue or limit distribution of any products. Bussmann also reserves the right to change or update, without notice, any technical information contained in this bulletin. Once a product has been selected, it should be tested by the user in all possible applications.