



Single Tier
(pages 1 & 2)



Cantilever
(page 3)



Stack
(page 4)

Single Tier Install

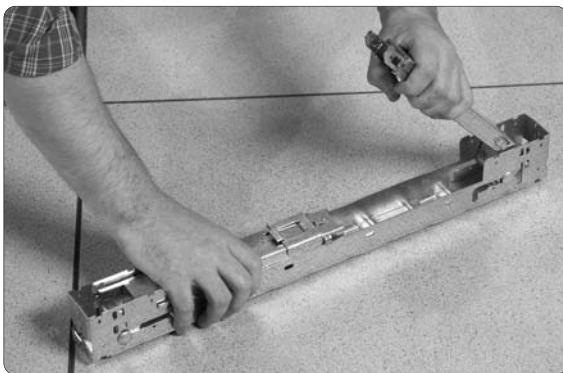

Step 1. Unfold legs.

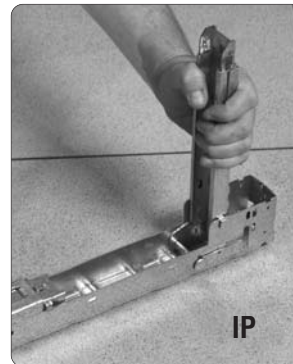

IP

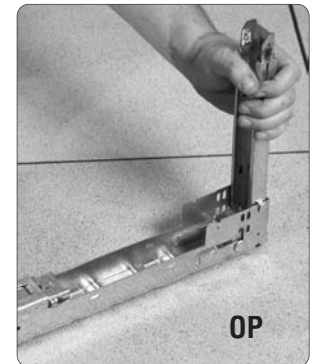

OP

Step 2. Slide and lock legs into position. Inner position (IP) for clearance between pedestals or outer position (OP) for stacking.

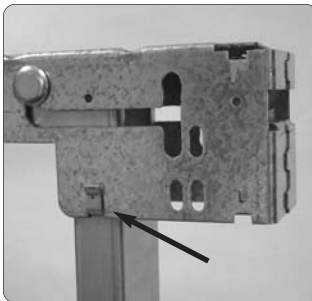

Locked in inner position.

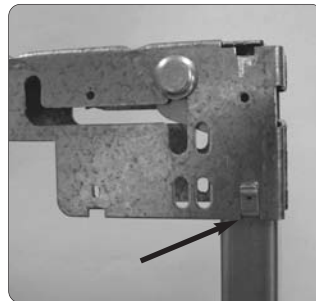

Locked in outer position.

Step 2a. Make sure tabs on legs are fully engaged and locked into the proper inner or outer notches.

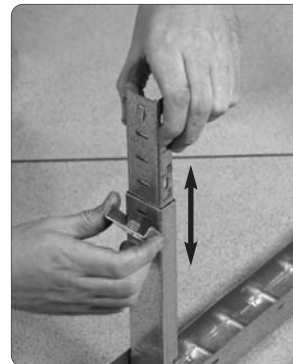

Step 3. Adjust legs to the desired height and lock in adjustment clip. Values on leg represent stand height.



Single Tier Install (cont.)

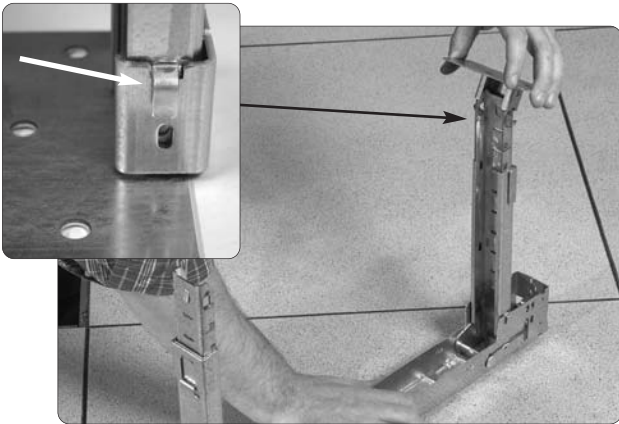

Step 5. Install feet on stand. Locking tabs on leg are to be fully engaged in foot notch (see insert).

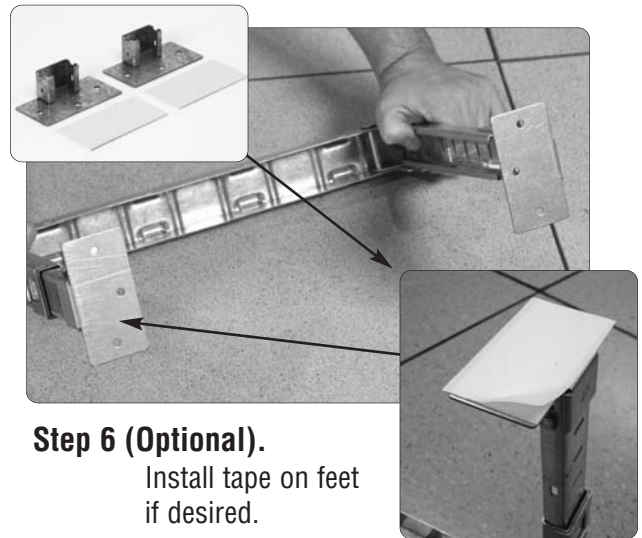

Step 6 (Optional).
Install tape on feet if desired.



Step 7. Position stands.



Step 8. Install wire baskets.

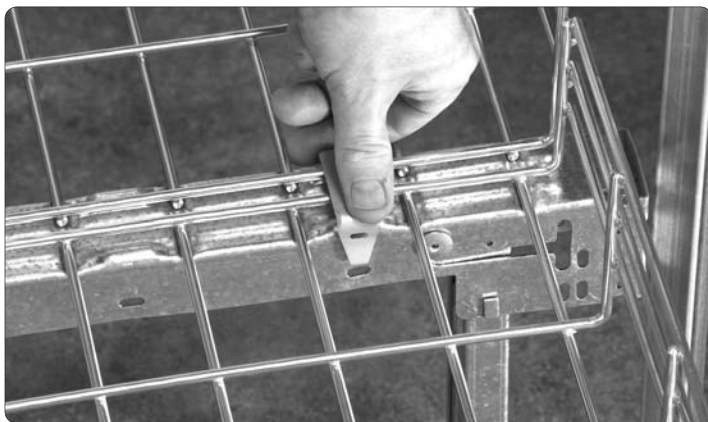

Step 9. Install hold down clips as wire baskets are laid in place.

**For Cantilever Install
see page 3**

**For Stack Install
see page 4**

Cantilever Install

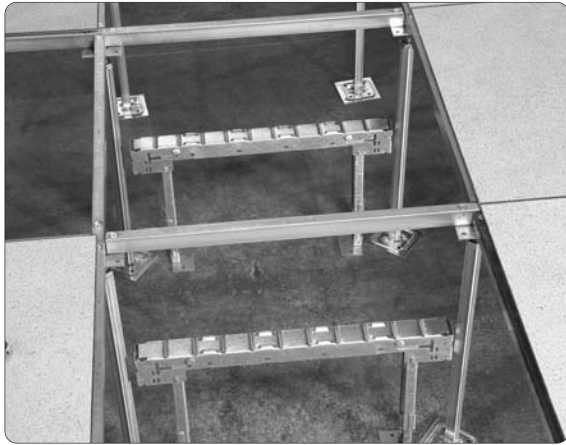

Step 1. Install first tier of stands.

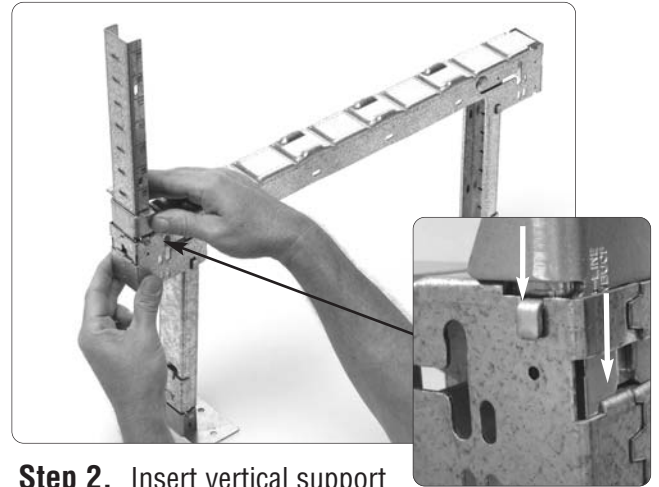

Step 2. Insert vertical support and slide cantilever foot into position. Make sure tabs are fully engaged in notches. Cantilever foot is not required when stand legs are in the outer position.

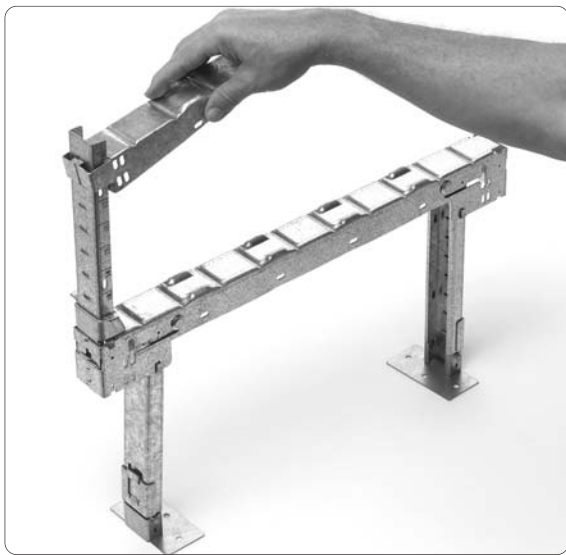

Step 3. Slide shelf bracket over vertical support. Pivot down to lock into correct height.



Step 4. Install basket and hold down clips.



Step 5 (Optional).
If desired, install pedestal clips.



Step 6. Install additional tiers if applicable.

Stack Install



Step 1. Install first tier with baskets and clips.

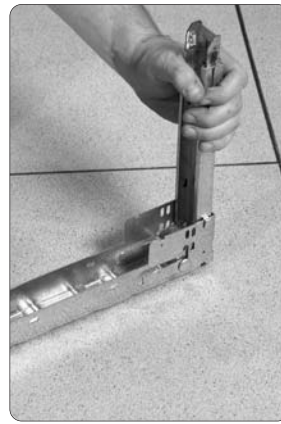

Step 2. Assemble stands with legs in outer position and adjust height.

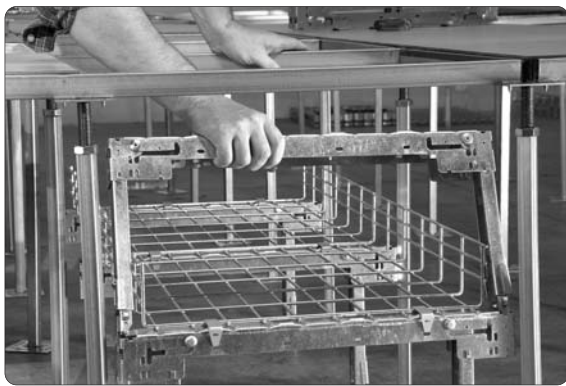

Step 3. Stack stand onto first tier. Tabs are to be fully engaged in slots (see Step 4).

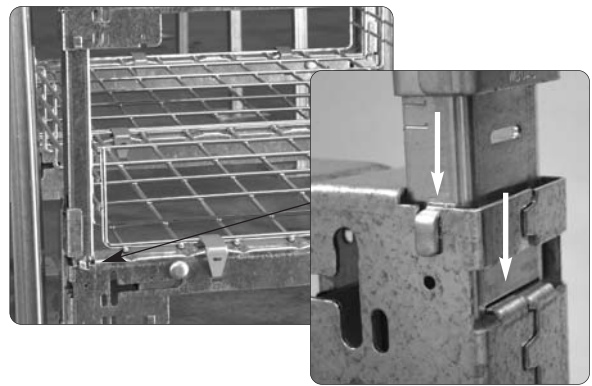

Step 4. Make sure tabs on bottom of legs are fully inserted into notches on the stand.

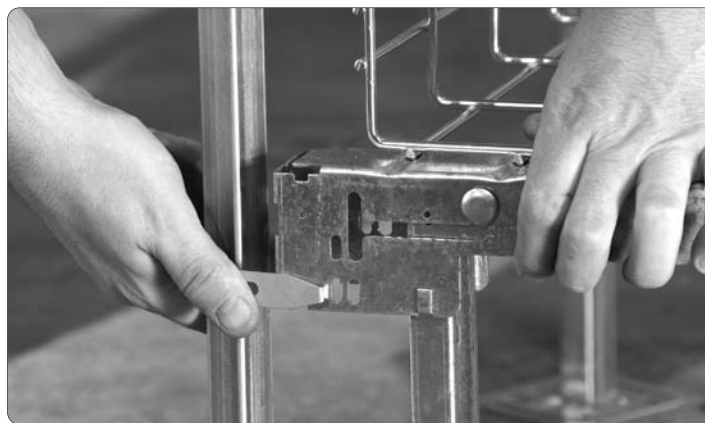

Step 5 (Optional).
If desired, install pedestal clips.