

Series 2, 3, 4, & 5 - Fittings

Series 2, 3, 4, & 5 Fittings





How The Service Advisor Works

B-Line knows that your time is important! That's why the color-coding system in this catalog is designed to help you select products that fit your service needs. Products are marked to indicate the typical lead time for orders of 50 pieces or less.

Customer: How do I select my fittings so that I get the quickest turnaround?

Service Advisor: Each part of our selection chart is shown in colors. If any section of a part number is a different color, the part will typically ship with the longer lead time represented by the colors.

- Green = Fastest shipped items
- Black = Normal lead-time items
- Red = Normally long lead-time items

Example: 5 G - 09 - 90 HB 24

● ● ● ● ● ●

Part will have a long lead time because of the G material.

Changing the part number from G to A or P will change the coding to black and reduce lead time.

Series 2, 3, 4, & 5 - Fittings

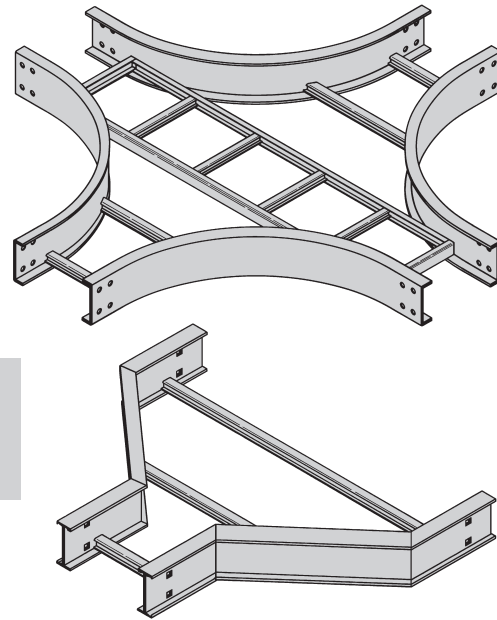
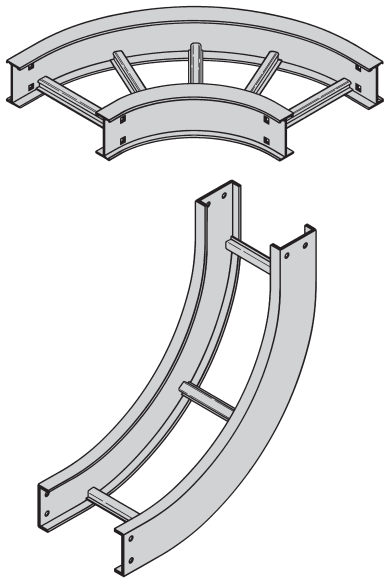

Fittings engineered with 3" tangents for splicing integrity.

Series 2, 3, 4, & 5 Fittings

Fittings Part Numbering

Prefix

Example: **4 A - 24 - 90 HB 24**

(9" rung spacing is standard)

Side Rail Height

- 4 = 4" (101)
- 5 = 5" (127)
- 6 = 6" (152)
- 7 = 7" (178)

Material

- A= Aluminum
- G=HDGAF
- P= Pre-Galvanized
- SS4= 304 Stainless Steel
- SS6= 316 Stainless Steel

Width

- 06 = 6" (152)
- 09 = 9" (228)
- 12 = 12" (305)
- 18 = 18" (457)
- 24 = 24" (609)
- 30 = 30" (762)
- 36 = 36" (914)

Angle

- 30 = 30°
- 45 = 45°
- 60 = 60°
- 90 = 90°

Type

- HB = Horizontal Bend
- HT = Horizontal Tee
- HX = Horizontal Cross
- VI = Vertical Inside Bend
- VO = Vertical Outside Bend
- VT = Vertical Tee
- VTU = Vertical Tee, Up
- HYR = Horizontal Wye, Right
- HYL = Horizontal Wye, Left
- CSF = Cable Support Fitting
- LR = Left Reducer Fitting
- RR = Right Reducer Fitting
- SR = Straight Reducer Fitting

Radius

- 12 = 12" (305)
- 24 = 24" (609)
- 36 = 36" (914)
- 48 = 48" (1219)

See page 363 for 6" fittings with 9A-6006 and 9A-6007 splice plates.

For ventilated trough, solid trough, ventilated bottom or solid bottom, add VT, ST, 04 or SB as shown below: Available 6" thru 36"

Prefix
4AVT - 24 - 90HB24

Vented Trough

Prefix
4PST - 24 - 90HB24

Non-Ventilated Trough

For flat non-ventilated: Available 6" and Wider

Prefix
5PSB - 24 - 90HB24

Non-Ventilated

Note: Horizontal crosses and tees 30" or wider, with a radius of 36" or larger, will be of two-piece construction.

● Green = Fastest shipped items ● Black = Normal lead-time items ● Red = Normally long lead-time items

Series 2, 3, 4, & 5 - Fittings

Horizontal Bend 90° 60° (HB)

1 pair splice plates with hardware included.

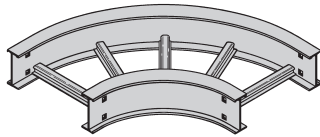

90° Horizontal Bend

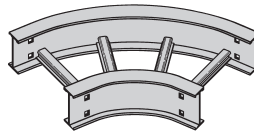

60° Horizontal Bend

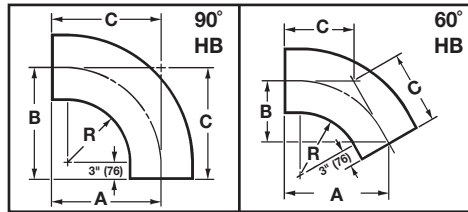

Bottoms manufactured:

Ladder = 9" Rung Spacing

VT & 04 = 4" Rung Spacing

ST & SB = Flat sheet over

12" Rung Spacing

Bend Radius R	Tray Width		90° Horizontal Bend Dimensions						60° Horizontal Bend Dimensions									
			Catalog No.			A		B		Catalog No.			A		B		C	
			in.	mm	in.	mm	in.	mm	in.	mm	in.	mm	in.	mm	in.	mm	in.	mm
12	305	6	152	(Pre)-06-90HB12	18	457	18	457	18	457	(Pre)-06-60HB12	17 ¹ / ₂	445	10 ¹ / ₈	257	11 ¹¹ / ₁₆	297	
		9	228	(Pre)-09-90HB12	19 ¹ / ₂	495	19 ¹ / ₂	495	19 ¹ / ₂	495	(Pre)-09-60HB12	18 ¹³ / ₁₆	478	10 ⁷ / ₈	276	12 ¹ / ₂	318	
		12	305	(Pre)-12-90HB12	21	533	21	533	21	533	(Pre)-12-60HB12	20 ¹ / ₁₆	510	11 ⁵ / ₈	295	13 ³ / ₈	340	
		18	457	(Pre)-18-90HB12	24	610	24	610	24	610	(Pre)-18-60HB12	22 ¹¹ / ₁₆	576	13 ¹ / ₈	333	15 ¹ / ₈	384	
		24	609	(Pre)-24-90HB12	27	686	27	686	27	686	(Pre)-24-60HB12	25 ⁵ / ₁₆	643	14 ⁵ / ₈	372	16 ⁷ / ₈	429	
		30	762	(Pre)-30-90HB12	30	762	30	762	30	762	(Pre)-30-60HB12	27 ⁷ / ₈	708	16 ¹ / ₈	410	18 ⁹ / ₁₆	472	
		36	914	(Pre)-36-90HB12	33	838	33	838	33	838	(Pre)-36-60HB12	30 ¹ / ₂	775	17 ⁵ / ₈	448	20 ⁵ / ₁₆	516	
		42	1218	(Pre)-42-90HB12	36	914	36	914	36	914	(Pre)-42-60HB12	33 ¹ / ₁₆	840	19 ¹ / ₈	486	22 ¹ / ₁₆	560	
24	610	6	152	(Pre)-06-90HB24	30	762	30	762	30	762	(Pre)-06-60HB24	27 ⁷ / ₈	708	16 ¹ / ₈	410	18 ⁹ / ₁₆	472	
		9	228	(Pre)-09-90HB24	31 ¹ / ₂	800	31 ¹ / ₂	800	31 ¹ / ₂	800	(Pre)-09-60HB24	29 ⁹ / ₁₆	741	16 ⁷ / ₈	429	19 ⁷ / ₁₆	494	
		12	305	(Pre)-12-90HB24	33	838	33	838	33	838	(Pre)-12-60HB24	30 ¹ / ₂	775	17 ⁵ / ₈	448	20 ⁵ / ₁₆	516	
		18	457	(Pre)-18-90HB24	36	914	36	914	36	914	(Pre)-18-60HB24	33 ¹ / ₁₆	708	19 ¹ / ₈	486	22 ¹ / ₁₆	560	
		24	609	(Pre)-24-90HB24	39	991	39	991	39	991	(Pre)-24-60HB24	35 ¹¹ / ₁₆	907	20 ⁵ / ₈	524	23 ³ / ₁₆	605	
		30	762	(Pre)-30-90HB24	42	1067	42	1067	42	1067	(Pre)-30-60HB24	38 ¹ / ₄	972	22 ¹ / ₈	564	25 ¹ / ₂	648	
		36	914	(Pre)-36-90HB24	45	1143	45	1143	45	1143	(Pre)-36-60HB24	40 ⁷ / ₈	1038	23 ⁵ / ₈	600	27 ¹ / ₄	692	
		42	1218	(Pre)-42-90HB24	48	1219	48	1219	48	1219	(Pre)-42-60HB24	43 ¹ / ₂	1105	25 ¹ / ₈	638	29	737	
36	915	6	152	(Pre)-06-90HB36	42	1067	42	1067	42	1067	(Pre)-06-60HB36	38 ¹ / ₄	971	22 ¹ / ₈	562	25 ¹ / ₂	648	
		9	228	(Pre)-09-90HB36	43 ¹ / ₂	1105	43 ¹ / ₂	1105	43 ¹ / ₂	1105	(Pre)-09-60HB36	39 ⁹ / ₁₆	1005	22 ⁷ / ₈	581	26 ³ / ₈	670	
		12	305	(Pre)-12-90HB36	45	1143	45	1143	45	1143	(Pre)-12-60HB36	40 ⁷ / ₈	1038	23 ⁵ / ₈	600	27 ¹ / ₄	692	
		18	457	(Pre)-18-90HB36	48	1219	48	1219	48	1219	(Pre)-18-60HB36	43 ¹ / ₂	1105	25 ¹ / ₈	638	29	737	
		24	609	(Pre)-24-90HB36	51	1295	51	1295	51	1295	(Pre)-24-60HB36	46 ¹ / ₁₆	1170	26 ⁵ / ₈	676	30 ¹¹ / ₁₆	780	
		30	762	(Pre)-30-90HB36	54	1372	54	1375	54	1372	(Pre)-30-60HB36	48 ¹ / ₁₆	1237	28 ¹ / ₈	714	32 ⁷ / ₁₆	824	
		36	914	(Pre)-36-90HB36	57	1448	57	1488	57	1448	(Pre)-36-60HB36	51 ¹ / ₄	1302	29 ⁵ / ₈	753	34 ³ / ₁₆	869	
		42	1218	(Pre)-42-90HB36	60	1524	60	1524	60	1524	(Pre)-42-60HB36	53 ⁷ / ₈	1368	31 ¹ / ₈	791	35 ¹⁵ / ₁₆	913	
48	1220	6	152	(Pre)-06-90HB48	54	1372	54	1372	54	1372	(Pre)-06-60HB48	48 ¹ / ₁₆	1221	28 ¹ / ₈	715	32 ¹¹ / ₁₆	830	
		9	228	(Pre)-09-90HB48	55 ¹ / ₂	1410	55 ¹ / ₂	1410	55 ¹ / ₂	1410	(Pre)-09-60HB48	49 ¹⁵ / ₁₆	1268	28 ⁷ / ₈	734	33 ⁹ / ₁₆	846	
		12	305	(Pre)-12-90HB48	57	1448	57	1448	57	1448	(Pre)-12-60HB48	51 ¹ / ₄	1302	29 ⁵ / ₈	753	34 ³ / ₁₆	868	
		18	457	(Pre)-18-90HB48	60	1524	60	1524	60	1524	(Pre)-18-60HB48	53 ⁷ / ₈	1368	31 ¹ / ₈	791	35 ¹⁵ / ₁₆	913	
		24	609	(Pre)-24-90HB48	63	1600	63	1600	63	1600	(Pre)-24-60HB48	56 ⁷ / ₁₆	1434	32 ⁵ / ₈	829	37 ⁵ / ₈	956	
		30	762	(Pre)-30-90HB48	66	1676	66	1676	66	1676	(Pre)-30-60HB48	59 ¹ / ₁₆	1500	34 ¹ / ₈	867	39 ³ / ₈	1000	
		36	914	(Pre)-36-90HB48	69	1753	69	1753	69	1753	(Pre)-36-60HB48	61 ¹¹ / ₁₆	1567	35 ⁵ / ₈	905	41 ¹ / ₈	1045	
		42	1218	(Pre)-42-90HB48	72	1829	72	1829	72	1829	(Pre)-42-60HB48	64 ¹ / ₄	1632	37 ¹ / ₈	943	42 ¹³ / ₁₆	1087	

(Pre) See page 288 for catalog number prefix.

All dimensions in parentheses are in millimeters unless otherwise specified.

Width dimensions are to inside wall. For aluminum fittings add 1.5 inches for total outside width.

Manufacturing tolerances apply to all dimensions.

Series 2, 3, 4, & 5 - Fittings

Horizontal Bend 45° 30° (HB)

1 pair splice plates with hardware included.

Bottoms manufactured:

Ladder = 9" Rung Spacing

VT & 04 = 4" Rung Spacing

ST & SB = Flat sheet over
12" Rung Spacing

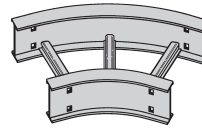

45° Horizontal Bend

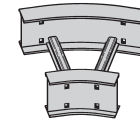

30° Horizontal Bend

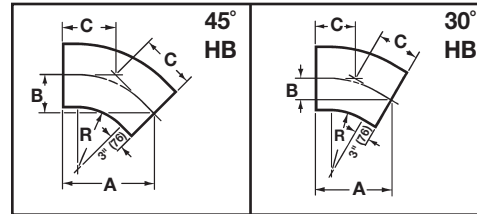

Series 2, 3, 4, & 5 Fittings

Bend Radius R	Tray Width		45° Horizontal Bend						30° Horizontal Bend								
			Dimensions						Dimensions								
			Catalog No.	A		B		C		Catalog No.	A		B		C		
in. mm	in. mm	in.	mm	in.	mm	in.	mm	in.	mm	in.	mm	in.	mm	in.	mm		
12	305	6	152	(Pre)-06-45HB12	15 ³ / ₄	400	6 ¹ / ₂	165	9 ³ / ₁₆	233	(Pre)-06-30HB12	13 ¹ / ₈	333	3 ¹ / ₂	89	7	179
		9	228	(Pre)-09-45HB12	16 ¹³ / ₁₆	427	6 ¹⁵ / ₁₆	176	9 ¹³ / ₁₆	249	(Pre)-09-30HB12	13 ⁷ / ₈	352	3 ¹¹ / ₁₆	94	7 ⁷ / ₁₆	189
		12	305	(Pre)-12-45HB12	17 ⁷ / ₈	454	7 ³ / ₈	187	10 ⁷ / ₁₆	265	(Pre)-12-30HB12	14 ⁵ / ₈	372	3 ¹⁵ / ₁₆	100	7 ¹³ / ₁₆	198
		18	457	(Pre)-18-45HB12	20	508	8 ¹ / ₄	210	11 ¹¹ / ₁₆	297	(Pre)-18-30HB12	16 ¹ / ₈	410	4 ⁵ / ₁₆	135	8 ⁵ / ₈	219
		24	609	(Pre)-24-45HB12	22 ¹ / ₁₆	560	9 ¹ / ₈	232	12 ¹⁵ / ₁₆	329	(Pre)-24-30HB12	17 ⁵ / ₈	448	4 ¹¹ / ₁₆	119	9 ⁷ / ₁₆	240
		30	762	(Pre)-30-45HB12	24 ³ / ₁₆	614	10	254	14 ³ / ₁₆	360	(Pre)-30-30HB12	19 ¹ / ₈	486	5 ¹ / ₈	130	10 ¹ / ₄	260
		36	914	(Pre)-36-45HB12	26 ⁵ / ₁₆	668	10 ¹⁵ / ₁₆	278	15 ⁷ / ₁₆	392	(Pre)-36-30HB12	20 ⁵ / ₈	524	5 ¹ / ₂	140	11 ¹ / ₁₆	281
		42	1218	(Pre)-42-45HB12	28 ⁷ / ₁₆	722	11 ¹³ / ₁₆	300	16 ¹¹ / ₁₆	424	(Pre)-42-30HB12	22 ¹ / ₈	562	5 ¹⁵ / ₁₆	151	11 ¹³ / ₁₆	300
24	610	6	152	(Pre)-06-45HB24	24 ³ / ₁₆	614	10	254	14 ³ / ₁₆	360	(Pre)-06-30HB24	19 ¹ / ₈	486	5 ¹ / ₈	130	10 ¹ / ₄	260
		9	228	(Pre)-09-45HB24	25 ¹ / ₄	641	10 ¹ / ₂	267	14 ¹³ / ₁₆	376	(Pre)-09-30HB24	19 ⁷ / ₈	505	5 ⁵ / ₁₆	135	10 ⁵ / ₈	270
		12	305	(Pre)-12-45HB24	26 ⁵ / ₁₆	668	10 ¹⁵ / ₁₆	278	15 ⁷ / ₁₆	392	(Pre)-12-30HB24	20 ⁵ / ₈	524	5 ¹ / ₂	140	11 ¹ / ₁₆	281
		18	457	(Pre)-18-45HB24	28 ⁷ / ₁₆	722	11 ¹³ / ₁₆	300	16 ¹¹ / ₁₆	424	(Pre)-18-30HB24	22 ¹ / ₈	562	5 ¹⁵ / ₁₆	151	11 ¹³ / ₁₆	300
		24	609	(Pre)-24-45HB24	30 ⁹ / ₁₆	766	12 ¹¹ / ₁₆	322	17 ¹⁵ / ₁₆	456	(Pre)-24-30HB24	23 ⁵ / ₈	600	6 ⁵ / ₁₆	160	12 ⁵ / ₈	321
		30	762	(Pre)-30-45HB24	32 ¹¹ / ₁₆	830	13 ⁹ / ₁₆	344	19 ¹ / ₈	486	(Pre)-30-30HB24	25 ¹ / ₈	638	6 ³ / ₄	172	13 ⁷ / ₁₆	341
		36	914	(Pre)-36-45HB24	34 ¹³ / ₁₆	884	14 ⁷ / ₁₆	367	20 ³ / ₈	518	(Pre)-36-30HB24	26 ⁵ / ₈	676	7 ¹ / ₈	181	14 ¹ / ₄	362
		42	1218	(Pre)-42-45HB24	36 ¹⁵ / ₁₆	938	15 ⁵ / ₁₆	389	21 ⁵ / ₈	549	(Pre)-42-30HB24	28 ¹ / ₈	715	7 ¹ / ₂	191	15 ¹ / ₁₆	383
36	915	6	152	(Pre)-06-45HB36	32 ¹¹ / ₁₆	830	13 ⁹ / ₁₆	344	19 ¹ / ₈	486	(Pre)-06-30HB36	25 ¹ / ₈	638	6 ³ / ₄	171	13 ⁷ / ₁₆	341
		9	228	(Pre)-09-45HB36	33 ³ / ₄	857	14	356	19 ³ / ₄	502	(Pre)-09-30HB36	25 ⁷ / ₈	657	6 ¹⁵ / ₁₆	176	13 ⁷ / ₈	352
		12	305	(Pre)-12-45HB36	34 ¹³ / ₁₆	884	14 ⁷ / ₁₆	367	20 ³ / ₈	518	(Pre)-12-30HB36	26 ⁵ / ₈	676	7 ¹ / ₈	181	14 ¹ / ₄	362
		18	457	(Pre)-18-45HB36	36 ¹⁵ / ₁₆	938	15 ⁵ / ₁₆	389	21 ⁵ / ₈	549	(Pre)-18-30HB36	28 ¹ / ₈	715	7 ¹ / ₂	191	15 ¹ / ₁₆	383
		24	609	(Pre)-24-45HB36	39 ¹ / ₈	992	16 ³ / ₁₆	411	22 ⁷ / ₈	581	(Pre)-24-30HB36	29 ⁵ / ₈	753	7 ¹⁵ / ₁₆	202	15 ⁷ / ₈	403
		30	762	(Pre)-30-45HB36	41 ³ / ₈	1046	17 ¹ / ₁₆	433	24 ¹ / ₈	613	(Pre)-30-30HB36	31 ¹ / ₈	790	8 ⁵ / ₁₆	211	16 ¹¹ / ₁₆	424
		36	914	(Pre)-36-45HB36	43 ⁵ / ₈	1100	17 ¹⁵ / ₁₆	456	25 ³ / ₈	645	(Pre)-36-30HB36	32 ⁵ / ₈	829	8 ³ / ₄	222	17 ¹ / ₂	445
		42	1218	(Pre)-42-45HB36	45 ⁷ / ₁₆	1154	18 ¹³ / ₁₆	478	26 ⁵ / ₈	676	(Pre)-42-30HB36	34 ¹ / ₈	867	9 ¹ / ₈	232	18 ¹ / ₄	464
48	1220	6	152	(Pre)-06-45HB48	41 ³ / ₁₆	1046	17 ¹ / ₁₆	433	24 ¹ / ₈	613	(Pre)-06-30HB48	31 ¹ / ₈	791	8 ⁵ / ₁₆	211	16 ¹¹ / ₁₆	424
		9	228	(Pre)-09-45HB48	42 ¹ / ₄	1073	17 ¹ / ₂	445	24 ³ / ₄	629	(Pre)-09-30HB48	31 ⁷ / ₈	810	8 ⁹ / ₁₆	218	17 ¹ / ₁₆	433
		12	305	(Pre)-12-45HB48	43 ⁵ / ₁₆	1100	17 ¹⁵ / ₁₆	456	25 ³ / ₈	645	(Pre)-12-30HB48	32 ⁵ / ₈	829	8 ³ / ₄	222	17 ¹ / ₂	445
		18	457	(Pre)-18-45HB48	45 ⁷ / ₁₆	1154	18 ¹³ / ₁₆	487	26 ⁵ / ₈	676	(Pre)-18-30HB48	34 ¹ / ₈	867	9 ¹ / ₈	232	18 ¹ / ₄	464
		24	609	(Pre)-24-45HB48	47 ⁹ / ₁₆	1208	19 ¹¹ / ₁₆	500	27 ⁷ / ₈	708	(Pre)-24-30HB48	35 ⁵ / ₈	905	9 ⁹ / ₁₆	243	19 ¹ / ₁₆	484
		30	762	(Pre)-30-45HB48	49 ¹¹ / ₁₆	1262	20 ⁹ / ₁₆	522	29 ¹ / ₈	740	(Pre)-30-30HB48	37 ¹ / ₈	943	9 ¹⁵ / ₁₆	252	19 ⁷ / ₈	505
		36	914	(Pre)-36-45HB48	51 ¹³ / ₁₆	1316	21 ⁷ / ₁₆	545	30 ⁵ / ₁₆	770	(Pre)-36-30HB48	38 ⁵ / ₈	981	10 ⁵ / ₁₆	262	20 ¹¹ / ₁₆	525
		42	1218	(Pre)-42-45HB48	54 ¹⁵ / ₁₆	1395	22 ⁵ / ₁₆	567	31 ⁹ / ₁₆	802	(Pre)-42-30HB48	40 ¹ / ₈	1019	10 ³ / ₄	273	21 ¹ / ₂	546

(Pre) See page 288 for catalog number prefix.

All dimensions in parentheses are in millimeters unless otherwise specified.

Width dimensions are to inside wall. For aluminum fittings add 1.5 inches for total outside width.

Manufacturing tolerances apply to all dimensions.

Series 2, 3, 4, & 5 - Fittings

Horizontal Tee (HT)

2 pair splice plates with hardware included.

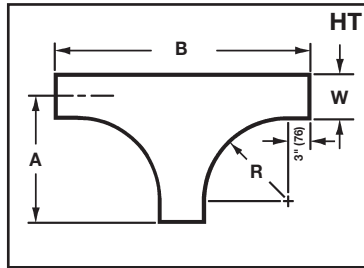
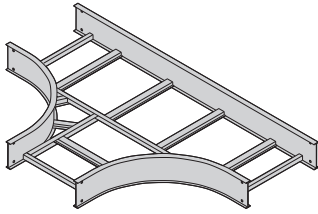

Horizontal Cross (HX)

3 pair splice plates with hardware included.

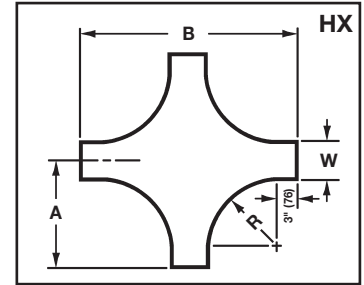
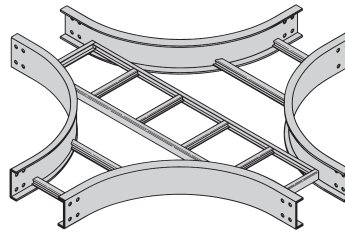

Bend Radius R	Tray Width		Horizontal Tee				Horizontal Cross						
			Catalog Number	Dimensions		Catalog Number	Dimensions						
				A	B		A	B					
in.	mm	in.	mm	in.	mm	in.	mm	in.	mm	in.	mm		
12	305	6	152	(Prefix)-06-HT12	18	457	36	914	(Prefix)-06-HX12	18	457	36	914
		9	229	(Prefix)-09-HT12	19 1/2	496	39	991	(Prefix)-09-HX12	19 1/2	496	39	991
		12	305	(Prefix)-12-HT12	21	533	42	1067	(Prefix)-12-HX12	21	533	42	1067
		18	457	(Prefix)-18-HT12	24	609	48	1219	(Prefix)-18-HX12	24	609	48	1219
		24	609	(Prefix)-24-HT12	27	686	54	1372	(Prefix)-24-HX12	27	686	54	1372
		30	762	(Prefix)-30-HT12	30	762	60	1524	(Prefix)-30-HX12	30	762	60	1524
		36	914	(Prefix)-36-HT12	33	838	66	1676	(Prefix)-36-HX12	33	838	66	1676
24	610	6	152	(Prefix)-06-HT24	30	762	60	1542	(Prefix)-06-HX24	30	762	60	1524
		9	229	(Prefix)-09-HT24	31 1/2	800	63	1600	(Prefix)-09-HX24	31 1/2	800	63	1600
		12	305	(Prefix)-12-HT24	33	838	66	1676	(Prefix)-12-HX24	33	838	66	1676
		18	457	(Prefix)-18-HT24	36	914	72	1828	(Prefix)-18-HX24	36	914	72	1828
		24	609	(Prefix)-24-HT24	39	991	78	1982	(Prefix)-24-HX24	39	991	78	1982
		30	762	(Prefix)-30-HT24	42	1067	84	2134	(Prefix)-30-HX24	42	1067	84	2134
		36	914	(Prefix)-36-HT24	45	1143	90	2286	(Prefix)-36-HX24	45	1143	90	2286
36	915	6	152	(Prefix)-06-HT36	42	1067	84	2134	(Prefix)-06-HX36	42	1067	84	2134
		9	229	(Prefix)-09-HT36	43 1/2	1105	87	2210	(Prefix)-09-HX36	43 1/2	1105	87	2210
		12	305	(Prefix)-12-HT36	45	1143	90	2286	(Prefix)-12-HX36	45	1143	90	2286
		18	457	(Prefix)-18-HT36	48	1219	96	2438	(Prefix)-18-HX36	48	1219	96	2438
		24	609	(Prefix)-24-HT36	51	1295	102	2590	(Prefix)-24-HX36	51	1295	102	2590
		30	762	(Prefix)-30-HT36	54	1372	108	2744	(Prefix)-30-HX36	54	1372	108	2744
		36	914	(Prefix)-36-HT36	57	1488	114	2896	(Prefix)-36-HX36	57	1488	114	2896
48	1220	6	152	(Prefix)-06-HT48	54	1372	108	2743	(Prefix)-06-HX48	54	1372	108	2743
		9	229	(Prefix)-09-HT48	55 1/2	1410	111	2820	(Prefix)-09-HX48	55 1/2	1410	111	2820
		12	305	(Prefix)-12-HT48	57	1448	114	2896	(Prefix)-12-HX48	57	1448	114	2896
		18	457	(Prefix)-18-HT48	60	1524	120	3048	(Prefix)-18-HX48	60	1524	120	3048
		24	609	(Prefix)-24-HT48	63	1600	126	3200	(Prefix)-24-HX48	63	1600	126	3200
		30	762	(Prefix)-30-HT48	66	1676	132	3353	(Prefix)-30-HX48	66	1676	132	3353
		36	914	(Prefix)-36-HT48	69	1753	138	3505	(Prefix)-36-HX48	69	1753	138	3505
		42	1067	(Prefix)-42-HT48	72	1829	144	3658	(Prefix)-42-HX48	72	1829	144	3658

(Prefix) See page 288 for catalog number prefix.

All dimensions in parentheses are millimeters unless otherwise specified.

Width dimensions are to inside wall. For aluminum fittings add 1.5 inches for total outside width. Manufacturing tolerances apply to all dimensions.

Series 2, 3, 4, & 5 - Fittings

Reducers (LR, SR, RR)

1 pair splice plates with hardware included.

Reducer Part Numbering

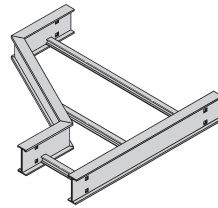
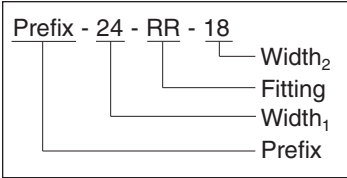

Left Reducer

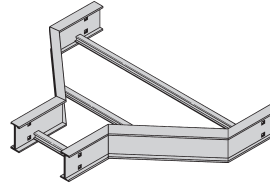

Straight Reducer

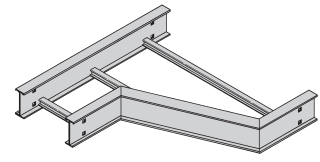

Right Reducer

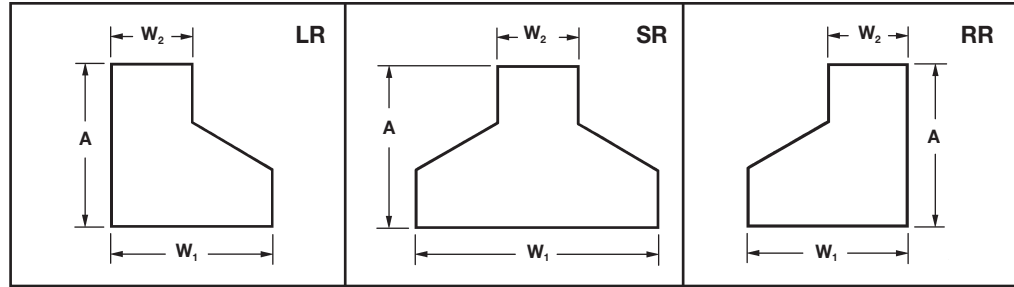

Tray Width				Left Hand Reducer				Straight Reducer				Right Hand Reducer			
W ₁		W ₂		Catalog No.		A		Catalog No.		A		Catalog No.		A	
in.	mm	in.	mm			in.	mm	in.	mm	in.	mm	in.	mm	in.	mm
9	228	6	152	(Prefix)-09-LR06	9 ³ / ₄	248	(Prefix)-09-SR06	8 ⁷ / ₈	225	(Prefix)-09-RR06	9 ³ / ₄	248			
12	305	6	152	(Prefix)-12-LR06	11 ¹ / ₂	292	(Prefix)-12-SR06	9 ³ / ₄	248	(Prefix)-12-RR06	11 ¹ / ₂	292			
		9	228	(Prefix)-12-LR09	9 ³ / ₄	248	(Prefix)-12-SR09	8 ⁷ / ₈	225	(Prefix)-12-RR09	9 ³ / ₄	248			
18	457	6	152	(Prefix)-18-LR06	14 ¹⁵ / ₁₆	379	(Prefix)-18-SR06	11 ¹ / ₂	292	(Prefix)-18-RR06	14 ¹⁵ / ₁₆	379			
		9	228	(Prefix)-18-LR09	13 ³ / ₁₆	340	(Prefix)-18-SR09	10 ⁵ / ₈	270	(Prefix)-18-RR09	13 ³ / ₁₆	340			
		12	305	(Prefix)-18-LR12	11 ¹ / ₂	292	(Prefix)-18-SR12	9 ³ / ₄	248	(Prefix)-18-RR12	11 ¹ / ₂	292			
24	609	6	152	(Prefix)-24-LR06	18 ³ / ₈	467	(Prefix)-24-SR06	13 ³ / ₁₆	340	(Prefix)-24-RR06	18 ³ / ₈	467			
		9	228	(Prefix)-24-LR09	16 ¹¹ / ₁₆	424	(Prefix)-24-SR09	12 ³ / ₈	314	(Prefix)-24-RR09	16 ¹¹ / ₁₆	424			
		12	305	(Prefix)-24-LR12	14 ¹⁵ / ₁₆	379	(Prefix)-24-SR12	11 ¹ / ₂	292	(Prefix)-24-RR12	14 ¹⁵ / ₁₆	379			
		18	457	(Prefix)-24-LR18	11 ¹ / ₂	292	(Prefix)-24-SR18	9 ³ / ₄	248	(Prefix)-24-RR18	11 ¹ / ₂	292			
30	762	6	152	(Prefix)-30-LR06	21 ⁷ / ₈	555	(Prefix)-30-SR06	14 ¹⁵ / ₁₆	380	(Prefix)-30-RR06	21 ⁷ / ₈	555			
		9	228	(Prefix)-30-LR09	20 ¹ / ₈	511	(Prefix)-30-SR09	14 ¹ / ₁₆	358	(Prefix)-30-RR09	20 ¹ / ₈	511			
		12	305	(Prefix)-30-LR12	18 ³ / ₈	462	(Prefix)-30-SR12	13 ³ / ₁₆	335	(Prefix)-30-RR12	18 ³ / ₈	462			
		18	459	(Prefix)-30-LR18	14 ¹⁵ / ₁₆	380	(Prefix)-30-SR18	11 ¹ / ₂	292	(Prefix)-30-RR18	14 ¹⁵ / ₁₆	380			
		24	609	(Prefix)-30-LR24	11 ¹ / ₂	292	(Prefix)-30-SR24	9 ³ / ₄	248	(Prefix)-30-RR24	11 ¹ / ₂	292			
36	914	6	152	(Prefix)-36-LR06	25 ⁵ / ₁₆	643	(Prefix)-36-SR06	16 ¹¹ / ₁₆	424	(Prefix)-36-RR06	23 ⁵ / ₁₆	643			
		9	228	(Prefix)-36-LR09	23 ⁹ / ₁₆	598	(Prefix)-36-SR09	15 ¹³ / ₁₆	402	(Prefix)-36-RR09	23 ⁹ / ₁₆	598			
		12	305	(Prefix)-36-LR12	21 ⁷ / ₈	555	(Prefix)-36-SR12	14 ¹⁵ / ₁₆	380	(Prefix)-36-RR12	21 ⁷ / ₈	555			
		18	457	(Prefix)-36-LR18	18 ³ / ₈	462	(Prefix)-36-SR18	13 ³ / ₁₆	335	(Prefix)-36-RR18	18 ³ / ₈	462			
		24	609	(Prefix)-36-LR24	14 ¹⁵ / ₁₆	380	(Prefix)-36-SR24	11 ¹ / ₂	292	(Prefix)-36-RR24	14 ¹⁵ / ₁₆	380			
		30	762	(Prefix)-36-LR30	11 ¹ / ₂	292	(Prefix)-36-SR30	9 ³ / ₄	248	(Prefix)-36-RR30	11 ¹ / ₂	292			
42	1067	6	152	(Prefix)-42-LR06	28 ³ / ₄	730	(Prefix)-42-SR06	18 ³ / ₈	467	(Prefix)-42-RR06	28 ³ / ₄	732			
		9	228	(Prefix)-42-LR09	27 ¹ / ₁₆	687	(Prefix)-42-SR09	17 ¹ / ₂	445	(Prefix)-42-RR09	27 ¹ / ₁₆	687			
		12	305	(Prefix)-42-LR12	25 ⁵ / ₁₆	643	(Prefix)-42-SR12	16 ¹¹ / ₁₆	424	(Prefix)-42-RR12	25 ⁵ / ₁₆	643			
		18	457	(Prefix)-42-LR18	21 ⁷ / ₈	556	(Prefix)-42-SR18	14 ¹⁵ / ₁₆	379	(Prefix)-42-RR18	21 ⁷ / ₈	556			
		24	609	(Prefix)-42-LR24	18 ³ / ₈	467	(Prefix)-42-SR24	13 ³ / ₁₆	335	(Prefix)-42-RR24	18 ³ / ₈	467			
		30	762	(Prefix)-42-LR30	14 ¹⁵ / ₁₆	379	(Prefix)-42-SR30	11 ¹ / ₂	292	(Prefix)-42-RR30	14 ¹⁵ / ₁₆	379			
		36	914	(Prefix)-42-LR36	11 ¹ / ₂	292	(Prefix)-42-SR36	9 ³ / ₄	249	(Prefix)-42-RR36	11 ¹ / ₂	292			

(Prefix) See page 288 for catalog number prefix.

All dimensions in parentheses are millimeters unless otherwise specified.

Width dimensions are to inside wall. For aluminum fittings add 1.5 inches for total outside width. Manufacturing tolerances apply to all dimensions.

Horizontal Reducing Tee (HT)

2 pair splice plates with hardware included.

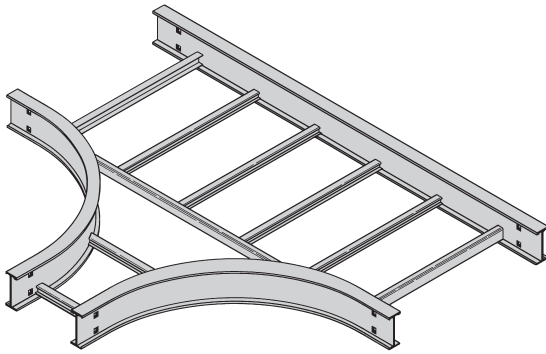

Prefix - 36 - 18 HT 24

Radius
Fitting
Width W₂
Width W₁

To complete catalog number, insert fitting prefix.

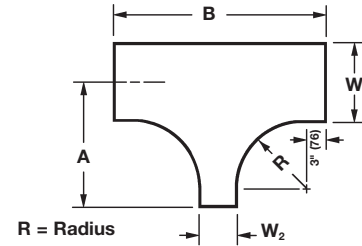

HT

Series 2, 3, 4, & 5 Fittings

Tray Width				* Insert Radius (12", 24", 36", or 48") Catalog No.	12" Radius				24" Radius				36" Radius				48" Radius			
W ₁		W ₂			A		B		A		B		A		B		A		B	
in.	mm	in.	mm	in.	mm	in.	mm	in.	mm	in.	mm	in.	mm	in.	mm	in.	mm	in.	mm	
9	228	6	152	(Prefix)-09-06-HT*	19 ¹ / ₂	496	36	914	31 ¹ / ₂	800	60	1524	43	1092	84	2134	55 ¹ / ₂	1410	108	2743
12	305	6	152	(Prefix)-12-06-HT*	21	533	36	914	33	838	60	1524	45	1143	84	2134	57	1448	108	2743
		9	228	(Prefix)-12-09-HT*	21	533	39	991	33	838	63	1600	45	1143	87	2210	57	1448	111	2819
18	475	6	152	(Prefix)-18-06-HT*	24	609	36	914	36	914	60	1524	48	1219	84	2134	60	1524	108	2743
		9	228	(Prefix)-18-09-HT*	24	609	39	991	36	914	63	1600	48	1219	87	2210	60	1524	111	2819
		12	305	(Prefix)-18-12-HT*	24	609	42	1067	36	914	66	1676	48	1219	90	2286	60	1524	114	2496
24	609	6	152	(Prefix)-24-06-HT*	27	686	36	914	39	991	60	1524	51	1295	84	2134	63	1600	108	2743
		9	228	(Prefix)-24-09-HT*	27	686	39	991	39	991	63	1600	51	1295	87	2210	63	1600	111	2819
		12	305	(Prefix)-24-12-HT*	27	686	42	1067	39	991	66	1676	51	1295	90	2286	63	1600	114	2496
30	762	18	457	(Prefix)-24-18-HT*	27	686	48	1219	39	991	72	1829	51	1295	96	2438	63	1600	120	3048
		6	152	(Prefix)-30-06-HT*	30	762	36	914	42	1067	60	1524	54	1372	84	2134	66	1676	108	2743
		9	228	(Prefix)-30-09-HT*	30	762	39	991	42	1067	63	1600	54	1372	87	2210	66	1676	111	2819
		12	305	(Prefix)-30-12-HT*	30	762	42	1067	42	1067	66	1676	54	1372	90	2286	66	1676	114	2496
36	914	18	457	(Prefix)-30-18-HT*	30	762	48	1219	42	1067	72	1829	54	1372	96	2438	66	1676	120	3048
		24	609	(Prefix)-30-24-HT*	30	762	54	1372	42	1067	78	1981	54	1372	102	2591	66	1676	126	3200
		6	152	(Prefix)-36-06-HT*	33	838	36	914	45	1143	60	1524	57	1448	84	2134	69	1753	108	2743
		9	228	(Prefix)-36-09-HT*	33	838	39	991	45	1143	63	1600	57	1448	87	2210	69	1753	111	2819
		12	305	(Prefix)-36-12-HT*	33	838	42	1067	45	1143	66	1676	57	1448	90	2286	69	1753	114	2496
42	1067	18	457	(Prefix)-36-18-HT*	33	838	48	1219	45	1143	72	1829	57	1448	96	2438	69	1753	120	3048
		24	609	(Prefix)-36-24-HT*	33	838	54	1372	45	1143	78	1981	57	1448	102	2591	69	1753	126	3200
		30	762	(Prefix)-36-30-HT*	33	838	60	1524	45	1143	84	2134	57	1448	108	2743	69	1753	132	3353
		6	152	(Prefix)-42-06-HT*	36	914	36	914	48	1219	60	1524	60	1524	84	2134	72	1829	108	2743
		9	228	(Prefix)-42-09-HT*	36	914	39	991	48	1219	63	1600	60	1524	87	2210	72	1829	111	2819
		12	305	(Prefix)-42-12-HT*	36	914	42	1067	48	1219	66	1676	60	1524	90	2286	72	1829	114	2496
		18	457	(Prefix)-42-18-HT*	36	914	48	1219	48	1219	72	1829	60	1524	96	2438	72	1829	120	3048
24	609	(Prefix)-42-24-HT*	36	914	54	1372	48	1219	78	1981	60	1524	102	2591	72	1829	126	3200		
30	762	(Prefix)-42-30-HT*	36	914	60	1524	48	1219	84	2134	60	1524	108	2743	72	1829	132	3353		
36	914	(Prefix)-42-36-HT*	36	914	66	1676	48	1219	90	2286	60	1524	114	2895	72	1829	138	3505		

(Prefix) See page 288 for catalog number prefix.

All dimensions in parentheses are millimeters unless otherwise specified.

Width dimensions are to inside wall. For aluminum fittings add 1.5 inches for total outside width.

Manufacturing tolerances apply to all dimensions.

Series 2, 3, 4, & 5 - Fittings

Horizontal Expanding Tee (HT)

2 pair splice plates with hardware included.

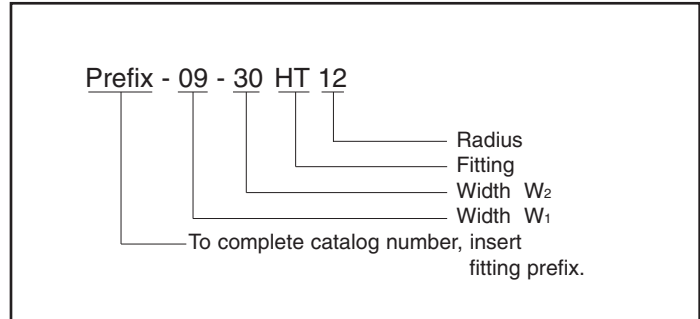
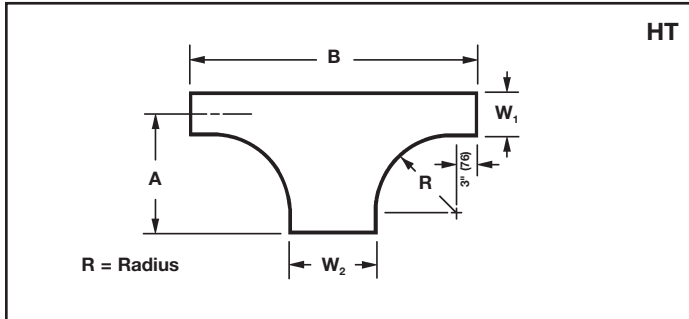
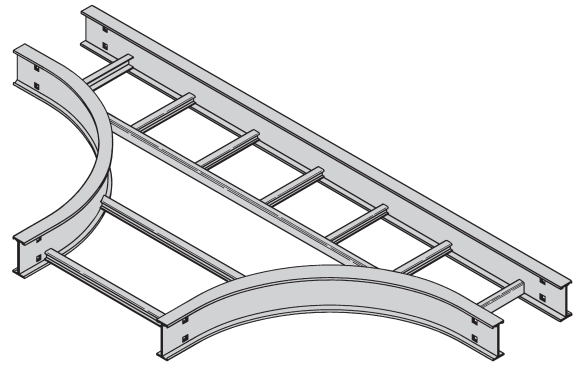

Tray Width				*Insert Radius (12", 24", 36", or 48") Catalog No.	12" Radius				24" Radius				36" Radius				48" Radius				
W ₁		W ₂			A		B		A		B		A		B		A		B		
in.	mm	in.	mm	in.	mm	in.	mm	in.	mm	in.	mm	in.	mm	in.	mm	in.	mm	in.	mm	in.	mm
6	152	9	228	(Prefix)-06-09-HT*	18	457	39	991	30	762	63	1600	42	1067	87	2210	54	1372	111	2819	
		12	305	(Prefix)-06-12-HT*	18	457	42	1067	30	762	66	1676	42	1067	90	2286	54	1372	114	2496	
		18	457	(Prefix)-06-18-HT*	18	457	48	1219	30	762	72	1829	42	1067	96	2438	54	1372	120	3048	
		24	609	(Prefix)-06-24-HT*	18	457	54	1372	30	762	78	1981	42	1067	102	2591	54	1372	126	3200	
		30	762	(Prefix)-06-30-HT*	18	457	60	1524	30	762	84	2134	42	1067	108	2743	54	1372	132	3353	
		36	914	(Prefix)-06-36-HT*	18	457	66	1676	30	762	90	2286	42	1067	114	2895	54	1372	138	3503	
		42	1067	(Prefix)-06-42-HT*	18	457	72	1829	30	762	96	2438	42	1067	120	3048	54	1372	144	3658	
9	228	12	305	(Prefix)-09-12-HT*	19 1/2	496	42	1067	31 1/2	800	66	1676	43 1/2	1105	90	2286	55 1/2	1410	114	2496	
		18	457	(Prefix)-09-18-HT*	19 1/2	496	48	1219	31 1/2	800	72	1829	43 1/2	1105	96	2438	55 1/2	1410	120	3048	
		24	609	(Prefix)-09-24-HT*	19 1/2	496	54	1372	31 1/2	800	78	1981	43 1/2	1105	102	2591	55 1/2	1410	126	3200	
		30	762	(Prefix)-09-30-HT*	19 1/2	496	60	1524	31 1/2	800	84	2134	43 1/2	1105	108	2743	55 1/2	1410	132	3353	
		36	914	(Prefix)-09-36-HT*	19 1/2	496	66	1676	31 1/2	800	90	2286	43 1/2	1105	114	2895	55 1/2	1410	138	3503	
		42	1067	(Prefix)-09-42-HT*	19 1/2	496	72	1829	31 1/2	800	96	2438	43 1/2	1105	120	3048	55 1/2	1410	144	3658	
12	305	18	457	(Prefix)-12-18-HT*	21	533	48	1219	33	838	72	1829	45	1143	96	2438	57	1448	120	3048	
		24	609	(Prefix)-12-24-HT*	21	533	54	1372	33	838	78	1981	45	1143	102	2591	57	1448	126	3200	
		30	762	(Prefix)-12-30-HT*	21	533	60	1524	33	838	84	2134	45	1143	108	2743	57	1448	132	3353	
		36	914	(Prefix)-12-36-HT*	21	533	66	1676	33	838	90	2286	45	1143	114	2895	57	1448	138	3503	
		42	1067	(Prefix)-12-42-HT*	21	533	72	1829	33	838	96	2438	45	1143	120	3048	57	1448	144	3658	
				24	609	(Prefix)-18-24-HT*	24	609	54	1372	36	914	78	1981	48	1219	102	2591	60	1524	126
18	457	30	762	(Prefix)-18-30-HT*	24	609	60	1524	36	914	84	2134	48	1219	108	2743	60	1524	132	3353	
		36	914	(Prefix)-18-36-HT*	24	609	66	1676	36	914	90	2286	48	1219	114	2895	60	1524	138	3503	
		42	1067	(Prefix)-18-42-HT*	24	609	72	1829	36	914	96	2438	48	1219	120	3048	60	1524	144	3658	
				30	762	(Prefix)-24-30-HT*	27	686	60	1524	39	991	84	2134	51	1295	108	2743	63	1600	132
24	609	36	914	(Prefix)-24-36-HT*	27	686	66	1676	39	991	90	2286	51	1295	114	2895	63	1600	138	3503	
		42	1067	(Prefix)-24-42-HT*	27	686	72	1829	39	991	96	2438	51	1295	120	3048	63	1600	144	3658	
				36	914	(Prefix)-30-36-HT*	30	762	66	1676	42	1067	90	2286	54	1372	114	2895	66	1676	138
30	762	42	1067	(Prefix)-30-42-HT*	30	762	72	1829	42	1067	96	2438	54	1372	120	3048	66	1676	144	3658	
				36	914	(Prefix)-36-42-HT*	33	838	72	1829	45	1143	96	2438	57	1448	120	3048	69	1753	144

(Prefix) See page 288 for catalog number prefix.

All dimensions in parentheses are millimeters unless otherwise specified.

Width dimensions are to inside wall. For aluminum fittings add 1.5 inches for total outside width.

Manufacturing tolerances apply to all dimensions.

Series 2, 3, 4, & 5 - Fittings

Horizontal Expanding/Reducing Cross (HX)

3 pair splice plates with hardware included.

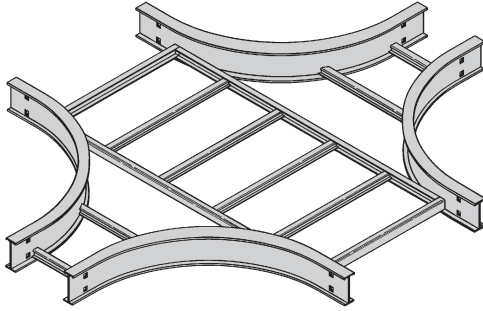

Prefix - 36 - 18 HX 24

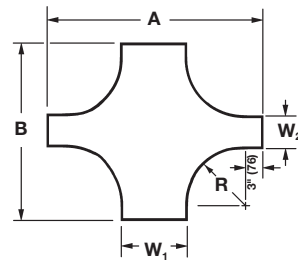
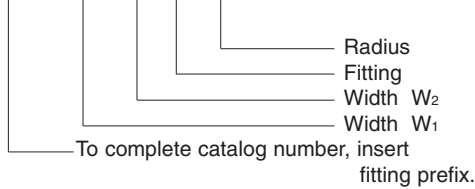

HX

Series 2, 3, 4, & 5 Fittings

Tray Width				* Insert Radius (12", 24", 36", or 48") Catalog No.	12" Radius		24" Radius		36" Radius		48" Radius									
W1 in.	W2 mm	in.	mm		A in.	B mm	A in.	B mm	A in.	B mm	A in.	B mm								
9	228	6	152	(Prefix)-09-06-HX*	39	991	36	914	63	1600	60	1372	87	2210	84	2134	111	2819	108	2743
12	305	6	152	(Prefix)-12-06-HX*	42	1067	36	914	66	1676	60	1372	90	2286	84	2134	114	2896	108	2743
		9	228	(Prefix)-12-09-HX*	42	1067	39	991	66	1676	63	1600	90	2286	87	2210	114	2896	111	2819
18	457	6	152	(Prefix)-18-06-HX*	48	1219	36	914	72	1829	60	1372	96	2438	84	2134	120	3048	108	2743
		9	228	(Prefix)-18-09-HX*	48	1219	39	991	72	1829	63	1600	96	2438	87	2210	120	3048	111	2819
24	609	12	305	(Prefix)-18-12-HX*	48	1219	42	1067	72	1829	66	1676	96	2438	90	2286	120	3048	114	2896
		6	152	(Prefix)-24-06-HX*	54	1372	36	914	78	1981	60	1372	102	2591	84	2134	126	3200	108	2743
		9	228	(Prefix)-24-09-HX*	54	1372	39	991	78	1981	63	1600	102	2591	87	2210	126	3200	111	2819
30	762	12	305	(Prefix)-24-12-HX*	54	1372	42	1067	78	1981	66	1676	102	2591	90	2286	126	3200	114	2896
		18	457	(Prefix)-24-18-HX*	54	1372	48	1219	78	1981	72	1829	102	2591	96	2438	126	3200	120	3048
		6	152	(Prefix)-30-06-HX*	60	1524	36	914	84	2134	60	1372	108	2743	84	2134	132	3353	108	2743
		9	228	(Prefix)-30-09-HX*	60	1524	39	991	84	2134	63	1600	108	2743	87	2210	132	3353	111	2819
36	914	12	305	(Prefix)-30-12-HX*	60	1524	42	1067	84	2134	66	1676	108	2743	90	2286	132	3353	114	2896
		18	457	(Prefix)-30-18-HX*	60	1524	48	1219	84	2134	72	1829	108	2743	96	2438	132	3353	120	3048
		24	609	(Prefix)-30-24-HX*	60	1524	54	1372	84	2134	78	1981	108	2743	102	2591	132	3353	126	3200
		6	152	(Prefix)-36-06-HX*	66	1676	36	914	90	2286	60	1372	114	2896	84	2134	138	3505	108	2743
		9	228	(Prefix)-36-09-HX*	66	1676	39	991	90	2286	63	1600	114	2896	87	2210	138	3505	111	2819
42	1067	12	305	(Prefix)-36-12-HX*	66	1676	42	1067	90	2286	66	1676	114	2896	90	2286	138	3505	114	2896
		18	457	(Prefix)-36-18-HX*	66	1676	48	1219	90	2286	72	1829	114	2896	96	2438	138	3505	120	3048
		24	609	(Prefix)-36-24-HX*	66	1676	54	1372	90	2286	78	1981	114	2896	102	2591	138	3505	126	3200
		30	762	(Prefix)-36-30-HX*	66	1676	60	1524	90	2286	84	2134	114	2896	108	2743	138	3505	132	3353
		6	152	(Prefix)-42-06-HX*	72	1829	36	914	96	2438	60	1372	120	3048	84	2134	144	3658	108	2743
		9	228	(Prefix)-42-09-HX*	72	1829	39	991	96	2438	63	1600	120	3048	87	2210	144	3658	111	2819
		12	305	(Prefix)-42-12-HX*	72	1829	42	1067	96	2438	66	1676	120	3048	90	2286	144	3658	114	2896
48	1219	18	457	(Prefix)-42-18-HX*	72	1829	48	1219	96	2438	72	1829	120	3048	96	2438	144	3658	120	3048
		24	609	(Prefix)-42-24-HX*	72	1829	54	1372	96	2438	78	1981	120	3048	102	2591	144	3658	126	3200
		30	762	(Prefix)-42-30-HX*	72	1829	60	1524	96	2438	84	2134	120	3048	108	2743	144	3658	132	3353
		36	914	(Prefix)-42-36-HX*	72	1829	66	1676	96	2438	90	2286	120	3048	114	2896	144	3658	138	3505

(Prefix) See page 288 for catalog number prefix.

All dimensions in parentheses are millimeters unless otherwise specified.

Width dimensions are to inside wall. For aluminum fittings add 1.5 inches for total outside width.

Manufacturing tolerances apply to all dimensions.

Series 2, 3, 4, & 5 - Fittings

Horizontal Wye (HYL, HYR)

2 pair splice plates with hardware included.

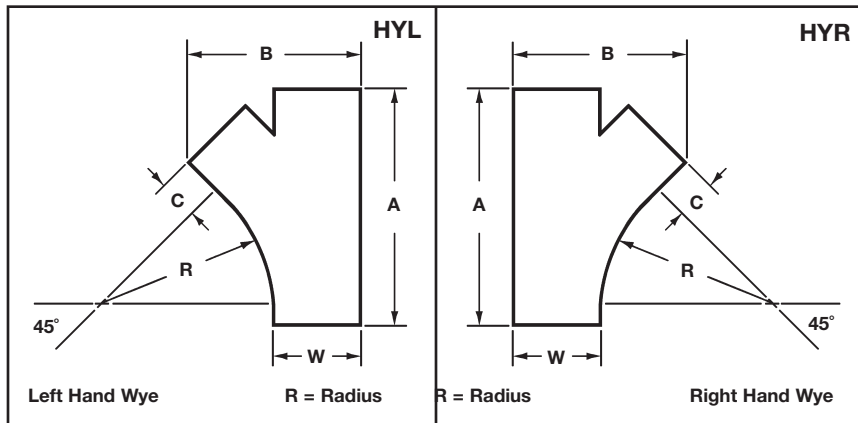
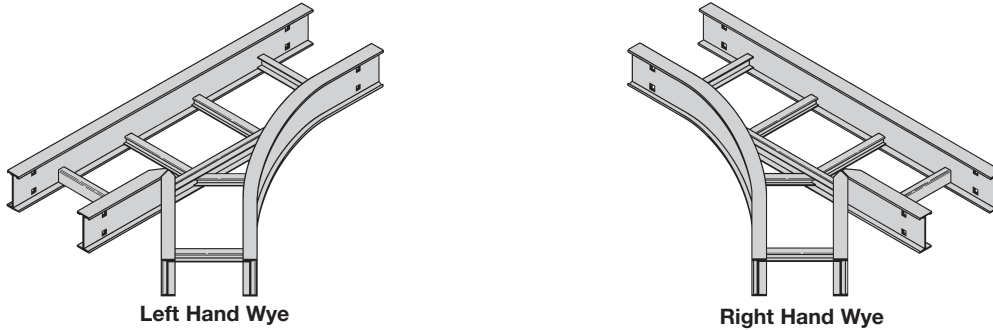

Bend Radius	Tray Width		Left Hand Wye Catalog No.	Right Hand Wye Catalog No.	A		B		C		
	in.	mm			in.	mm	in.	mm	in.	mm	
24	609	6	152	(Prefix)-06-HYL	(Prefix)-06-HYR	28 ⁷ / ₁₆	722	15 ³ / ₁₆	386	3 ¹ / ₁₆	77
		9	228	(Prefix)-09-HYL	(Prefix)-09-HYR	32 ¹¹ / ₁₆	831	20 ⁵ / ₁₆	516	6 ¹ / ₁₆	154
		12	305	(Prefix)-12-HYL	(Prefix)-12-HYR	36 ¹⁵ / ₁₆	938	25 ⁷ / ₁₆	646	9 ¹ / ₁₆	231
		18	457	(Prefix)-18-HYL	(Prefix)-18-HYR	45 ³ / ₈	1153	35 ¹³ / ₁₆	910	15 ¹ / ₁₆	383
		24	609	(Prefix)-24-HYL	(Prefix)-24-HYR	53 ⁷ / ₈	1368	45 ¹⁵ / ₁₆	1167	21 ¹ / ₁₆	535
		30	762	(Prefix)-30-HYL	(Prefix)-30-HYR	62 ³ / ₈	1585	56 ³ / ₁₆	1427	27 ¹ / ₁₆	688
		36	914	(Prefix)-36-HYL	(Prefix)-36-HYR	70 ⁷ / ₈	1800	66 ⁷ / ₁₆	1687	33 ¹ / ₁₆	993
42	1067	(Prefix)-42-HYL	(Prefix)-42-HYR	79 ³ / ₈	2016	76 ⁵ / ₈	1946	39 ¹ / ₁₆	992		

(Prefix) See page 288 for catalog number prefix.

All dimensions in parentheses are millimeters unless otherwise specified.

Width dimensions are to inside wall. For aluminum fittings add 1.5 inches for total outside width. Manufacturing tolerances apply to all dimensions.

Series 2, 3, 4, & 5 - Fittings

Vertical Bend 90° (VO, VI)

1 pair splice plates with hardware included.

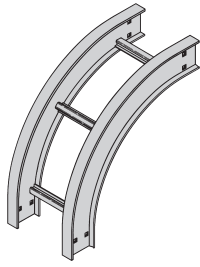

90° Vertical Outside

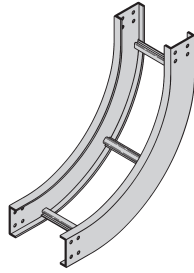

90° Vertical Inside

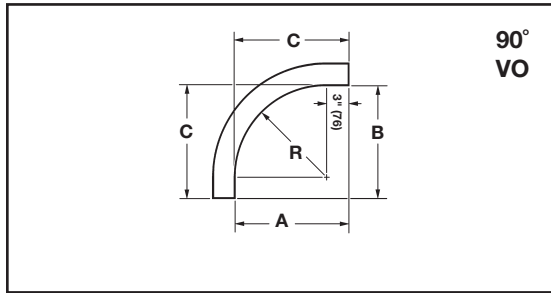

90°
VO

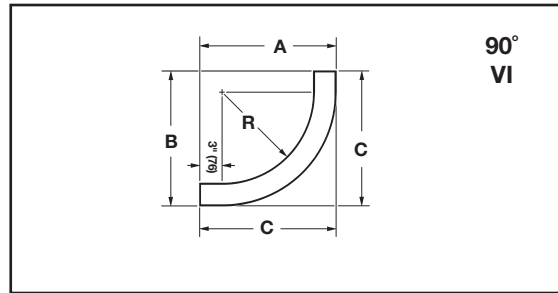

90°
VI

Bend Radius R	Tray Width Insert		(*) Insert "VO" for Vert. Outside Bend "VI" for Vert. Inside Bend Catalog No.	VO Side Rail Height			VI Side Rail Height											
				4" - 7"			4"			5"			6"			7"		
				A	B	C	A	B	C	A	B	C	A	B	C	A	B	C
in.	in.	mm	in.	in.	in.	in.	in.	in.	in.	in.	in.	in.	in.	in.	in.	in.		
12 (305)	6	152	(Prefix)-06-90(*)12 (Prefix)-09-90(*)12 (Prefix)-12-90(*)12 (Prefix)-18-90(*)12 (Prefix)-24-90(*)12 (Prefix)-30-90(*)12 (Prefix)-36-90(*)12 (Prefix)-42-90(*)12															
	9	228		15	15	15	19	19	19	20	20	20	21	21	21	22	22	22
	12	305		(381)	(381)	(381)	(483)	(483)	(483)	(508)	(508)	(508)	(533)	(533)	(533)	(559)	(559)	(559)
	18	457																
	24	609																
	42	1067																
24 (609)	6	152	(Prefix)-06-90(*)24 (Prefix)-09-90(*)24 (Prefix)-12-90(*)24 (Prefix)-18-90(*)24 (Prefix)-24-90(*)24 (Prefix)-30-90(*)24 (Prefix)-36-90(*)24 (Prefix)-42-90(*)24															
	9	228		27	27	27	31	31	31	32	32	32	33	33	33	34	34	34
	12	305		(686)	(686)	(686)	(787)	(787)	(787)	(813)	(813)	(813)	(838)	(838)	(838)	(864)	(864)	(864)
	18	457																
	24	609																
	42	1067																
36 (914)	6	152	(Prefix)-06-90(*)36 (Prefix)-09-90(*)36 (Prefix)-12-90(*)36 (Prefix)-18-90(*)36 (Prefix)-24-90(*)36 (Prefix)-30-90(*)36 (Prefix)-36-90(*)36 (Prefix)-42-90(*)36															
	9	228		39	39	39	43	43	43	44	44	44	45	45	45	46	46	46
	12	305		(991)	(991)	(991)	(1092)	(1092)	(1092)	(1118)	(1118)	(1118)	(1143)	(1143)	(1143)	(1168)	(1168)	(1168)
	18	457																
	24	609																
	42	1067																
48 (1219)	6	152	(Prefix)-06-90(*)48 (Prefix)-09-90(*)48 (Prefix)-12-90(*)48 (Prefix)-18-90(*)48 (Prefix)-24-90(*)48 (Prefix)-30-90(*)48 (Prefix)-36-90(*)48 (Prefix)-42-90(*)48															
	9	228		51	51	51	55	55	55	56	56	56	57	57	57	58	58	58
	12	305		(1295)	(1295)	(1295)	(1397)	(1397)	(1397)	(1422)	(1422)	(1422)	(1448)	(1448)	(1448)	(1473)	(1473)	(1473)
	18	457																
	24	609																
	42	1067																

(Prefix) See page 288 for catalog number prefix.

All dimensions in parentheses are millimeters unless otherwise specified.

Manufacturing tolerances apply to all dimensions.

Series 2, 3, 4, & 5 - Fittings

Vertical Bend 60° (VO, VI)

1 pair splice plates with hardware included.

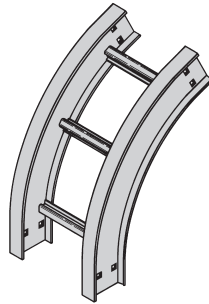

60° Vertical Outside

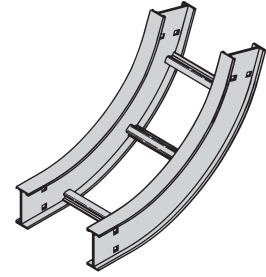

60° Vertical Inside

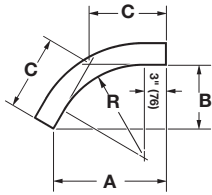

60°
VO

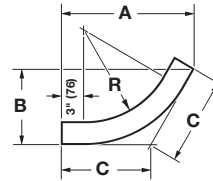

60°
VI

Bend Radius R	Tray Width Insert		(*) Insert "VO" for Vert. Outside Bend "VI" for Vert. Inside Bend Catalog No.	VO Side Rail Height 4" - 7"			VI Side Rail Height												
				A	B	C	4"			5"			6"			7"			
in.	in.	mm		in.	in.	in.	in.	in.	in.	in.	in.	in.	in.	in.	in.	in.	in.	in.	
12 (305)	6	152	(Prefix)-06-60(*)12																
	9	228	(Prefix)-09-60(*)12																
	12	305	(Prefix)-12-60(*)12																
	18	457	(Prefix)-18-60(*)12	147/8	85/8	915/16	183/8	105/8	121/4	191/4	111/8	1213/16	201/16	115/8	133/8	2115/16	121/8	14	(356)
	24	609	(Prefix)-24-60(*)12																
	30	762	(Prefix)-30-60(*)12																
	36	914	(Prefix)-36-60(*)12																
24 (609)	6	152	(Prefix)-06-60(*)24																
	9	228	(Prefix)-09-60(*)24																
	12	305	(Prefix)-12-60(*)24																
	18	457	(Prefix)-18-60(*)24	255/16	145/8	167/8	283/4	165/8	193/16	295/8	171/8	193/4	301/2	175/8	205/16	313/8	181/8	207/8	(530)
	24	609	(Prefix)-24-60(*)24																
	30	762	(Prefix)-30-60(*)24																
	36	914	(Prefix)-36-60(*)24																
36 (914)	6	152	(Prefix)-06-60(*)36																
	9	228	(Prefix)-09-60(*)36																
	12	305	(Prefix)-12-60(*)36																
	18	457	(Prefix)-18-60(*)36	3511/16	205/8	2313/16	391/8	225/8	261/8	40	231/8	2611/16	407/8	235/8	271/4	413/4	241/8	2713/16	(706)
	24	609	(Prefix)-24-60(*)36																
	30	762	(Prefix)-30-60(*)36																
	36	914	(Prefix)-36-60(*)36																
48 (1219)	6	152	(Prefix)-06-60(*)48																
	9	228	(Prefix)-09-60(*)48																
	12	305	(Prefix)-12-60(*)48																
	18	457	(Prefix)-18-60(*)48	461/16	265/8	3011/16	499/16	285/8	33	503/8	291/8	335/8	511/4	295/8	343/16	521/8	301/8	343/4	(883)
	24	609	(Prefix)-24-60(*)48																
	30	762	(Prefix)-30-60(*)48																
	36	914	(Prefix)-36-60(*)48																

(Prefix) See page 288 for catalog number prefix.

All dimensions in parentheses are millimeters unless otherwise specified.

Manufacturing tolerances apply to all dimensions.

Series 2, 3, 4, & 5 - Fittings

Vertical Bend 45° (VO, VI)

1 pair splice plates with hardware included.

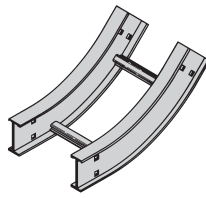
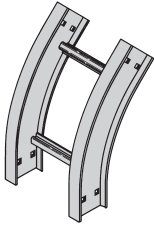

45° Vertical Outside

45° Vertical Inside

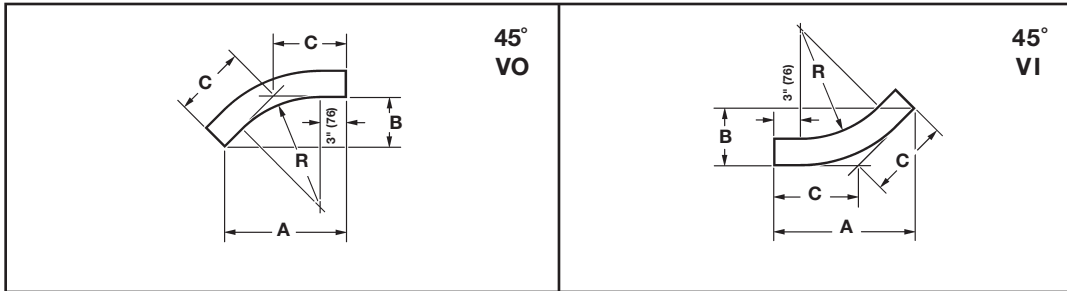

Bend Radius R	Tray Width		(*) Insert "VO" for Vert. Outside Bend Insert "VI" for Vert. Inside Bend Catalog No.	VO Side Rail Height		VI Side Rail Height												
				4" - 7"			4"			5"			6"			7"		
				A	B	C	A	B	C	A	B	C	A	B	C	A	B	C
in.	in.	mm	in.	in.	in.	in.	in.	in.	in.	in.	in.	in.	in.	in.	in.	in.		
12 (305)	6	152	(Prefix)-06-45(*)12															
	9	228	(Prefix)-09-45(*)12															
	12	305	(Prefix)-12-45(*)12															
	18	457	(Prefix)-18-45(*)12	13 ⁵ / ₈	5 ⁵ / ₈	8	16 ⁷ / ₁₆	6 ¹³ / ₁₆	9 ⁵ / ₈	17 ¹ / ₈	7 ¹ / ₈	10 ¹ / ₁₆	17 ⁷ / ₈	7 ³ / ₈	10 ⁷ / ₁₆	18 ⁹ / ₁₆	7 ¹¹ / ₁₆	10 ⁷ / ₈
	24	609	(Prefix)-24-45(*)12	13 ⁵ / ₈	5 ⁵ / ₈	8	16 ⁷ / ₁₆	6 ¹³ / ₁₆	9 ⁵ / ₈	17 ¹ / ₈	7 ¹ / ₈	10 ¹ / ₁₆	17 ⁷ / ₈	7 ³ / ₈	10 ⁷ / ₁₆	18 ⁹ / ₁₆	7 ¹¹ / ₁₆	10 ⁷ / ₈
	30	762	(Prefix)-30-45(*)12	13 ⁵ / ₈	5 ⁵ / ₈	8	16 ⁷ / ₁₆	6 ¹³ / ₁₆	9 ⁵ / ₈	17 ¹ / ₈	7 ¹ / ₈	10 ¹ / ₁₆	17 ⁷ / ₈	7 ³ / ₈	10 ⁷ / ₁₆	18 ⁹ / ₁₆	7 ¹¹ / ₁₆	10 ⁷ / ₈
	36	914	(Prefix)-36-45(*)12	13 ⁵ / ₈	5 ⁵ / ₈	8	16 ⁷ / ₁₆	6 ¹³ / ₁₆	9 ⁵ / ₈	17 ¹ / ₈	7 ¹ / ₈	10 ¹ / ₁₆	17 ⁷ / ₈	7 ³ / ₈	10 ⁷ / ₁₆	18 ⁹ / ₁₆	7 ¹¹ / ₁₆	10 ⁷ / ₈
42	1067	(Prefix)-42-45(*)12	13 ⁵ / ₈	5 ⁵ / ₈	8	16 ⁷ / ₁₆	6 ¹³ / ₁₆	9 ⁵ / ₈	17 ¹ / ₈	7 ¹ / ₈	10 ¹ / ₁₆	17 ⁷ / ₈	7 ³ / ₈	10 ⁷ / ₁₆	18 ⁹ / ₁₆	7 ¹¹ / ₁₆	10 ⁷ / ₈	
24 (609)	6	152	(Prefix)-06-45(*)24															
	9	228	(Prefix)-09-45(*)24															
	12	305	(Prefix)-12-45(*)24															
	18	457	(Prefix)-18-45(*)24	22 ¹ / ₁₆	9 ¹ / ₈	12 ¹⁵ / ₁₆	24 ¹⁵ / ₁₆	10 ⁵ / ₁₆	14 ⁵ / ₈	25 ⁵ / ₈	10 ⁵ / ₈	15	26 ⁵ / ₁₆	10 ¹⁵ / ₁₆	15 ⁷ / ₁₆	27 ¹ / ₁₆	11 ³ / ₁₆	15 ¹³ / ₁₆
	24	609	(Prefix)-24-45(*)24	22 ¹ / ₁₆	9 ¹ / ₈	12 ¹⁵ / ₁₆	24 ¹⁵ / ₁₆	10 ⁵ / ₁₆	14 ⁵ / ₈	25 ⁵ / ₈	10 ⁵ / ₈	15	26 ⁵ / ₁₆	10 ¹⁵ / ₁₆	15 ⁷ / ₁₆	27 ¹ / ₁₆	11 ³ / ₁₆	15 ¹³ / ₁₆
	30	762	(Prefix)-30-45(*)24	22 ¹ / ₁₆	9 ¹ / ₈	12 ¹⁵ / ₁₆	24 ¹⁵ / ₁₆	10 ⁵ / ₁₆	14 ⁵ / ₈	25 ⁵ / ₈	10 ⁵ / ₈	15	26 ⁵ / ₁₆	10 ¹⁵ / ₁₆	15 ⁷ / ₁₆	27 ¹ / ₁₆	11 ³ / ₁₆	15 ¹³ / ₁₆
	36	914	(Prefix)-36-45(*)24	22 ¹ / ₁₆	9 ¹ / ₈	12 ¹⁵ / ₁₆	24 ¹⁵ / ₁₆	10 ⁵ / ₁₆	14 ⁵ / ₈	25 ⁵ / ₈	10 ⁵ / ₈	15	26 ⁵ / ₁₆	10 ¹⁵ / ₁₆	15 ⁷ / ₁₆	27 ¹ / ₁₆	11 ³ / ₁₆	15 ¹³ / ₁₆
42	1067	(Prefix)-42-45(*)24	22 ¹ / ₁₆	9 ¹ / ₈	12 ¹⁵ / ₁₆	24 ¹⁵ / ₁₆	10 ⁵ / ₁₆	14 ⁵ / ₈	25 ⁵ / ₈	10 ⁵ / ₈	15	26 ⁵ / ₁₆	10 ¹⁵ / ₁₆	15 ⁷ / ₁₆	27 ¹ / ₁₆	11 ³ / ₁₆	15 ¹³ / ₁₆	
36 (924)	6	152	(Prefix)-06-45(*)36															
	9	228	(Prefix)-09-45(*)36															
	12	305	(Prefix)-12-45(*)36															
	18	457	(Prefix)-18-45(*)36	30 ⁹ / ₁₆	12 ¹¹ / ₁₆	17 ¹⁵ / ₁₆	33 ³ / ₈	13 ¹³ / ₁₆	19 ⁹ / ₁₆	34 ¹ / ₈	14 ¹ / ₈	20	34 ¹³ / ₁₆	14 ⁷ / ₁₆	20 ⁹ / ₈	35 ¹ / ₂	14 ¹¹ / ₁₆	20 ¹³ / ₁₆
	24	609	(Prefix)-24-45(*)36	30 ⁹ / ₁₆	12 ¹¹ / ₁₆	17 ¹⁵ / ₁₆	33 ³ / ₈	13 ¹³ / ₁₆	19 ⁹ / ₁₆	34 ¹ / ₈	14 ¹ / ₈	20	34 ¹³ / ₁₆	14 ⁷ / ₁₆	20 ⁹ / ₈	35 ¹ / ₂	14 ¹¹ / ₁₆	20 ¹³ / ₁₆
	30	762	(Prefix)-30-45(*)36	30 ⁹ / ₁₆	12 ¹¹ / ₁₆	17 ¹⁵ / ₁₆	33 ³ / ₈	13 ¹³ / ₁₆	19 ⁹ / ₁₆	34 ¹ / ₈	14 ¹ / ₈	20	34 ¹³ / ₁₆	14 ⁷ / ₁₆	20 ⁹ / ₈	35 ¹ / ₂	14 ¹¹ / ₁₆	20 ¹³ / ₁₆
	36	914	(Prefix)-36-45(*)36	30 ⁹ / ₁₆	12 ¹¹ / ₁₆	17 ¹⁵ / ₁₆	33 ³ / ₈	13 ¹³ / ₁₆	19 ⁹ / ₁₆	34 ¹ / ₈	14 ¹ / ₈	20	34 ¹³ / ₁₆	14 ⁷ / ₁₆	20 ⁹ / ₈	35 ¹ / ₂	14 ¹¹ / ₁₆	20 ¹³ / ₁₆
42	1067	(Prefix)-42-45(*)36	30 ⁹ / ₁₆	12 ¹¹ / ₁₆	17 ¹⁵ / ₁₆	33 ³ / ₈	13 ¹³ / ₁₆	19 ⁹ / ₁₆	34 ¹ / ₈	14 ¹ / ₈	20	34 ¹³ / ₁₆	14 ⁷ / ₁₆	20 ⁹ / ₈	35 ¹ / ₂	14 ¹¹ / ₁₆	20 ¹³ / ₁₆	
48 (1219)	6	152	(Prefix)-06-45(*)48															
	9	228	(Prefix)-09-45(*)48															
	12	305	(Prefix)-12-45(*)48															
	18	457	(Prefix)-18-45(*)48	39 ¹ / ₁₆	16 ³ / ₁₆	22 ⁷ / ₈	41 ⁷ / ₈	17 ³ / ₈	24 ⁹ / ₁₆	42 ⁵ / ₈	17 ⁵ / ₈	24 ¹⁵ / ₁₆	43 ⁵ / ₁₆	17 ¹⁵ / ₁₆	25 ³ / ₈	44	18 ¹ / ₄	25 ¹³ / ₁₆
	24	609	(Prefix)-24-45(*)48	39 ¹ / ₁₆	16 ³ / ₁₆	22 ⁷ / ₈	41 ⁷ / ₈	17 ³ / ₈	24 ⁹ / ₁₆	42 ⁵ / ₈	17 ⁵ / ₈	24 ¹⁵ / ₁₆	43 ⁵ / ₁₆	17 ¹⁵ / ₁₆	25 ³ / ₈	44	18 ¹ / ₄	25 ¹³ / ₁₆
	30	762	(Prefix)-30-45(*)48	39 ¹ / ₁₆	16 ³ / ₁₆	22 ⁷ / ₈	41 ⁷ / ₈	17 ³ / ₈	24 ⁹ / ₁₆	42 ⁵ / ₈	17 ⁵ / ₈	24 ¹⁵ / ₁₆	43 ⁵ / ₁₆	17 ¹⁵ / ₁₆	25 ³ / ₈	44	18 ¹ / ₄	25 ¹³ / ₁₆
	36	914	(Prefix)-36-45(*)48	39 ¹ / ₁₆	16 ³ / ₁₆	22 ⁷ / ₈	41 ⁷ / ₈	17 ³ / ₈	24 ⁹ / ₁₆	42 ⁵ / ₈	17 ⁵ / ₈	24 ¹⁵ / ₁₆	43 ⁵ / ₁₆	17 ¹⁵ / ₁₆	25 ³ / ₈	44	18 ¹ / ₄	25 ¹³ / ₁₆
42	1067	(Prefix)-42-45(*)48	39 ¹ / ₁₆	16 ³ / ₁₆	22 ⁷ / ₈	41 ⁷ / ₈	17 ³ / ₈	24 ⁹ / ₁₆	42 ⁵ / ₈	17 ⁵ / ₈	24 ¹⁵ / ₁₆	43 ⁵ / ₁₆	17 ¹⁵ / ₁₆	25 ³ / ₈	44	18 ¹ / ₄	25 ¹³ / ₁₆	

(Prefix) See page 288 for catalog number prefix.

All dimensions in parentheses are millimeters unless otherwise specified.

Manufacturing tolerances apply to all dimensions.

Series 2, 3, 4, & 5 - Fittings

Vertical Bend 30° (VO, VI)

1 pair splice plates with hardware included.

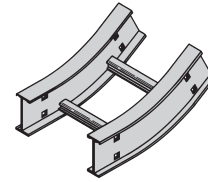
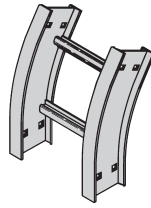

30° Vertical Outside

30° Vertical Inside

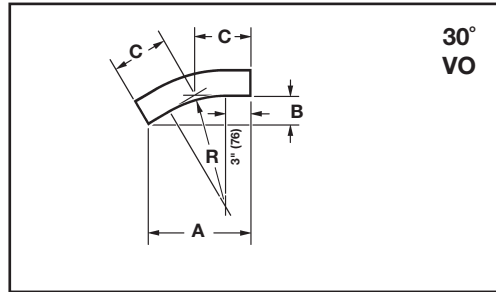

30° VO

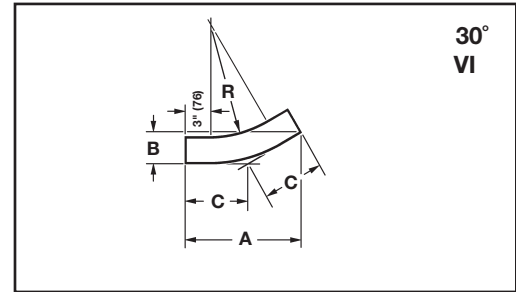

30° VI

Bend Radius R in.	Tray Width in. mm		(*) Insert "VO" for Vert. Outside Bend Insert "VI" for Vert. Inside Bend Catalog No.	VO Side Rail Height 4" - 7"			VI Side Rail Height											
				A in.	B in.	C in.	4"			5"			6"			7"		
							A in.	B in.	C in.	A in.	B in.	C in.	A in.	B in.	C in.	A in.	B in.	C in.
12 (305)	6	152	(Prefix)-06-30(*)12															
	9	228	(Prefix)-09-30(*)12															
	12	305	(Prefix)-12-30(*)12															
	18	457	(Prefix)-18-30(*)12	11 ⁵ / ₈	3 ¹ / ₈	6 ³ / ₁₆	13 ⁵ / ₈	3 ⁵ / ₈	7 ⁵ / ₁₆	14 ¹ / ₈	3 ³ / ₄	7 ⁹ / ₁₆	14 ⁵ / ₈	3 ¹⁵ / ₁₆	7 ¹³ / ₁₆	15 ¹ / ₈	4 ¹ / ₁₆	8 ¹ / ₁₆
	24	609	(Prefix)-24-30(*)12	(296)	(79)	(157)	(346)	(92)	(186)	(359)	(95)	(192)	(372)	(100)	(199)	(384)	(103)	(205)
	30	762	(Prefix)-30-30(*)12															
24 (609)	6	152	(Prefix)-06-30(*)24															
	9	228	(Prefix)-09-30(*)24															
	12	305	(Prefix)-12-30(*)24															
	18	457	(Prefix)-18-30(*)24	17 ⁵ / ₈	4 ¹¹ / ₁₆	9 ⁷ / ₁₆	19 ⁵ / ₈	5 ¹ / ₄	10 ¹ / ₂	20 ¹ / ₈	5 ³ / ₈	10 ³ / ₄	20 ⁵ / ₈	5 ¹ / ₂	11 ¹ / ₁₆	21 ¹ / ₈	5 ⁵ / ₈	11 ⁵ / ₁₆
	24	609	(Prefix)-24-30(*)24	(448)	(120)	(240)	(499)	(133)	(267)	(511)	(137)	(273)	(524)	(140)	(282)	(537)	(143)	(287)
	30	762	(Prefix)-30-30(*)24															
36 (914)	6	152	(Prefix)-06-30(*)36															
	9	228	(Prefix)-09-30(*)36															
	12	305	(Prefix)-12-30(*)36															
	18	457	(Prefix)-18-30(*)36	23 ⁵ / ₈	6 ⁵ / ₁₆	12 ⁵ / ₈	25 ⁵ / ₈	6 ⁷ / ₈	13 ¹¹ / ₁₆	26 ¹ / ₈	7	14	26 ⁵ / ₈	7 ¹ / ₈	14 ¹ / ₄	27 ¹ / ₈	7 ¹ / ₄	14 ¹ / ₂
	24	609	(Prefix)-24-30(*)36	(600)	(160)	(321)	(651)	(174)	(348)	(663)	(175)	(356)	(676)	(181)	(362)	(689)	(184)	(287)
	30	762	(Prefix)-30-30(*)36															
48 (1219)	6	152	(Prefix)-06-30(*)48															
	9	228	(Prefix)-09-30(*)48															
	12	305	(Prefix)-12-30(*)48															
	18	457	(Prefix)-18-30(*)48	29 ⁵ / ₈	7 ¹⁵ / ₁₆	15 ⁷ / ₈	31 ⁵ / ₈	8 ⁷ / ₁₆	16 ¹⁵ / ₁₆	32 ¹ / ₈	8 ⁵ / ₈	17 ⁹ / ₁₆	32 ⁵ / ₈	8 ³ / ₄	17 ¹ / ₂	33 ¹ / ₈	8 ⁷ / ₈	17 ³ / ₄
	24	609	(Prefix)-24-30(*)48	(753)	(202)	(403)	(803)	(214)	(430)	(816)	(219)	(437)	(829)	(222)	(445)	(842)	(226)	(451)
	30	762	(Prefix)-30-30(*)48															

(Prefix) See page 288 for catalog number prefix.

All dimensions in parentheses are millimeters unless otherwise specified.

Manufacturing tolerances apply to all dimensions.

Vertical Tee Up/Down (VTU/VT)

2 pair splice plates with hardware included.

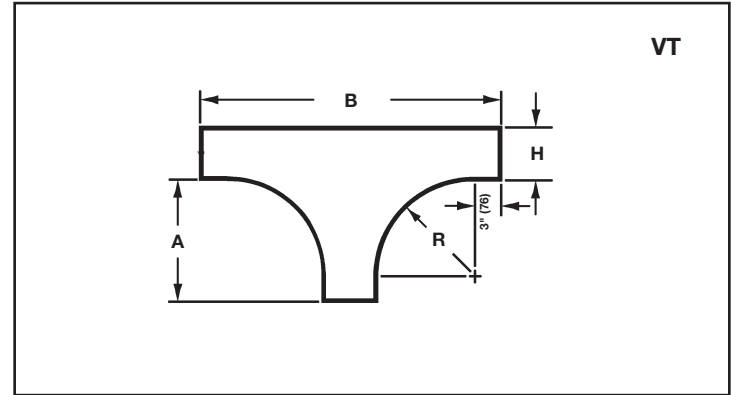
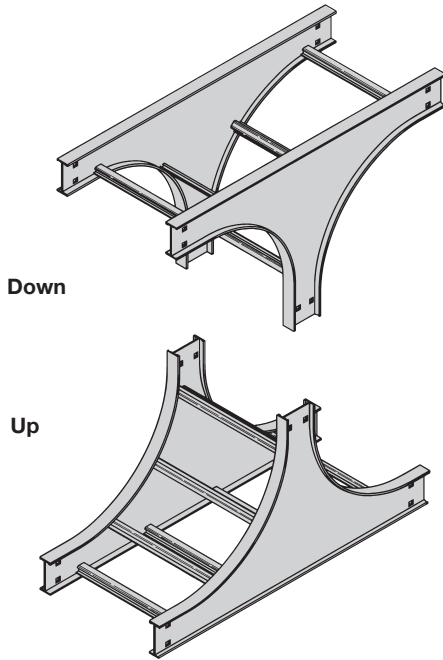

Bend Radius R	Tray Width		Vertical Tee Down Catalog No.	Vertical Tee Up Catalog No.	Side Rail Height "H"							
					4"		5"		6"		7"	
					A	B	A	B	A	B	A	B
12 (305)	6	152	(Prefix)-06-VT12	(Prefix)-06-VTU12	15 (381)	34 (846)	15 (381)	35 (889)	15 (381)	36 (914)	15 (381)	37 (940)
	9	228	(Prefix)-09-VT12	(Prefix)-09-VTU12								
	12	305	(Prefix)-12-VT12	(Prefix)-12-VTU12								
	18	457	(Prefix)-18-VT12	(Prefix)-18-VTU12								
	24	609	(Prefix)-24-VT12	(Prefix)-24-VTU12								
	30	762	(Prefix)-30-VT12	(Prefix)-30-VTU12								
	36	914	(Prefix)-36-VT12	(Prefix)-36-VTU12								
42	1067	(Prefix)-42-VT12	(Prefix)-42-VTU12									
24 (609)	6	152	(Prefix)-06-VT24	(Prefix)-06-VTU24	27 (6867)	58 (1473)	27 (686)	59 (1498)	27 (686)	60 (1524)	27 (686)	61 (1549)
	9	228	(Prefix)-09-VT24	(Prefix)-09-VTU24								
	12	305	(Prefix)-12-VT24	(Prefix)-12-VTU24								
	18	457	(Prefix)-18-VT24	(Prefix)-18-VTU24								
	24	609	(Prefix)-24-VT24	(Prefix)-24-VTU24								
	30	762	(Prefix)-30-VT24	(Prefix)-30-VTU24								
	36	914	(Prefix)-36-VT24	(Prefix)-36-VTU24								
42	1067	(Prefix)-42-VT24	(Prefix)-42-VTU24									
36 (914)	6	152	(Prefix)-06-VT36	(Prefix)-06-VTU36	39 (991)	82 (2083)	39 (991)	83 (2108)	39 (991)	84 (2134)	39 (991)	85 (2159)
	9	228	(Prefix)-09-VT36	(Prefix)-09-VTU36								
	12	305	(Prefix)-12-VT36	(Prefix)-12-VTU36								
	18	457	(Prefix)-18-VT36	(Prefix)-18-VTU36								
	24	609	(Prefix)-24-VT36	(Prefix)-24-VTU36								
	30	762	(Prefix)-30-VT36	(Prefix)-30-VTU36								
	36	914	(Prefix)-36-VT36	(Prefix)-36-VTU36								
42	1067	(Prefix)-42-VT36	(Prefix)-42-VTU36									
48 (1219)	6	152	(Prefix)-06-VT48	(Prefix)-06-VTU48	51 (1295)	106 (2692)	51 (1295)	107 (2718)	51 (1295)	108 (2743)	51 (1295)	109 (2769)
	9	228	(Prefix)-09-VT48	(Prefix)-09-VTU48								
	12	305	(Prefix)-12-VT48	(Prefix)-12-VTU48								
	18	457	(Prefix)-18-VT48	(Prefix)-18-VTU48								
	24	609	(Prefix)-24-VT48	(Prefix)-24-VTU48								
	30	762	(Prefix)-30-VT48	(Prefix)-30-VTU48								
	36	914	(Prefix)-36-VT48	(Prefix)-36-VTU48								
42	1067	(Prefix)-42-VT48	(Prefix)-42-VTU48									

(Prefix) See page 288 for catalog number prefix.

All dimensions in parentheses are millimeters unless otherwise specified.

Manufacturing tolerances apply to all dimensions.

Series 2, 3, 4, & 5 - Fittings

Cable Support Fittings (CSF)

1 pair splice plates with hardware included.

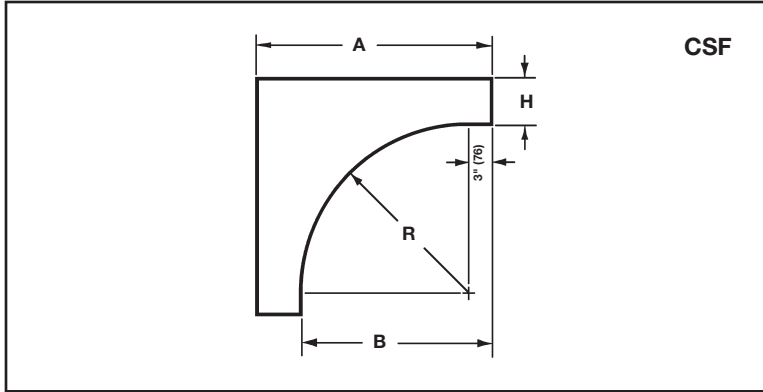
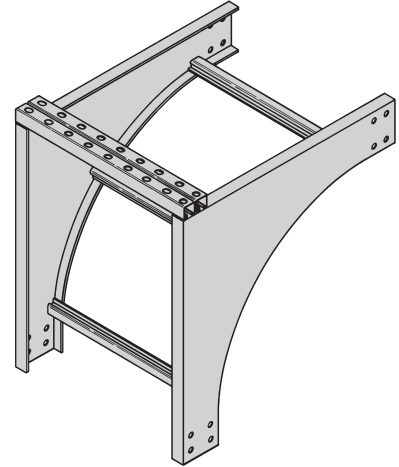

This fitting is recommended for use at the top of vertical runs to support the weight of the cables. The top cross brace is drilled for installing eyebolts, ordered separately.

Bend Radius R in.	Tray Width in. mm		Catalog No.	Side Rail Height "H"							
				4"		5"		6"		7"	
				A in.	B in.	A in.	B in.	A in.	B in.	A in.	B in.
12 (305)	6	152	(Prefix)-06-CSF12	19 (483)	15 (381)	20 (508)	15 (381)	21 (533)	15 (381)	22 (559)	15 (381)
	9	228	(Prefix)-09-CSF12								
	12	305	(Prefix)-12-CSF12								
	18	457	(Prefix)-18-CSF12								
	24	609	(Prefix)-24-CSF12								
	30	762	(Prefix)-30-CSF12								
	36	914	(Prefix)-36-CSF12								
42	1067	(Prefix)-42-CSF12									
24 (609)	6	152	(Prefix)-06-CSF24	31 (787)	27 (686)	32 (813)	27 (686)	33 (838)	27 (686)	34 (864)	27 (686)
	9	228	(Prefix)-09-CSF24								
	12	305	(Prefix)-12-CSF24								
	18	457	(Prefix)-18-CSF24								
	24	609	(Prefix)-24-CSF24								
	30	762	(Prefix)-30-CSF24								
	36	914	(Prefix)-36-CSF24								
42	1067	(Prefix)-42-CSF24									
36 (914)	6	152	(Prefix)-06-CSF36	43 (1092)	39 (991)	44 (1118)	39 (991)	45 (1143)	39 (991)	46 (1168)	39 (991)
	9	228	(Prefix)-09-CSF36								
	12	305	(Prefix)-12-CSF36								
	18	457	(Prefix)-18-CSF36								
	24	609	(Prefix)-24-CSF36								
	30	762	(Prefix)-30-CSF36								
	36	914	(Prefix)-36-CSF36								
42	1067	(Prefix)-42-CSF36									
48 (1219)	6	152	(Prefix)-06-CSF48	55 (1397)	51 (1295)	56 (1422)	51 (1295)	57 (1448)	51 (1295)	58 (1473)	51 (1295)
	9	228	(Prefix)-09-CSF48								
	12	305	(Prefix)-12-CSF48								
	18	457	(Prefix)-18-CSF48								
	24	609	(Prefix)-24-CSF48								
	30	762	(Prefix)-30-CSF48								
	36	914	(Prefix)-36-CSF48								
42	1067	(Prefix)-42-CSF48									

(Prefix) See page 288 for catalog number prefix.

All dimensions in parentheses are millimeters unless otherwise specified.

Manufacturing tolerances apply to all dimensions.

