

Vertical Bends 90° (VO) (VI)

- R - Bend Radius		Tray Width		Catalog No.	90° Mitered							
					Vertical Outside Bend				Vertical Inside Bend			
in.	mm	in.	mm		A		B		A		B	
				in.	mm	in.	mm	in.	mm	in.	mm	
12	305	6	152	(Prefix)-06-90(*)12	20 ⁵ / ₈	524	20 ⁵ / ₈	524	20 ⁵ / ₈	524	20 ⁵ / ₈	524
		9	228	(Prefix)-09-90(*)12								
		12	305	(Prefix)-12-90(*)12								
		18	457	(Prefix)-18-90(*)12								
		24	609	(Prefix)-24-90(*)12								
		30	762	(Prefix)-30-90(*)12								
36	914	(Prefix)-36-90(*)12										
24	609	6	152	(Prefix)-06-90(*)24	28 ³¹ / ₃₂	735	28 ³¹ / ₃₂	735	28 ³¹ / ₃₂	735	28 ³¹ / ₃₂	735
		9	228	(Prefix)-09-90(*)24								
		12	305	(Prefix)-12-90(*)24								
		18	457	(Prefix)-18-90(*)24								
		24	609	(Prefix)-24-90(*)24								
		30	762	(Prefix)-30-90(*)24								
36	914	(Prefix)-36-90(*)24										
36	914	6	152	(Prefix)-06-90(*)36	37 ¹⁵ / ₁₆	963	37 ¹⁵ / ₁₆	963	37 ¹⁵ / ₁₆	963	37 ¹⁵ / ₁₆	963
		9	228	(Prefix)-09-90(*)36								
		12	305	(Prefix)-12-90(*)36								
		18	457	(Prefix)-18-90(*)36								
		24	609	(Prefix)-24-90(*)36								
		30	762	(Prefix)-30-90(*)36								
36	914	(Prefix)-36-90(*)36										

(*) Insert 'VO' for Vertical Outside Bend or 'VI' for Vertical Inside Bend.

Vertical Bends 45° (VO) (VI)

Vertical Outside Bend

VO

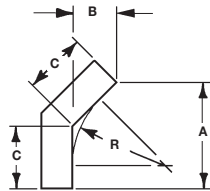
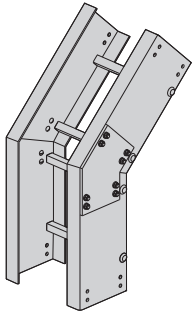

45° (VO) Mitered

Vertical Inside Bend

VI

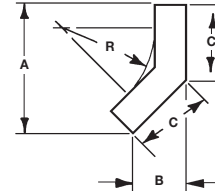
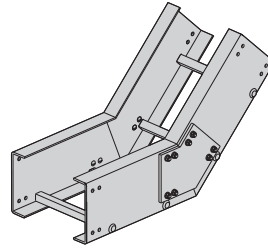

45° (VI) Mitered

One pair of splice plates with SS6 hardware included.

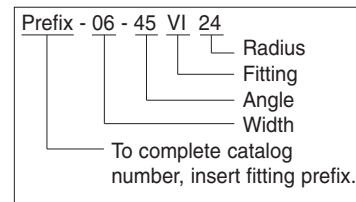
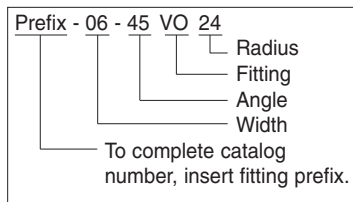

(Prefix) See page 330 for catalog number prefix.
Dimensions for reference only, when critical contact factory.

For 3" Fittings

(Radius 12" only • Tray widths - 6" thru 24")
Polyester, Vinyl Ester, Zero Halogen/Dis-Stat
All are mitered

For 6" Fittings

(Radius 12", 24" & 36"
Tray widths - 6" thru 36")
Polyester, Vinyl Ester, Zero Halogen/Dis-Stat
All radius are mitered

For 4" Fittings

(Radius 12", 24" & 36"
Tray widths - 6" thru 36")
Polyester, Vinyl Ester, Zero Halogen/Dis-Stat
All radius are mitered

For 8" Fittings

(Radius 12", 24" & 36"
Tray widths - 6" thru 36")
Polyester, Vinyl Ester, Zero Halogen/Dis-Stat
All radius are mitered

Vertical Bends 45° (VO) (VI)

- R - Bend Radius		Tray Width		Catalog No.	45° Mitered											
					Vertical Outside Bend						Vertical Inside Bend					
					A		B		C		A		B		C	
in.	mm	in.	mm	in.	mm	in.	mm	in.	mm	in.	mm	in.	mm	in.	mm	
12	305	6	152	(Prefix)-06-45(*)12	20½	521	8½	216	12	305	26 ⁵ / ₃₂	664	10 ²⁷ / ₃₂	275	15 ⁵ / ₁₆	389
		9	228	(Prefix)-09-45(*)12												
		12	305	(Prefix)-12-45(*)12												
		18	457	(Prefix)-18-45(*)12												
		24	609	(Prefix)-24-45(*)12												
		30	762	(Prefix)-30-45(*)12												
		36	914	(Prefix)-36-45(*)12												
24	609	6	152	(Prefix)-06-45(*)24	28 ³¹ / ₃₂	736	12	305	16 ³¹ / ₃₂	431	36 ¹ / ₁₆	916	14 ¹⁵ / ₁₆	379	21 ¹ / ₈	537
		9	228	(Prefix)-09-45(*)24												
		12	305	(Prefix)-12-45(*)24												
		18	457	(Prefix)-18-45(*)24												
		24	609	(Prefix)-24-45(*)24												
		30	762	(Prefix)-30-45(*)24												
		36	914	(Prefix)-36-45(*)24												
36	914	6	152	(Prefix)-06-45(*)36	37 ⁷ / ₁₆	951	15½	394	21 ¹⁵ / ₁₆	557	46	1168	19½	483	26 ¹⁵ / ₁₆	684
		9	228	(Prefix)-09-45(*)36												
		12	305	(Prefix)-12-45(*)36												
		18	457	(Prefix)-18-45(*)36												
		24	609	(Prefix)-24-45(*)36												
		30	762	(Prefix)-30-45(*)36												
		36	914	(Prefix)-36-45(*)36												

(*) Insert 'VO' for Vertical Outside Bend or 'VI' for Vertical Inside Bend.
60° and 30° vertical bends available in mitered construction.

Fiberglass