

Channel Cable Tray - Fittings

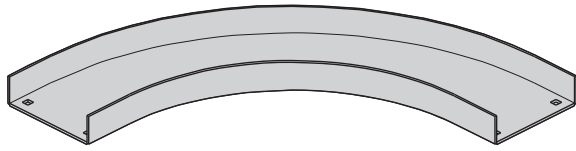

ACCN-04-90HB12
Non-Ventilated Horizontal Bend

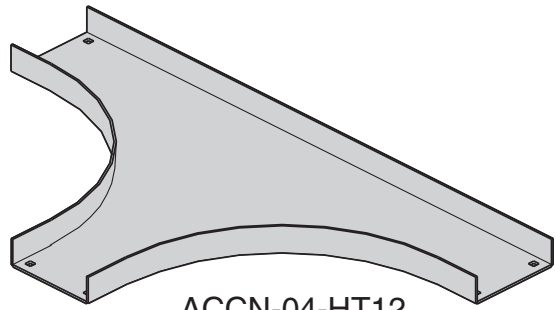

ACCN-04-HT12
Non-Ventilated Tee

Fittings engineered with 3" tangents for splicing integrity.

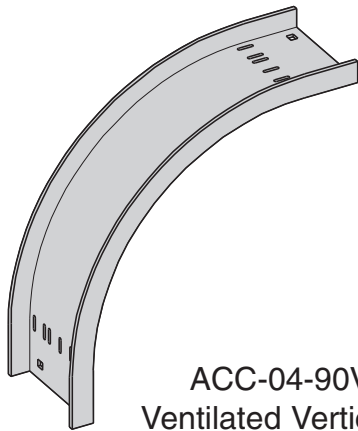

ACC-04-90VO12
Ventilated Vertical Bend

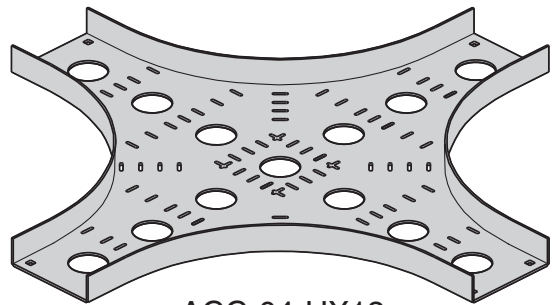

ACC-04-HX12
Ventilated Horizontal Cross

Fittings Part Numbering

Prefix
Example: **A CCN - 04 - 90 HB 24**

Material	Tray Type	Width	Angle	Fitting Type	Radius
<ul style="list-style-type: none"> ● A = Aluminum ● G = Type 1 HDGAF ● SS4 = 304 Stainless Steel ● SS6 = 316 Stainless Steel P = † 	<ul style="list-style-type: none"> ● *CC = Ventilated Cable Channel ● CCN = Non-ventilated Cable Channel 	<ul style="list-style-type: none"> ● 03 = 3" ● 04 = 4" ● 06 = 6" 	<ul style="list-style-type: none"> ● 30 = 30° ● 45 = 45° ● 60 = 60° ● 90 = 90° 	<ul style="list-style-type: none"> HB = Horizontal Bend HT = Horizontal Tee HX = Horizontal Cross VI = Vertical Inside Bend VO = Vertical Outside Bend 	<ul style="list-style-type: none"> ● 12 = 12" ● 24 = 24" ● 36 = 36" ● 48 = 48"

* Ventilated Cable Channel Fittings are available only in 12" and 24" radii.
 † - Due to multiple piece welded construction, P fittings are not available - substitute G.

All items normal lead time except for those indicated

● Green = Fastest shipped items ● Black = Normal lead-time items ● Red = Normally long lead-time items

Channel Cable Tray - Fittings

Horizontal Bends 90°, 60° (HB)

1 splice plate with hardware included.

Bend Radius R	Tray Width		90° Horizontal Bend Dimensions									
			Catalog No.	A		B		C				
in. mm	in. mm	in. mm		in. mm	in. mm	in. mm	in. mm	in. mm	in. mm			
12	305	3 76	(Pre)-03-90HB12	16½ 419	16½ 419	16½ 419	16½ 419	16½ 419	16½ 419			
		4 101	(Pre)-04-90HB12	17 432	17 432	17 432	17 432	17 432	17 432			
		6 152	(Pre)-06-90HB12	18 457	18 457	18 457	18 457	18 457	18 457			
24	609	3 76	(Pre)-03-90HB24	28½ 723	28½ 723	28½ 723	28½ 723	28½ 723	28½ 723			
		4 101	(Pre)-04-90HB24	29 737	29 737	29 737	29 737	29 737	29 737			
		6 152	(Pre)-06-90HB24	30 762	30 762	30 762	30 762	30 762	30 762			
36	915	3 76	(Pre)-03-90HB36	40½ 1029	40½ 1029	40½ 1029	40½ 1029	40½ 1029	40½ 1029			
		4 101	(Pre)-04-90HB36	41 1041	41 1041	41 1041	41 1041	41 1041	41 1041			
		6 152	(Pre)-06-90HB36	42 1067	42 1067	42 1067	42 1067	42 1067	42 1067			
48	1218	3 76	(Pre)-03-90HB48	52½ 1334	52½ 1334	52½ 1334	52½ 1334	52½ 1334	52½ 1334			
		4 101	(Pre)-04-90HB48	53 1346	53 1346	53 1346	53 1346	53 1346	53 1346			
		6 152	(Pre)-06-90HB48	54 1372	54 1372	54 1372	54 1372	54 1372	54 1372			
60° Horizontal Bend												
12	305	3 76	(Pre)-03-60HB12	16¼ 412	9¾ 239	10¾ 273	16¾ 422	9¾ 245	11½ 283	17½ 445	10 254	11¾ 296
		4 101	(Pre)-04-60HB12	16¾ 422	9¾ 245	11½ 283	17½ 445	10 254	11¾ 296	26¾ 819	15¾ 391	17¾ 451
		6 152	(Pre)-06-60HB12	17½ 445	10 254	11¾ 296	26¾ 819	15¾ 391	17¾ 451	27¾ 819	16 406	18¾ 466
24	609	3 76	(Pre)-03-60HB24	26¾ 819	15¾ 391	17¾ 451	27¾ 819	16 406	18¾ 466	37 940	21¾ 543	24½ 625
		4 101	(Pre)-04-60HB24	27 686	15¾ 391	18 450	37¾ 949	21¾ 549	25 635	38¼ 972	22 559	25½ 648
		6 152	(Pre)-06-60HB24	27¾ 819	16 406	18¾ 466	37¾ 949	21¾ 549	25 635	38¼ 972	22 559	25½ 648
36	915	3 76	(Pre)-03-60HB36	37 940	21¾ 543	24½ 625	47¾ 1203	27¾ 695	31½ 803	47¾ 1203	27¾ 695	31½ 803
		4 101	(Pre)-04-60HB36	37¾ 949	21¾ 549	25 635	47¾ 1203	27¾ 695	31½ 803	47¾ 1203	27¾ 695	31½ 803
		6 152	(Pre)-06-60HB36	38¼ 972	22 559	25½ 648	47¾ 1203	27¾ 695	31½ 803	48½ 1235	28 711	32½ 826
48	1218	3 76	(Pre)-03-60HB48	47¾ 1203	27¾ 695	31½ 803	47¾ 1203	27¾ 695	31½ 803	47¾ 1203	27¾ 695	31½ 803
		4 101	(Pre)-04-60HB48	47¾ 1203	27¾ 695	31½ 803	47¾ 1203	27¾ 695	31½ 803	47¾ 1203	27¾ 695	31½ 803
		6 152	(Pre)-06-60HB48	48½ 1235	28 711	32½ 826	48½ 1235	28 711	32½ 826	48½ 1235	28 711	32½ 826

All dimensions in shaded areas are millimeters unless otherwise specified.
(Pre) See page 105 for catalog number prefix.

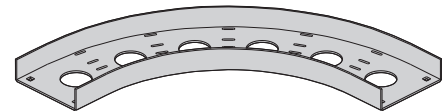

90° Horizontal Bend
Ventilated Horizontal Bend

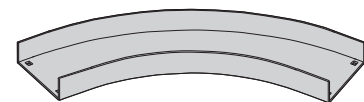
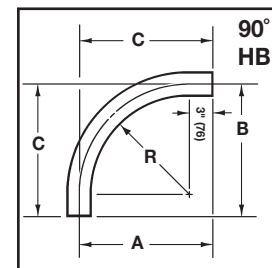

60° Horizontal Bend
Non-Ventilated Horizontal Bend

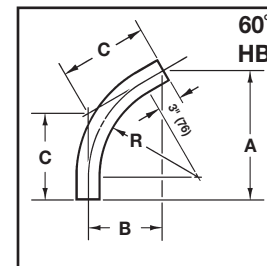

Channel Cable Tray - Fittings

Horizontal Bends 45°, 30° (HB)

1 splice plate with hardware included.



45° Horizontal Bend
Ventilated Horizontal Bend

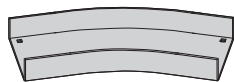
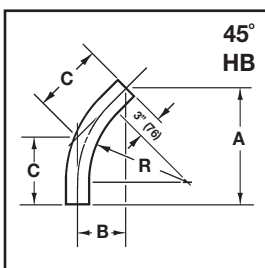

30° Horizontal Bend
Non-Ventilated Horizontal Bend

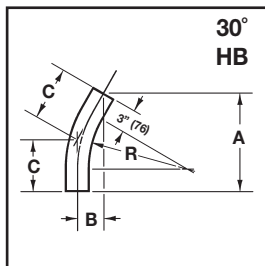

Bend Radius R	Tray Width		45° Horizontal Bend							
			Dimensions							
			Catalog No.		A		B		C	
in.	mm	in.	mm	in.	mm	in.	mm	in.	mm	
12	305	3	76	(Pre)-03-45HB12	14 ⁵ / ₈	371	6 ¹ / ₈	156	8 ⁵ / ₈	219
		4	101	(Pre)-04-45HB12	15	381	6 ¹ / ₄	159	8 ⁷ / ₈	225
		6	152	(Pre)-06-45HB12	15 ³ / ₄	400	6 ¹ / ₂	165	9 ¹ / ₄	235
24	609	3	76	(Pre)-03-45HB24	23 ¹ / ₈	587	9 ⁵ / ₈	244	13 ⁵ / ₈	346
		4	101	(Pre)-04-45HB24	23 ¹ / ₂	597	9 ³ / ₄	248	13 ³ / ₄	249
		6	152	(Pre)-06-45HB24	24 ¹ / ₈	613	10	254	14 ¹ / ₈	359
36	915	3	76	(Pre)-03-45HB36	31 ⁵ / ₈	803	13 ¹ / ₈	334	18 ⁵ / ₈	473
		4	101	(Pre)-04-45HB36	32	813	13 ¹ / ₄	337	18 ³ / ₄	476
		6	152	(Pre)-06-45HB36	32 ³ / ₄	832	13 ¹ / ₂	343	19 ¹ / ₈	486
48	1218	3	76	(Pre)-03-45HB48	40 ¹ / ₈	1019	16 ⁵ / ₈	422	23 ¹ / ₂	597
		4	101	(Pre)-04-45HB48	40 ¹ / ₂	1029	16 ³ / ₄	425	23 ³ / ₄	603
		6	152	(Pre)-06-45HB48	41 ¹ / ₈	1045	17	432	24 ¹ / ₈	613
30° Horizontal Bend										
12	305	3	76	(Pre)-03-30HB12	12 ³ / ₈	314	3 ¹ / ₄	83	6 ⁵ / ₈	168
		4	101	(Pre)-04-30HB12	12 ⁵ / ₈	321	3 ³ / ₈	86	6 ³ / ₄	171
		6	152	(Pre)-06-30HB12	13 ¹ / ₈	334	3 ¹ / ₂	89	7	178
24	609	3	76	(Pre)-03-30HB24	18 ³ / ₈	467	4 ⁷ / ₈	124	9 ⁷ / ₈	251
		4	101	(Pre)-04-30HB24	18 ⁵ / ₈	473	5	127	10	254
		6	152	(Pre)-06-30HB24	19 ¹ / ₈	486	5 ¹ / ₈	130	10 ¹ / ₄	260
36	915	3	76	(Pre)-03-30HB36	24 ³ / ₈	619	6 ¹ / ₂	165	13	330
		4	101	(Pre)-04-30HB36	24 ⁵ / ₈	626	6 ⁵ / ₈	168	13 ¹ / ₈	334
		6	152	(Pre)-06-30HB36	25 ¹ / ₈	638	6 ³ / ₄	171	13 ¹ / ₂	343
48	1218	3	76	(Pre)-03-30HB48	30 ³ / ₈	772	8 ¹ / ₈	207	16 ¹ / ₄	413
		4	101	(Pre)-04-30HB48	30 ⁵ / ₈	778	8 ¹ / ₄	210	16 ³ / ₈	416
		6	152	(Pre)-06-30HB48	31 ¹ / ₈	791	8 ³ / ₈	213	16 ⁵ / ₈	422

All dimensions in shaded areas are millimeters unless otherwise specified.
(Pre) See page 105 for catalog number prefix.

Channel Cable Tray - Fittings

Horizontal Tee (HT)

2 splice plates with hardware included.

Bend Radius R	Tray Width		Horizontal Tee Dimensions					
			Catalog No.	A		B		
				in.	mm	in.	mm	
12	305	3	76	(Pre)-03-HT12	16½	419	33	838
		4	101	(Pre)-04-HT12	17	432	34	864
		6	152	(Pre)-06-HT12	18	457	36	914
24	609	3	76	(Pre)-03-HT24	28½	723	57	1448
		4	101	(Pre)-04-HT24	29	737	58	1473
		6	152	(Pre)-06-HT24	30	762	60	1524
36	915	3	76	(Pre)-03-HT36	40½	1029	81	2057
		4	101	(Pre)-04-HT36	41	1041	82	2083
		6	152	(Pre)-06-HT36	42	1067	84	2134
48	1218	3	76	(Pre)-03-HT48	52½	1334	105	2667
		4	101	(Pre)-04-HT48	53	1346	106	2692
		6	152	(Pre)-06-HT48	54	1372	108	2743

All dimensions in shaded areas are millimeters unless otherwise specified.
(Pre) See page 105 for catalog number prefix.

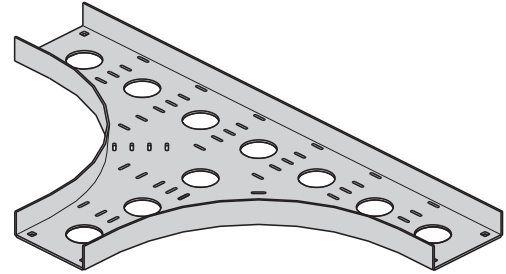

Horizontal Tee
Ventilated Horizontal Tee

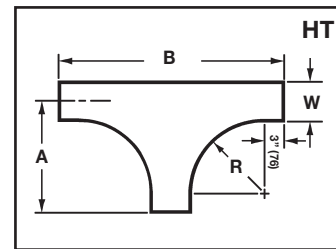

Horizontal Cross (HX)

3 splice plates with hardware included.

Bend Radius R	Tray Width		Horizontal Cross Dimensions					
			Catalog No.	A		B		
				in.	mm	in.	mm	
12	305	3	76	(Pre)-03-HX12	16½	419	33	838
		4	101	(Pre)-04-HX12	17	432	34	864
		6	152	(Pre)-06-HX12	18	457	36	914
24	609	3	76	(Pre)-03-HX24	28½	723	57	1448
		4	101	(Pre)-04-HX24	29	737	58	1473
		6	152	(Pre)-06-HX24	30	762	60	1524
36	915	3	76	(Pre)-03-HX36	40½	1029	81	2057
		4	101	(Pre)-04-HX36	41	1041	82	2083
		6	152	(Pre)-06-HX36	42	1067	84	2134
48	1218	3	76	(Pre)-03-HX48	52½	1334	105	2667
		4	101	(Pre)-04-HX48	53	1346	106	2692
		6	152	(Pre)-06-HX48	54	1372	108	2743

All dimensions in shaded areas are millimeters unless otherwise specified.
(Pre) See page 105 for catalog number prefix.

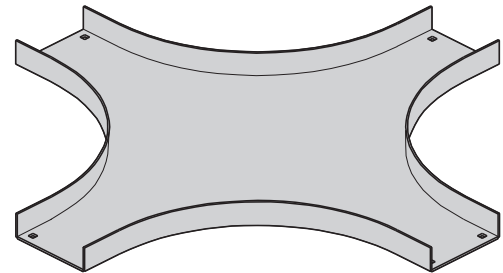

Horizontal Cross
Non-Ventilated Horizontal Cross

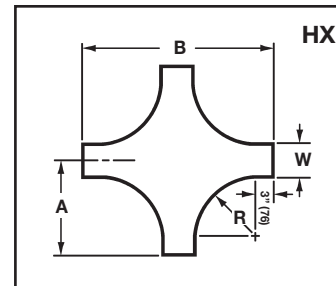

Channel Cable Tray - Fittings

Vertical Outside Bends 90°, 60° (VO)

1 splice plate with hardware included.

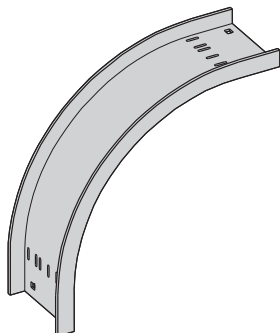

90° Vertical Outside Bend
Ventilated Vertical Outside Bend

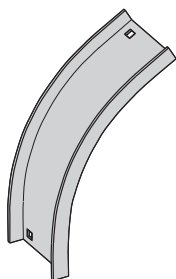
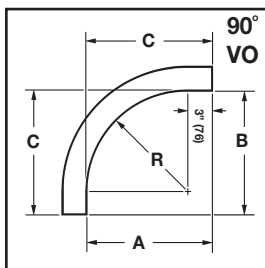

60° Vertical Outside Bend
Non-Ventilated Vertical Outside Bend

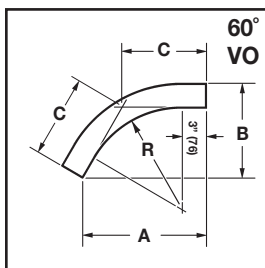

Bend Radius R	Tray Width		90° Vertical Outside Bend Dimensions							
			Catalog No.		A		B		C	
in.	mm	in.	mm		in.	mm	in.	mm	in.	mm
12	305	3	76	(Pre)-03-90VO12	15	381	15	381	15	381
		4	101	(Pre)-04-90VO12						
		6	152	(Pre)-06-90VO12						
24	609	3	76	(Pre)-03-90VO24	27	686	27	686	27	686
		4	101	(Pre)-04-90VO24						
		6	152	(Pre)-06-90VO24						
36	915	3	76	(Pre)-03-90VO36	39	991	39	991	39	991
		4	101	(Pre)-04-90VO36						
		6	152	(Pre)-06-90VO36						
48	1218	3	76	(Pre)-03-90VO48	51	1295	51	1295	51	1295
		4	101	(Pre)-04-90VO48						
		6	152	(Pre)-06-90VO48						
60° Vertical Outside Bend										
12	305	3	76	(Pre)-03-60VO12	14 ⁷ / ₈	378	8 ¹ / ₂	216	9 ⁷ / ₈	251
		4	101	(Pre)-04-60VO12						
		6	152	(Pre)-06-60VO12						
24	609	3	76	(Pre)-03-60VO24	25 ³ / ₈	645	14 ⁵ / ₈	372	16 ⁷ / ₈	428
		4	101	(Pre)-04-60VO24						
		6	152	(Pre)-06-60VO24						
36	915	3	76	(Pre)-03-60VO36	35 ⁵ / ₈	905	20 ⁵ / ₈	524	23 ³ / ₄	603
		4	101	(Pre)-04-60VO36						
		6	152	(Pre)-06-60VO36						
48	1218	3	76	(Pre)-03-60VO48	46 ¹ / ₈	1172	26 ⁵ / ₈	676	30 ³ / ₄	781
		4	101	(Pre)-04-60VO48						
		6	152	(Pre)-06-60VO48						

All dimensions in shaded areas are millimeters unless otherwise specified.

(Pre) See page 105 for catalog number prefix.

Channel Cable Tray - Fittings

Vertical Outside Bends 45°, 30° (VO)

1 splice plate with hardware included.

Bend Radius R	Tray Width	45° Vertical Outside Bend Dimensions							
		Catalog No.	A		B		C		
in. mm	in. mm		in. mm	in. mm	in. mm	in. mm	in. mm		
12 305	3 76	(Pre)-03-45VO12	13 ⁵ / ₈ 346	5 ⁵ / ₈ 143	8	203			
	4 101	(Pre)-04-45VO12							
	6 152	(Pre)-06-45VO12							
24 609	3 76	(Pre)-03-45VO24	22 ¹ / ₄ 565	9 ¹ / ₄ 235	13	330			
	4 101	(Pre)-04-45VO24							
	6 152	(Pre)-06-45VO24							
36 915	3 76	(Pre)-03-45VO36	30 ¹ / ₂ 775	12 ⁵ / ₈ 321	17 ⁷ / ₈	454			
	4 101	(Pre)-04-45VO36							
	6 152	(Pre)-06-45VO36							
48 1218	3 76	(Pre)-03-45VO48	39 991	16 ¹ / ₈ 410	22 ⁷ / ₈	581			
	4 101	(Pre)-04-45VO48							
	6 152	(Pre)-06-45VO48							
30° Vertical Outside Bend									
12 305	3 76	(Pre)-03-30VO12	11 ⁵ / ₈ 296	3 ¹ / ₈ 79	6 ¹ / ₄	158			
	4 101	(Pre)-04-30VO12							
	6 152	(Pre)-06-30VO12							
24 609	3 76	(Pre)-03-30VO24	17 ¹ / ₂ 445	4 ⁷ / ₈ 124	9 ³ / ₈	238			
	4 101	(Pre)-04-30VO24							
	6 152	(Pre)-06-30VO24							
36 915	3 76	(Pre)-03-30VO36	23 ¹ / ₂ 597	6 ³ / ₈ 162	12 ⁵ / ₈	321			
	4 101	(Pre)-04-30VO36							
	6 152	(Pre)-06-30VO36							
48 1218	3 76	(Pre)-03-30VO48	29 ⁵ / ₈ 753	8 203	15 ⁷ / ₈	403			
	4 101	(Pre)-04-30VO48							
	6 152	(Pre)-06-30VO48							

All dimensions in shaded areas are millimeters unless otherwise specified.
(Pre) See page 105 for catalog number prefix.

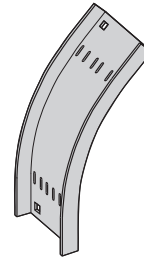

45° Vertical Outside Bend
Ventilated Vertical Outside Bend

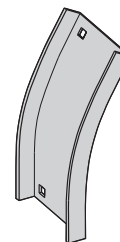
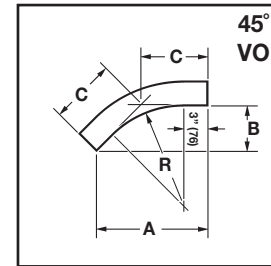

30° Vertical Outside Bend
Non-Ventilated Vertical Outside Bend

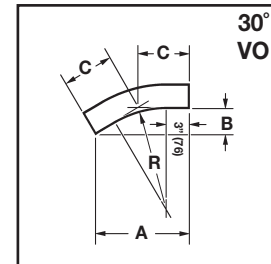

Channel Cable Tray - Fittings

Vertical Inside Bends 90°, 60° (VI)

1 splice plate with hardware included.

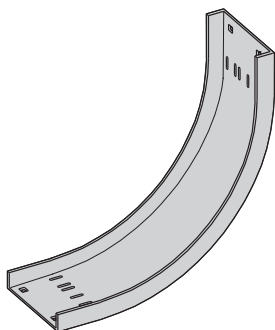

90° Vertical Inside Bend
Ventilated Vertical Inside Bend

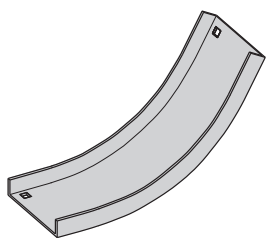
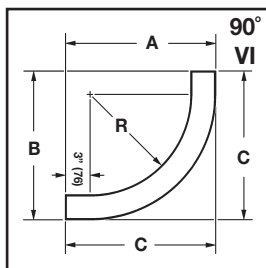

60° Vertical Inside Bend
Non-Ventilated Vertical Inside Bend

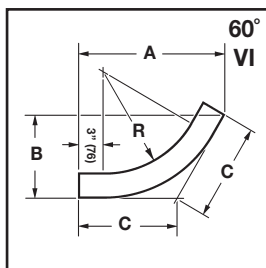

Bend Radius R	Tray Width		90° Vertical Inside Bend Dimensions								
			Catalog No.		A		B		C		
in.	mm	in.	mm	in.		mm		in.		mm	
12	305	3	76	(Pre)-03-90VI12		16 ¹ / ₄	413	16 ¹ / ₄	413	16 ¹ / ₄	413
		4	101	(Pre)-04-90VI12		16 ³ / ₄	425	16 ³ / ₄	425	16 ³ / ₄	425
		6	152	(Pre)-06-90VI12		16 ³ / ₄	425	16 ³ / ₄	425	16 ³ / ₄	425
24	609	3	76	(Pre)-03-90VI24		28 ¹ / ₄	718	28 ¹ / ₄	718	28 ¹ / ₄	718
		4	101	(Pre)-04-90VI24		28 ³ / ₄	730	28 ³ / ₄	730	28 ³ / ₄	730
		6	152	(Pre)-06-90VI24		28 ³ / ₄	730	28 ³ / ₄	730	28 ³ / ₄	730
36	915	3	76	(Pre)-03-90VI36		40 ¹ / ₄	1024	40 ¹ / ₄	1024	40 ¹ / ₄	1024
		4	101	(Pre)-04-90VI36		40 ³ / ₄	1035	40 ³ / ₄	1035	40 ³ / ₄	1035
		6	152	(Pre)-06-90VI36		40 ³ / ₄	1035	40 ³ / ₄	1035	40 ³ / ₄	1035
48	1218	3	76	(Pre)-03-90VI48		52 ¹ / ₄	1327	52 ¹ / ₄	1327	52 ¹ / ₄	1327
		4	101	(Pre)-04-90VI48		52 ³ / ₄	1340	52 ³ / ₄	1340	52 ³ / ₄	1340
		6	152	(Pre)-06-90VI48		52 ³ / ₄	1340	52 ³ / ₄	1340	52 ³ / ₄	1340
60° Vertical Inside Bend											
12	305	3	76	(Pre)-03-60VI12		16	406	9 ¹ / ₄	235	10 ⁵ / ₈	270
		4	101	(Pre)-04-60VI12		16 ¹ / ₂	419	9 ¹ / ₂	241	11	280
		6	152	(Pre)-06-60VI12		16 ¹ / ₂	419	9 ¹ / ₂	241	11	280
24	609	3	76	(Pre)-03-60VI24		26 ¹ / ₂	673	15 ¹ / ₄	387	17 ⁵ / ₈	448
		4	101	(Pre)-04-60VI24		26 ⁷ / ₈	683	15 ¹ / ₂	394	17 ⁷ / ₈	454
		6	152	(Pre)-06-60VI24		26 ⁷ / ₈	683	15 ¹ / ₂	394	17 ⁷ / ₈	454
36	915	3	76	(Pre)-03-60VI36		36 ³ / ₄	933	21 ¹ / ₄	540	24 ¹ / ₂	622
		4	101	(Pre)-04-60VI36		37 ¹ / ₈	943	21 ³ / ₈	543	24 ³ / ₄	629
		6	152	(Pre)-06-60VI36		37 ¹ / ₈	943	21 ³ / ₈	543	24 ³ / ₄	629
48	1218	3	76	(Pre)-03-60VI48		47 ¹ / ₈	1197	27 ¹ / ₈	689	31 ³ / ₈	797
		4	101	(Pre)-04-60VI48		47 ⁵ / ₈	1210	27 ¹ / ₂	699	31 ³ / ₄	806
		6	152	(Pre)-06-60VI48		47 ⁵ / ₈	1210	27 ¹ / ₂	699	31 ³ / ₄	806

All dimensions in shaded areas are millimeters unless otherwise specified.
(Pre) See page 105 for catalog number prefix.

Channel Cable Tray - Fittings

Vertical Inside Bends 45°, 30° (VI)

1 splice plate with hardware included.

Bend Radius R	Tray Width	45° Vertical Inside Bend Dimensions							
		Catalog No.		A		B		C	
in. mm	in. mm		in. mm	in. mm	in. mm	in. mm	in. mm		
12 305	3 76	(Pre)-03-45VI12	14 ¹ / ₂ 368	6 152	8 ¹ / ₂ 216				
	4 101	(Pre)-04-45VI12	14 ⁷ / ₈ 373	6 ¹ / ₈ 156	8 ³ / ₄ 222				
	6 152	(Pre)-06-45VI12	14 ⁷ / ₈ 378	6 ¹ / ₈ 156	8 ³ / ₄ 222				
24 609	3 76	(Pre)-03-45VI24	23 584	9 ¹ / ₂ 241	13 ¹ / ₂ 343				
	4 101	(Pre)-04-45VI24	23 ¹ / ₄ 591	9 ⁵ / ₈ 245	13 ⁵ / ₈ 346				
	6 152	(Pre)-06-45VI24	23 ¹ / ₄ 591	9 ⁵ / ₈ 245	13 ⁵ / ₈ 346				
36 915	3 76	(Pre)-03-45VI36	31 ³ / ₈ 797	13 330	18 ³ / ₈ 467				
	4 101	(Pre)-04-45VI36	31 ³ / ₄ 806	13 ¹ / ₈ 330	18 ⁵ / ₈ 467				
	6 152	(Pre)-06-45VI36	31 ³ / ₄ 806	13 ¹ / ₈ 334	18 ⁵ / ₈ 473				
48 1218	3 76	(Pre)-03-45VI48	39 ⁷ / ₈ 1013	16 ¹ / ₂ 419	23 ³ / ₈ 594				
	4 101	(Pre)-04-45VI48	40 ³ / ₈ 1026	16 ³ / ₄ 425	23 ⁵ / ₈ 600				
	6 152	(Pre)-06-45VI48	40 ³ / ₈ 1026	16 ³ / ₄ 425	23 ⁵ / ₈ 600				
30° Vertical Inside Bend									
12 305	3 76	(Pre)-03-30VI12	12 ¹ / ₈ 308	3 ¹ / ₈ 83	6 ¹ / ₂ 165				
	4 101	(Pre)-04-30VI12	12 ³ / ₈ 314	3 ³ / ₈ 86	6 ⁵ / ₈ 163				
	6 152	(Pre)-06-30VI12	12 ³ / ₈ 314	3 ³ / ₈ 86	6 ⁵ / ₈ 163				
24 609	3 76	(Pre)-03-30VI24	18 ¹ / ₈ 461	4 ³ / ₄ 121	9 ³ / ₄ 248				
	4 101	(Pre)-04-30VI24	18 ³ / ₈ 467	4 ⁷ / ₈ 86	9 ⁷ / ₈ 163				
	6 152	(Pre)-06-30VI24	18 ³ / ₈ 314	4 ⁷ / ₈ 86	9 ⁷ / ₈ 163				
36 415	3 76	(Pre)-03-30VI36	24 ¹ / ₄ 616	6 ¹ / ₂ 165	13 330				
	4 101	(Pre)-04-30VI36	24 ¹ / ₂ 622	6 ⁵ / ₈ 168	13 ¹ / ₈ 334				
	6 152	(Pre)-06-30VI36	24 ¹ / ₂ 622	6 ⁵ / ₈ 168	13 ¹ / ₈ 334				
48 1218	3 76	(Pre)-03-30VI48	30 ³ / ₈ 772	8 ¹ / ₈ 207	16 ¹ / ₄ 413				
	4 101	(Pre)-04-30VI48	30 ⁵ / ₈ 778	8 ¹ / ₄ 210	16 ³ / ₈ 416				
	6 152	(Pre)-06-30VI48	30 ⁵ / ₈ 778	8 ¹ / ₄ 210	16 ³ / ₈ 416				

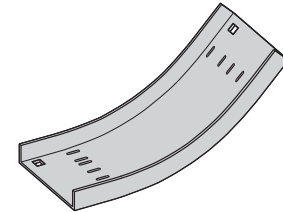

45° Vertical Inside Bend
Ventilated Vertical Inside Bend

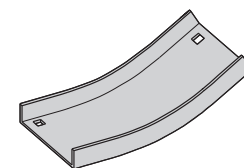
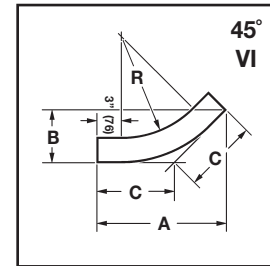

30° Vertical Inside Bend
Non-Ventilated Vertical Inside Bend

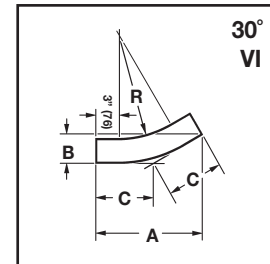

All dimensions in shaded areas are millimeters unless otherwise specified.
(Pre) See page 105 for catalog number prefix.