

Channel Cable Tray - Accessories

Splice Plate

The Splice Plate has the standard 4-hole pattern for all cable channel.

- Provided with straight sections and fittings.
- Furnished as one plate with hardware.
- (*) Insert **A** **G** **P** **SS4** **SS6**

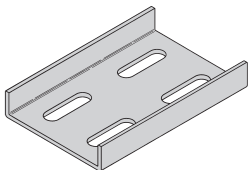

Catalog No.	Channel Width	
	in.	mm
9(*)-1043	3	76
9(*)-1044	4	101
9(*)-1044-6	6	152

Blind End Plate

The Blind End Plate forms a closure for any cable channel dead end.

- Furnished as one plate with hardware.
- (*) Insert **A** **G** **P** **SS4** **SS6**

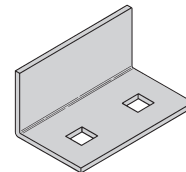

Catalog No.	Channel Width	
	in.	mm
9(*)-1583	3	76
9(*)-1584	4	101
9(*)-1586	6	152

Horizontal Adjustable Splice Plate

The Horizontal Adjustable Splice Plate adapts to changes in direction in a horizontal plane, beyond the capability of the standard horizontal fittings.

- Furnished as one plate with hardware.
- (*) Insert **A** **G** **P** **SS4** **SS6**

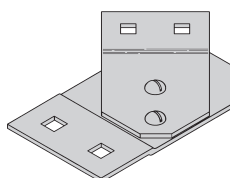

Requires supports within 24" on both sides, per NEMA VE 2.

Catalog No.	Channel Width	
	in.	mm
9(*)-1743	3	76
9(*)-1744	4	101
9(*)-1746	6	152

Vertical Adjustable Splice Plate

The Adjustable Splice Plate allows changes in elevation where standard vertical fittings are not applicable.

- Furnished as one plate with hardware.
- (*) Insert **A** **G** **P** **SS4** **SS6**

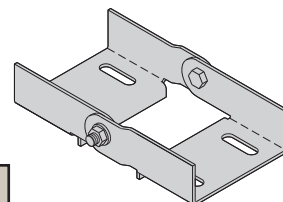

Requires supports within 24" on both sides, per NEMA VE 2.

Catalog No.	Channel Width	
	in.	mm
9(*)-1643	3	76
9(*)-1644	4	101
9(*)-1646	6	152

Box Connector

The Box Connector is used to attach the end of a cable channel run to a distribution box or a control center.

- Furnished as one connector with hardware.
- (*) Insert **A** **G** **P** **SS4** **SS6**

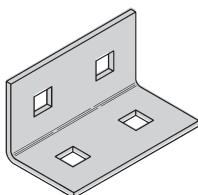

Catalog No.	Channel Width	
	in.	mm
9(*)-1543	3	76
9(*)-1544	4	101
9(*)-1546	6	152

Channel To Tray or Channel To Channel Connector

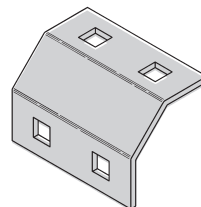

Channel to Channel

Channel to Tray



Catalog No.	Channel Width	
	in.	mm
9(*)-1261-3	3	76
9(*)-1261-4	4	101
9(*)-1261-6	6	152

The Channel Connector is used to link a cable channel to a cable tray, or a cable channel to cable channel.

- Furnished as one plate with hardware.
- (*) Insert **A** **G** **P** **SS4** **SS6**

Channel Reducer Plate

The Channel Reducer Plate is used to join cable channel sections of different widths.

- Furnished as one plate with hardware.
- (*) Insert **A** **G** **P** **SS4** **SS6**

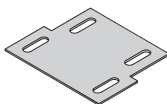

Catalog No.	Channel Width	
	in.	mm
9(*)-1843	4 to 3	101 to 76
9(*)-1863	6 to 3	152 to 76
9(*)-1864	6 to 4	152 to 101

Mounting Bracket - Channel To Tray

The Mounting Bracket allows a parallel run of cable channel to be attached to the side of a cable tray. It can also serve as a support splice connection.

- Furnished as one bracket.
- Order hardware separately.
- (*) Insert **A** **G** **ZN** **SS4** **SS6**

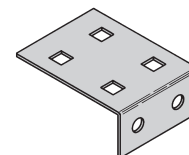

Catalog No.	Channel Width	
	in.	mm
9(*)-1237-3	3	76
9(*)-1237-4	4	101
9(*)-1237-6	6	152



All dimensions in shaded areas are millimeters unless otherwise specified.

● Green = Fastest shipped items ● Black = Normal lead-time items ● Red = Normally long lead-time items

Channel Cable Tray - Accessories

Expansion Guide Clamp

The Expansion Guide Clamp allows cable channel to expand and contract in the horizontal plane, but not in the transverse plane.

- Furnished as one clamp.
- Order 1/2" hardware separately.
- (*) Insert **A** **G** **ZN** **SS4** **SS6**

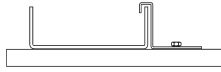

Catalog No.	Channel Width	
	in.	mm
9(*)-1243	3	76
9(*)-1244	4	101
9(*)-1244	6	152

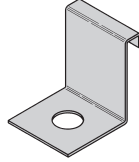

Hold-Down Clamp

The Hold-Down Clamp secures cable channel to a support member.

- Furnished as one clamp.
- Order 1/2" hardware separately.
- (*) Insert **A** **G** **ZN** **SS4** **SS6**



Catalog No.	Channel Width	
	in.	mm
9(*)-1245	3	76
9(*)-1246	4	101
9(*)-1246	6	152

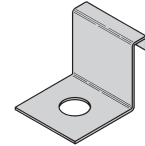

Channel To Floor Base Plate

The Channel to Floor Base Plate is used to attach the end of a cable channel run to the floor or to an equipment mounting pad.

- Anchors and hardware are ordered separately.
- (*) Insert **A** **G** **ZN** **SS4** **SS6**

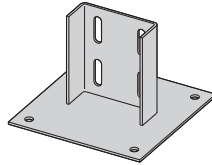

Catalog No.	Channel Width	
	in.	mm
9(*)-3305-3	3	76
9(*)-3305-4	4	101
9(*)-3305-6	6	152

Cable Channel Bushing

The Cable Channel Bushing is a snap-in plastic bushing used to protect cable insulation from mechanical wear.

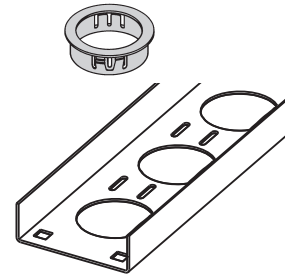

Catalog No.	99-1125
-------------	---------

Cable Channel Bracket

- Uniform Load: 225 lbs (1.00 kN)
Safety Factor of 2.5
- Finishes available: **ZN** **G**

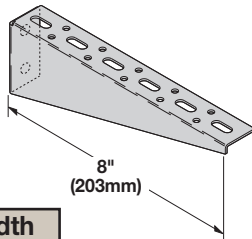

Catalog No.	Channel Width	
	in.	mm
B185CCL	3	76
	4	101
	6	152

Cable Channel Bracket

- Safety Factor of 2.5
- Finishes available: **ZN** **G** **GRN**

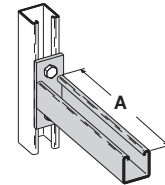

Catalog No.	Channel Width		Uniform Load		A	
	in.	mm	lbs	kN	in.	mm
B409-6	3	76	1920	8.54	6	152
B409-9	4, 6	101, 152	1280	5.69	9	228

Cable Channel Hanger

Designed for 1/2" Threaded Rod, Double Nut Installation

Single Cable Channel Hanger and Wall Mount

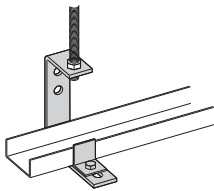

150 lb.
Safety Factor 3.0

Material	Channel Width							
	in.		mm		in.		mm	
	3	76	4	101	6	152		
Zinc Plated Steel	● 9ZN-1232-3		● 9ZN-1231-3 & 4		● 9ZN-1232-4		● 9ZN-1231-6	
	● 9ZN-1231-3 & 4		● 9ZN-1231-3 & 4		● 9ZN-1231-6		● 9ZN-1231-6	
HDGAF Steel (18 Ga.)	● 9G-1232-3		● 9G-1231-3 & 4		● 9G-1232-4		● 9G-1231-6	
	● 9G-1231-3 & 4		● 9G-1231-3 & 4		● 9G-1231-6		● 9G-1231-6	

Double Cable Channel Hanger

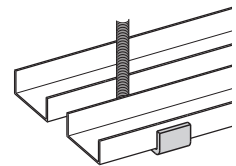

265 lb.
Safety Factor 3.0

All dimensions in shaded areas are millimeters unless otherwise specified.

● Green = Fastest shipped items ● Black = Normal lead-time items ● Red = Normally long lead-time items