

Mini Fittings

B6141 THREE HOLE SPLICE PLATE

- Standard finishes: ZN, GRN
- Wt./C 7 Lbs. (3.2 kg)

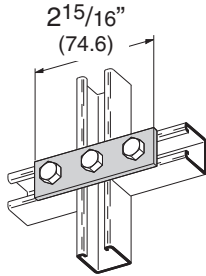

B600-62 THREE HOLE FLAT ADAPTER PLATE

- Standard finishes: ZN, GRN
- Wt./C 19 Lbs. (8.6 kg)

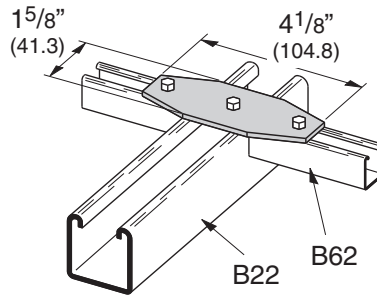

B6557 THREE HOLE SPLICE PLATE

- Standard finishes: ZN, GRN
- Wt./C 7 Lbs. (3.2 kg)

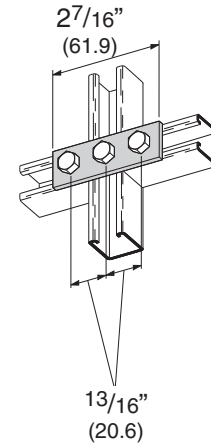

B6341 FOUR HOLE SPLICE PLATE

- Standard finishes: ZN, GRN
- Wt./C 11 Lbs. (5.0 kg)

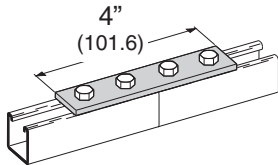

B6138 TWO HOLE SWIVEL PLATE

- Standard finishes: ZN, GRN
- Wt./C 7 Lbs. (3.2 kg)

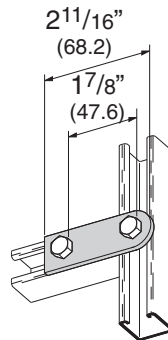

B6139 THREE HOLE SWIVEL PLATE

- Standard finishes: ZN, GRN
- Wt./C 10 Lbs. (4.5 kg)

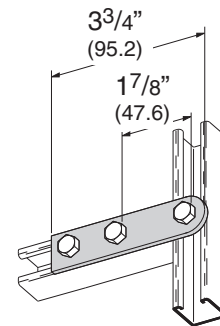

B6504 FOUR HOLE SPLICE PLATE

- Standard finishes: ZN, GRN
- Wt./C 10 Lbs. (4.5 kg)

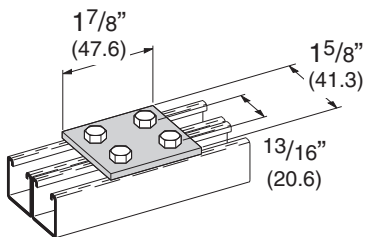

B6140 THREE HOLE CORNER PLATE

- Standard finishes: ZN, GRN
- Wt./C 8 Lbs. (3.6 kg)

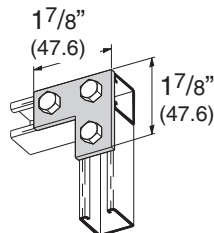

B6143 FOUR HOLE CORNER PLATE

- Standard finishes: ZN, GRN
- Wt./C 11 Lbs. (5.0 kg)

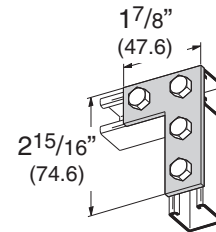

Reference page 200 for general fitting specifications.

B6133
FOUR HOLE TEE PLATE

- Standard finishes: ZN, GRN
- Wt./C 11 Lbs. (5.0 kg)

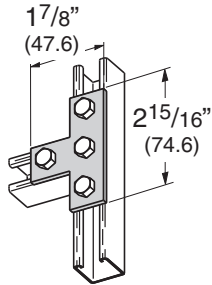

B6132
FIVE HOLE CROSS PLATE

- Standard finishes: ZN, GRN
- Wt./C 13 Lbs. (5.9 kg)

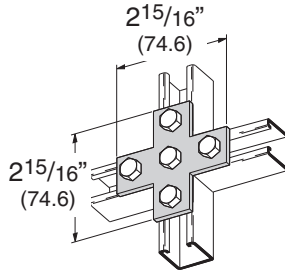

B6135
THREE HOLE CORNER GUSSET PLATE

- Standard finishes: ZN, GRN
- Wt./C 9 Lbs. (4.1 kg)

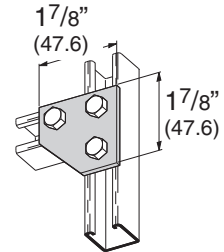

B6142
FOUR HOLE CORNER GUSSET PLATE

- Standard finishes: ZN, GRN
- Wt./C 15 Lbs. (6.8 kg)

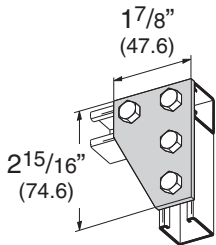

B6337
THREE HOLE TEE GUSSET PLATE

- Standard finishes: ZN, GRN
- Wt./C 10 Lbs. (4.5 kg)

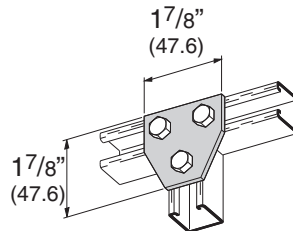

B6136
FOUR HOLE TEE GUSSET PLATE

- Standard finishes: ZN, GRN
- Wt./C 15 Lbs. (6.8 kg)

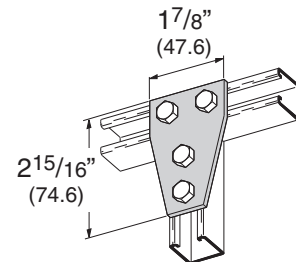

B6532
FIVE HOLE TEE GUSSET PLATE

- Standard finishes: ZN, GRN
- Wt./C 22 Lbs. (10.0 kg)

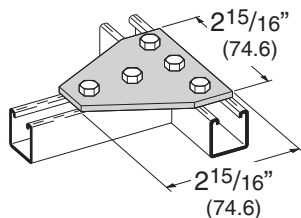

B6101
TWO HOLE CORNER ANGLE

- Standard finishes: ZN, GRN
- Wt./C 5 Lbs. (2.2 kg)

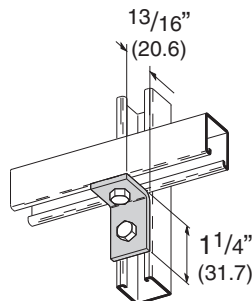

B6230
TWO HOLE CORNER ANGLE

- Standard finishes: ZN, GRN
- Wt./C 5 Lbs. (2.2 kg)

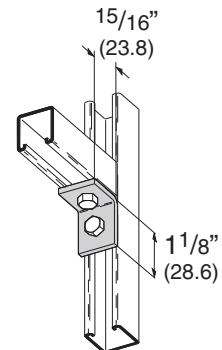

Reference page 200 for general fitting specifications.

Mini Fittings

B6102 THREE HOLE CORNER ANGLE

- Standard finishes: ZN, GRN
- Wt./C 8 Lbs. (3.6 kg)

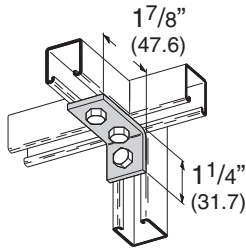

B6103 THREE HOLE CORNER ANGLE

- Standard finishes: ZN, GRN
- Wt./C 8 Lbs. (3.6 kg)

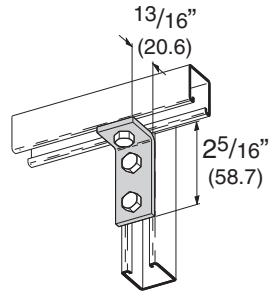

B6232 THREE HOLE CORNER ANGLE

- Standard finishes: ZN, GRN
- Wt./C 7 Lbs. (3.2 kg)

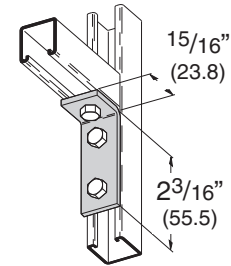

B6374 THREE HOLE CORNER ANGLE

- Standard finishes: ZN, GRN
- Wt./C 7 Lbs. (3.2 kg)

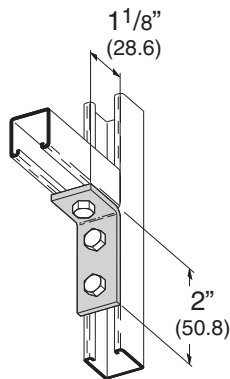

B6104 FOUR HOLE CORNER ANGLE

- Standard finishes: ZN, GRN
- Wt./C 10 Lbs. (4.5 kg)

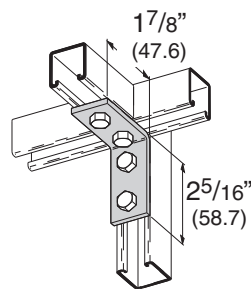

B6558 FOUR HOLE CORNER ANGLE

- Standard finishes: ZN, GRN
- Wt./C 10 Lbs. (4.5 kg)

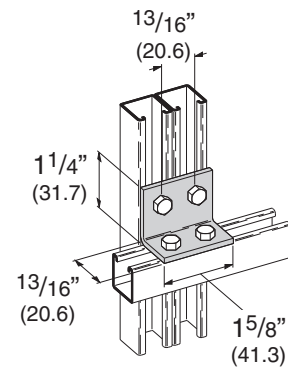

B6357 FOUR HOLE OFFSET BENT TEE

- Standard finishes: ZN, GRN
- Wt./C 11 Lbs. (5.0 kg)

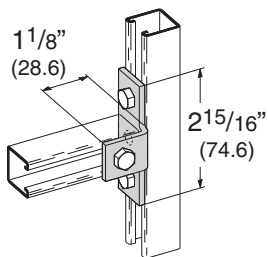

B6239 FIVE HOLE OFFSET BENT TEE

- Standard finishes: ZN, GRN
- Wt./C 14 Lbs. (6.3 kg)

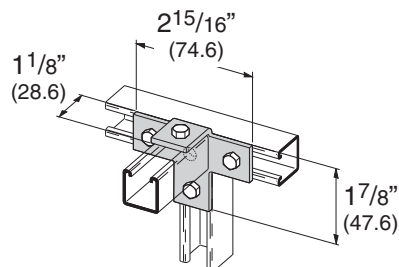

B6144R&L FOUR HOLE SHELF BRACKET

- Standard finishes: ZN, GRN
- Wt./C 19 Lbs. (8.6 kg)

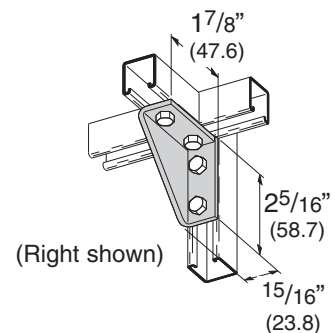

Reference page 200 for general fitting specifications.

B6134R&L FOUR HOLE CORNER GUSSET

- Standard finishes: ZN, GRN
- Wt./C 15 Lbs. (6.8 kg)

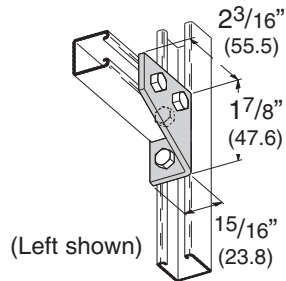

B6234 R&L FOUR HOLE CORNER GUSSET

- Standard finishes: ZN, GRN
- Wt./C 15 Lbs. (6.8 kg)

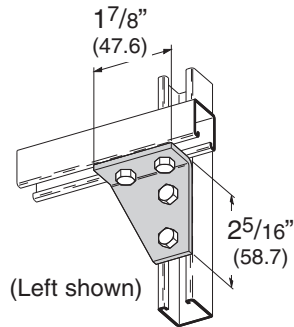

B6118 FOUR HOLE GUSSETED SHELF ANGLE

- Standard finishes: ZN, GRN
- Wt./C 15 Lbs. (6.8 kg)

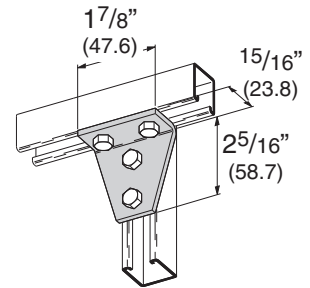

B6533 FIVE HOLE GUSSETED SHELF ANGLE

- Standard finishes: ZN, GRN
- Wt./C 22 Lbs. (10.0 kg)

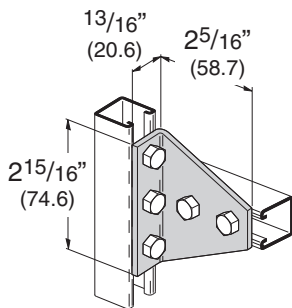

B6126 FOUR HOLE GUSSETED THREE WAY SHELF ANGLE

- Standard finishes: ZN, GRN
- Wt./C 15 Lbs. (6.8 kg)

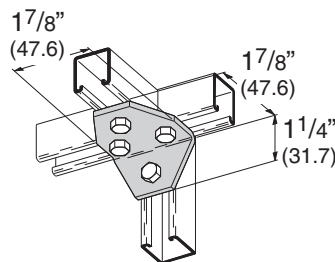

B6127 FIVE HOLE GUSSETED THREE WAY SHELF ANGLE

- Standard finishes: ZN, GRN
- Wt./C 18 Lbs. (8.1 kg)

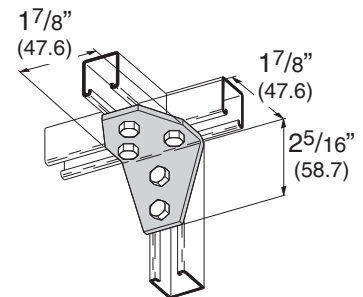

B6112 FOUR HOLE ADJUSTABLE CORNER ANGLE

- Standard finishes: ZN, GRN
- Wt./C 32Lbs. (14.5 kg)

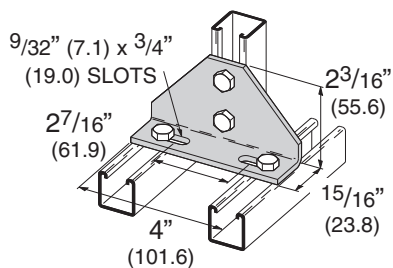

B589-62 TWO HOLE 90° ADAPTER ANGLE

- Standard finishes: ZN, GRN
- Wt./C 11 Lbs. (5.0 kg)

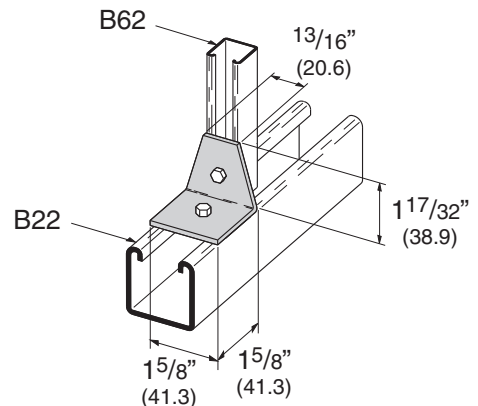

Reference page 200 for general fitting specifications.

Mini Fittings

B6147-B6152 TWO HOLE OPEN ANGLE

- Standard finishes: ZN, GRN

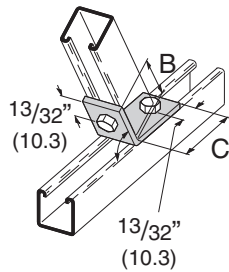

Part No.	A	B	C	Wt./C	
				Lbs.	kg
B6147	82 1/2°	2 1/32" (51.6)	27/32" (21.4)	8.0	(3.6)
B6148	75°	2 1/32" (51.6)	27/32" (21.4)		
B6149	67 1/2°	2" (50.8)	7/8" (22.2)		
B6150	60°	1 31/32" (50.0)	1 5/16" (23.8)		
B6151	52 1/2°	1 7/8" (47.6)	1 1/16" (27.0)		
B6152	37 1/2°	2" (50.8)	29/32" (23.0)		

B6154 TWO HOLE OPEN ANGLE

- Standard finishes: ZN, GRN
- Wt./C 8 Lbs. (3.6 kg)

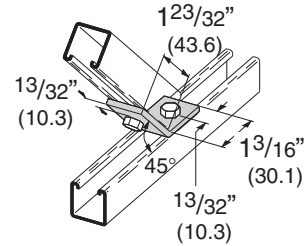

B6162-B6165 TWO HOLE OPEN ANGLE

- Standard finishes: ZN, GRN

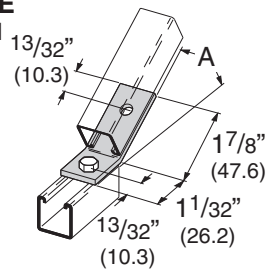

Part No.	A	Wt./C	
		Lbs.	kg
B6162	30°	8.0	(3.6)
B6163	22 1/2°		
B6164	15°		
B6165	7 1/2°		

B6156-B6161 TWO HOLE CLOSED ANGLE

- Standard finishes: ZN, GRN

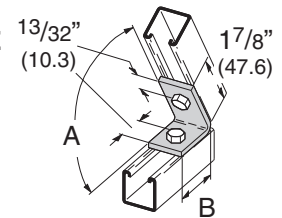

Part No.	A	B	Wt./C	
			Lbs.	kg
B6156	82 1/2°	19/32" (32.5)	8.0	(3.6)
B6157	75°	15/16" (33.3)		
B6158	67 1/2°	13/8" (34.9)		
B6159	60°	1 13/32" (35.7)		
B6160	52 1/2°	1 15/32" (37.3)		
B6161	37 1/2°	1 21/32" (42.0)		

B6155 TWO HOLE CLOSED ANGLE

- Standard finishes: ZN, GRN
- Wt./C 8 Lbs. (3.6 kg)

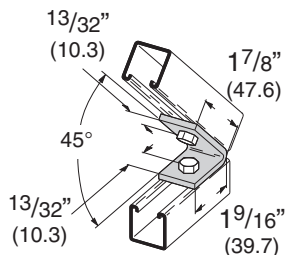

B601-62 TWO HOLE 45° ADAPTER ANGLE

- Standard finishes: ZN, GRN
- Wt./C 14 Lbs. (6.3 kg)

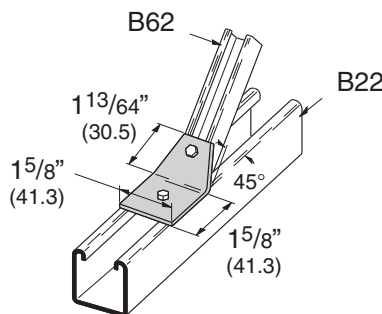

B6169 TWO HOLE SPLICE CLEVIS FOR B72

- Standard finishes: ZN, GRN
- Wt./C 11 Lbs. (5.0 kg)

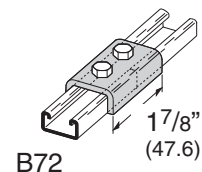

Reference page 200 for general fitting specifications.

B6168
THREE HOLE SPLICE CLEVIS FOR B72

- Standard finishes: ZN, GRN
- Wt./C 16 Lbs. (7.2 kg)

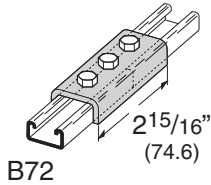

B6167
FOUR HOLE SPLICE CLEVIS FOR B72

- Standard finishes: ZN, GRN
- Wt./C 24 Lbs. (10.9 kg)

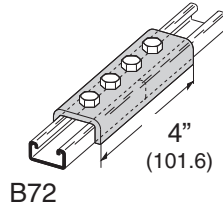

B6170
TWO HOLE SPLICE CLEVIS FOR B62

- Standard finishes: ZN, GRN
- Wt./C 17 Lbs. (7.7 kg)

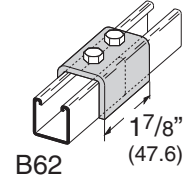

B6171
THREE HOLE SPLICE CLEVIS FOR B62

- Standard finishes: ZN, GRN
- Wt./C 26 Lbs. (11.8 kg)

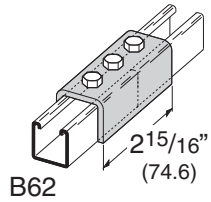

B6172
FOUR HOLE SPLICE CLEVIS FOR B62

- Standard finishes: ZN, GRN
- Wt./C 36 Lbs. (16.3 kg)

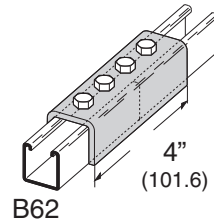

B7116
THREE HOLE U-SUPPORT

- Standard finishes: ZN, GRN
- Wt./C 10 Lbs. (4.5 kg)

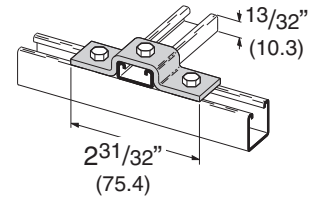

B6107
THREE HOLE U-SUPPORT

- Standard finishes: ZN, GRN
- Wt./C 12 Lbs. (5.4 kg)

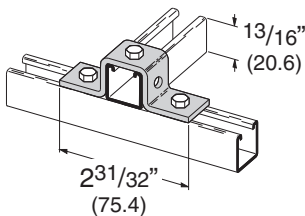

B6107-62A
THREE HOLE U-SUPPORT

- Standard finishes: ZN, GRN
- Wt./C 16 Lbs. (7.2 kg)

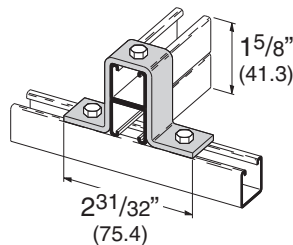

B6594
FIVE HOLE U-SUPPORT

- Standard finishes: ZN, GRN
- Wt./C 13 Lbs. (5.9 kg)

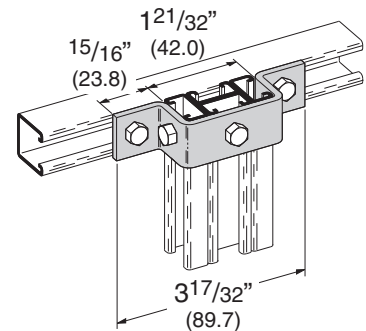

Reference page 200 for general fitting specifications.

Mini Fittings

B6173 FOUR HOLE CLEVIS

- Standard finishes: ZN, GRN
- Wt./C 9 Lbs. (4.1 kg)

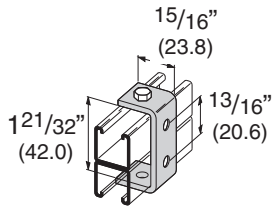

B6526 TWO HOLE OFFSET Z-SUPPORT

- Standard finishes: ZN, GRN
- Wt./C 5 Lbs. (2.2 kg)

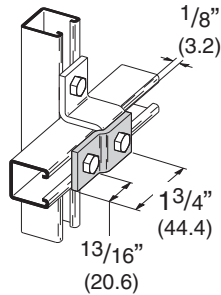

B6105 TWO HOLE Z-SUPPORT FOR B62

- Standard finishes: ZN, GRN
- Wt./C 7 Lbs. (3.2 kg)

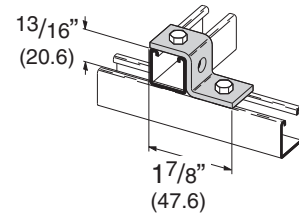

B7105 TWO HOLE Z-SUPPORT FOR B72

- Standard finishes: ZN, GRN
- Wt./C 7 Lbs. (3.2 kg)

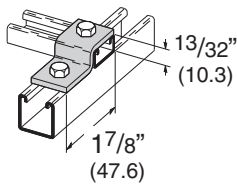

B6110 TWO HOLE Z-SUPPORT FOR B62A

- Standard finishes: ZN, GRN
- Wt./C 9 Lbs. (4.1 kg)

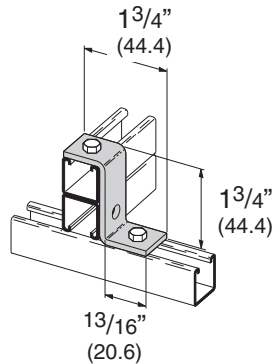

B6108 TWO HOLE OFFSET Z-SUPPORT

- Standard finishes: ZN, GRN
- Wt./C 7 Lbs. (3.2 kg)

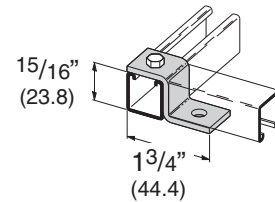

B598-62 TWO HOLE Z-ADAPTER PLATE

- Standard finishes: ZN, GRN
- Wt./C 28 Lbs. (12.7 kg)

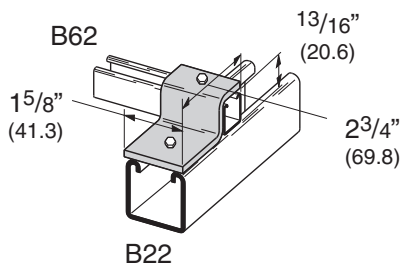

B6571 EIGHT HOLE WING CONNECTION

- Standard finishes: ZN, GRN
- Wt./C 28 Lbs. (12.7 kg)

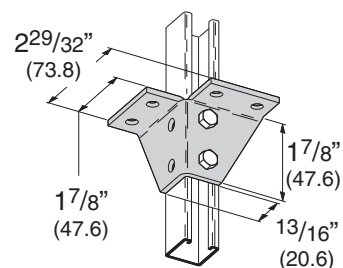

Reference page 200 for general fitting specifications.

B6205 END CAP FOR B62

- Material: ASTM A1008 SS Gr. 33 Type 1
- Standard finishes: ZN, GRN
- Wt./C 3 Lbs. (1.3 kg)

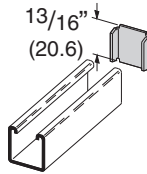

B7205 END CAP FOR B72

- Material: ASTM A1008 SS Gr. 33 Type 1
- Standard finishes: ZN, GRN
- Wt./C 1 Lb. (.4 kg)

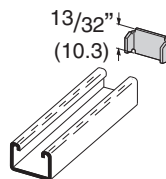

B6211 Z-BEAM CLAMP

- 5/16"-18 Setscrew included
- 13/16" (20.6) Max. Flange Thickness
- Material: ASTM A36
- Standard finishes: ZN, GRN
- Wt./C 13 Lbs. (5.9 kg)

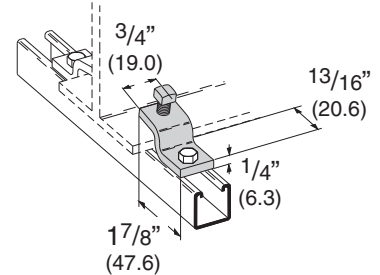

B6409-6, 9 BRACKET

- Safety Factor of 2
- Uniform Design Load 40 Lbs. (.18 kN)
- Standard finishes: ZN, GRN

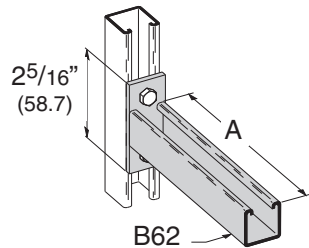

Part No.	A	Wt./C	
		Lbs.	kg
B6409-6	6"	28.0	(12.7)
B6409-9	9"	35.0	(15.8)

B2350-B2355 ONE HOLE DOUBLE TUBING STRAP

- Material: ASTM A1008 SS Gr. 33 Type 1
- Standard finishes: ZN, GRN

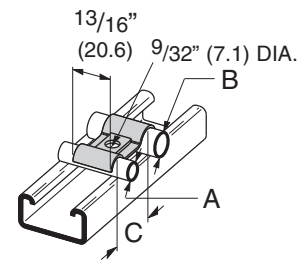

Part No.	O.D. Size A		O.D. Size B		C		Wt./C	
	Lbs.	kg	Lbs.	kg	Lbs.	kg	Lbs.	kg
B2350	1/4"	(6.3)	1/4"	(6.3)	3/4"	(19.0)	1.2	(.5)
B2351	3/8"	(9.5)	3/8"	(9.5)	1"	(25.4)	2.0	(.9)
B2352	1/2"	(12.7)	1/2"	(12.7)	1 1/4"	(31.7)	2.9	(1.3)
B2353	1/4"	(6.3)	3/8"	(9.5)	7/8"	(22.2)	1.6	(.7)
B2354	1/4"	(6.3)	1/2"	(12.7)	1"	(25.4)	2.1	(.9)
B2355	3/8"	(9.5)	1/2"	(12.7)	1 1/8"	(28.6)	2.5	(1.1)

B2308-B2315 ONE HOLE TUBING STRAP

- Material: Sizes 1/4" - 1/2", ASTM A611 Gr. C
- 5/8" - 1", ASTM A1008 SS Gr. 33 Type 1
- Standard finishes: ZN, GRN

Part No.	O.D. Size A		B		C		Wt./C	
	Lbs.	kg	Lbs.	kg	Lbs.	kg	Lbs.	kg
B2308	1/4"	(6.3)	1 1/32"	(26.2)	.048	(1.2)	1.2	(.5)
B2309	5/16"	(7.9)	1 3/32"	(27.8)	.048	(1.2)	1.4	(.6)
B2310	3/8"	(9.5)	1 3/16"	(30.1)	.048	(1.2)	1.6	(.7)
B2311	1/2"	(12.7)	1 21/64"	(33.7)	.048	(1.2)	1.9	(.8)
B2312	5/8"	(15.9)	1 25/64"	(35.3)	.062	(1.6)	2.7	(1.2)
B2313	3/4"	(19.0)	1 39/64"	(40.9)	.075	(1.9)	4.3	(1.9)
B2314	7/8"	(22.2)	1 51/64"	(45.6)	.075	(1.9)	4.9	(2.2)
B2315	1"	(25.4)	2 1/32"	(51.6)	.075	(1.9)	5.2	(2.3)

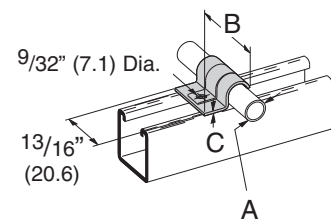

Reference page 200 for general fitting specifications.