

B527 THREE HOLE OFFSET PLATE CONNECTION

- Standard finishes: ZN, GRN
- Wt./C 54 Lbs. (24.5 kg)

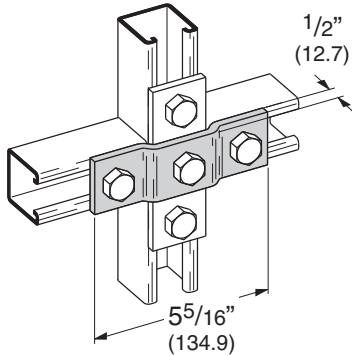

B116-52 THREE HOLE U-SUPPORT

- Standard finishes: ZN, GRN
- Wt./C 70 Lbs. (31.7 kg)

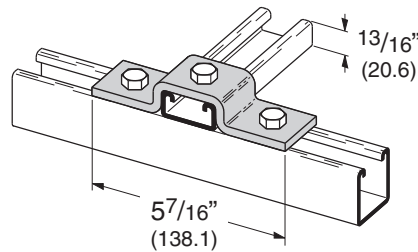

B116-42 THREE HOLE U-SUPPORT

- Standard finishes: ZN, GRN
- Wt./C 75 Lbs. (34.0 kg)

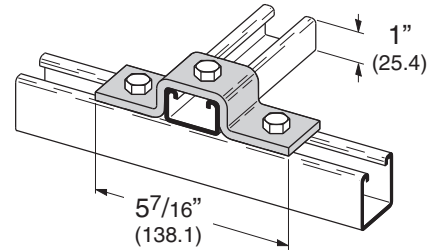

B116-32 THREE HOLE U-SUPPORT

- Standard finishes: ZN, GRN
- Wt./C 84 Lbs. (38.1 kg)

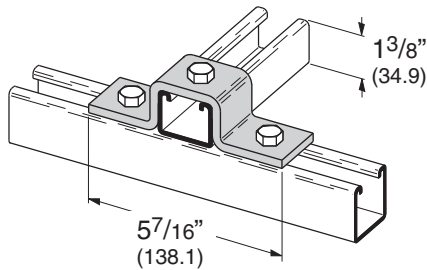

B116-32A THREE HOLE U-SUPPORT

- Standard finishes: ZN, GRN
- Wt./C 116 Lbs. (52.6 kg)

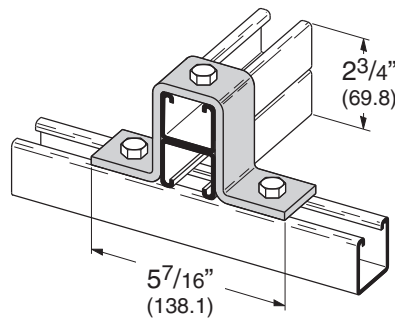

B116-12 THREE HOLE U-SUPPORT

- Standard finishes: ZN, GRN
- Wt./C 108 Lbs. (49.0 kg)

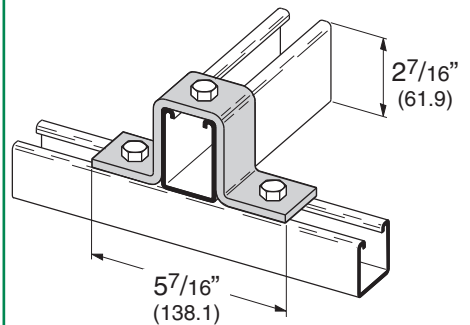

B107 FIVE HOLE U-SUPPORT

- Standard finishes: ZN, GRN, HDG
- Wt./C 85 Lbs. (38.5 kg)

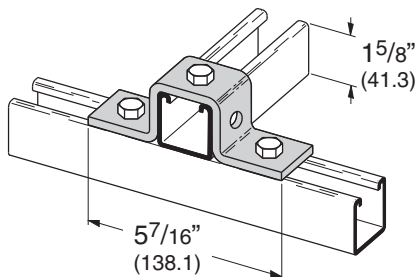

B107-22A THREE HOLE U-SUPPORT

- Standard finishes: ZN, GRN
- Wt./C 126 Lbs. (57.1 kg)

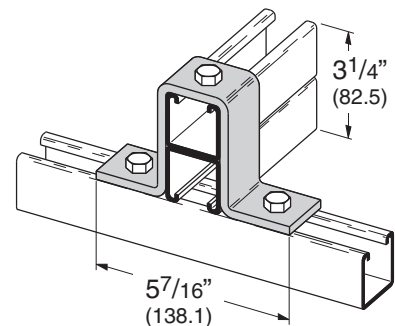

B588 THREE HOLE U-SUPPORT

- Standard finishes: ZN, GRN
- Wt./C 157 Lbs. (71.2 kg)

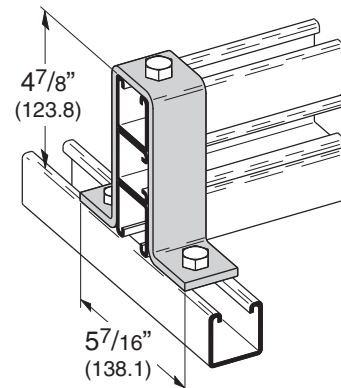

Reference page 72 for general fitting and standard finish specifications.

PA Preassembled fitting.

'U' Fittings

B412 THREE HOLE OFFSET U-SUPPORT

- Standard finishes: ZN, GRN
- Wt./C 89 Lbs. (40.3 kg)

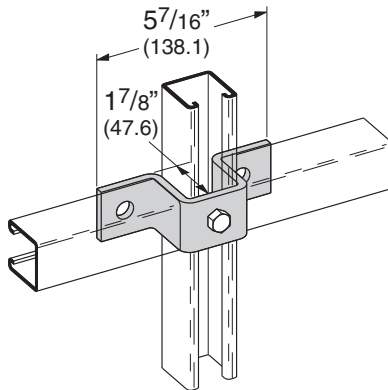

B107S FIVE HOLE U-SUPPORT

- Material: 7 Gauge (4.5)
ASTM A1011 33,000 PSI min. yield
- Standard finishes: ZN, GRN
- Wt./C 51 Lbs. (23.1 kg)

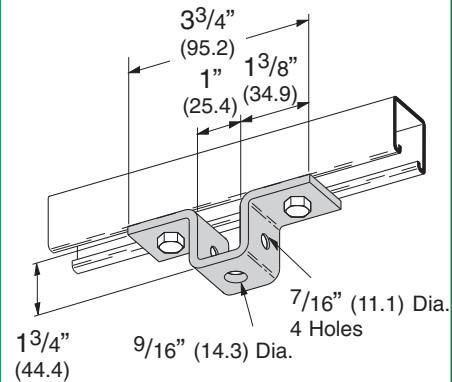

B596 THREE HOLE SWIVEL CLEVIS

- Standard finishes: ZN, GRN
- Wt./C 53 Lbs. (24.0 kg)

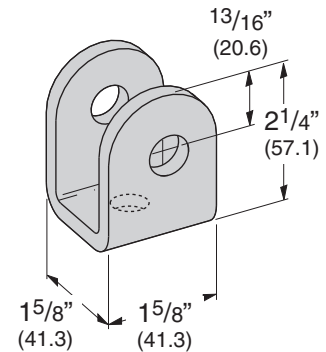

B578 THREE HOLE LIGHT-WEIGHT U-SUPPORT

- Material: 10 Gauge (3.4)
ASTM A1011 HSLAS Gr. 50
- Standard finishes: ZN, GRN
- Wt./C 18 Lbs. (8.1 kg)

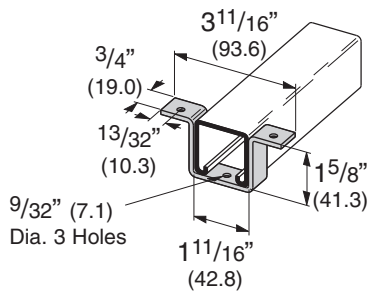

B594 FIVE HOLE U-SUPPORT

- Standard finishes: ZN, GRN
- Wt./C 106 Lbs. (48.1 kg)

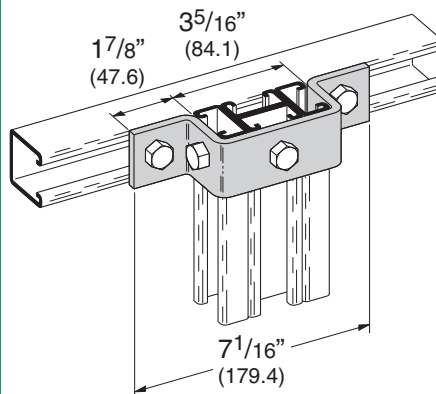

B266 SIX HOLE U-SUPPORT

- Standard finishes: ZN, GRN
- Wt./C 105 Lbs. (47.6 kg)

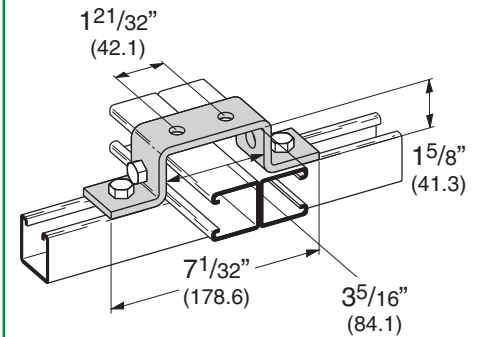

B425 SIX HOLE U-SUPPORT

- Standard finishes: ZN, GRN
- Wt./C 167 Lbs. (75.7 kg)

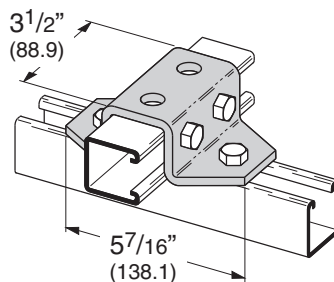

B581 EIGHT HOLE U-SUPPORT

- Standard finishes: ZN, GRN
- Wt./C 201 Lbs. (91.2 kg)

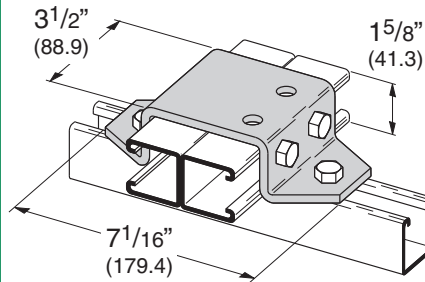

B519 EIGHT HOLE U-SUPPORT

- Standard finishes: ZN, GRN
- Wt./C 266 Lbs. (102.5 kg)

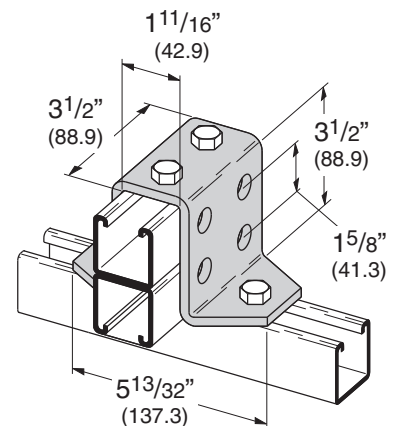

Reference page 72 for general fitting and standard finish specifications.

B333 SLOTTED THREE HOLE U-SUPPORT FOR B22

- Standard finishes: ZN, GRN

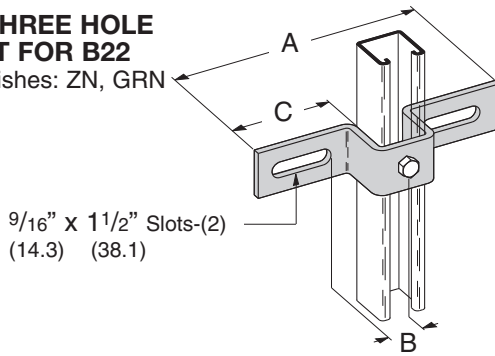

Part No.	A		B		C		Wt./C	
	(A)	(A)	(B)	(B)	(C)	(C)	Lbs.	kg
B333-1	7 ¹ / ₂ "	(190.5)	15 ¹ / ₁₆ "	(33.3)	27 ⁷ / ₈ "	(73.0)	103	(46.7)
B333-2	8 ¹ / ₂ "	(215.9)	1 ¹⁵ / ₁₆ "	(49.2)	3 ³ / ₈ "	(85.7)	115	(52.1)
B333-3	10 ³ / ₈ "	(263.5)	27 ⁷ / ₈ "	(73.0)	45 ¹ / ₁₆ "	(109.5)	135	(61.2)

B451 SLOTTED THREE HOLE U-SUPPORT WITH GUSSET FOR B22

- Consists of B333-1, 2, or 3 with gusset plate welded on back.
- Material: ASTM A1011 HSLAS Gr. 50
- Standard finishes: ZN, GRN

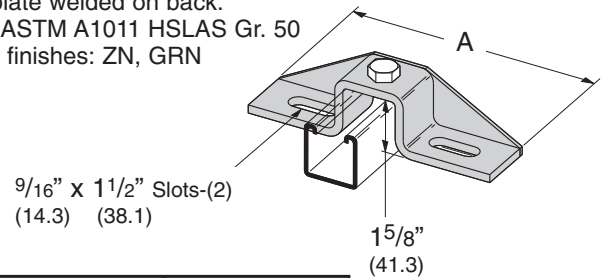

Part No.	A		Wt./C	
	(A)	(A)	Lbs.	kg
B451-1	7 ¹ / ₂ "	(190.5)	137	(62.1)
B451-2	8 ¹ / ₂ "	(215.9)	156	(70.7)
B451-3	10 ³ / ₈ "	(263.5)	172	(78.0)

B408 TWO HOLE BUS DUCT CLEVIS

- Standard finishes: ZN, GRN

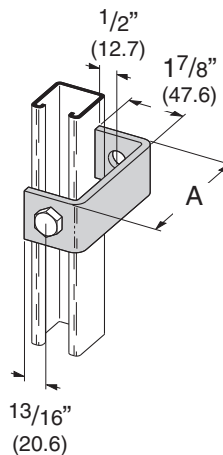

Part No.	A		Wt./C	
	(A)	(A)	Lbs.	kg
B408-1	2 ¹³ / ₃₂ "	(61.1)	58	(26.3)
B408-2	3 ²⁵ / ₃₂ "	(96.0)	76	(34.5)
B408-3	4 ³ / ₄ "	(762.0)	88	(39.9)

B358 TWO HOLE CLEVIS

- Standard finishes: ZN, GRN

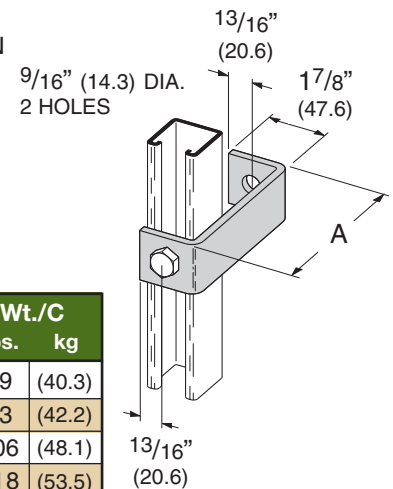

Part No.	A		Wt./C	
	(A)	(A)	Lbs.	kg
B358-4	4"	(101.6)	89	(40.3)
B358-5	5"	(127.0)	93	(42.2)
B358-6	6"	(152.4)	106	(48.1)
B358-7	7"	(177.8)	118	(53.5)
B358-8	8"	(203.2)	132	(59.9)

B173 FOUR HOLE CLEVIS

- Standard finishes: ZN, GRN
- Wt./C 71 Lbs. (32.2 kg)

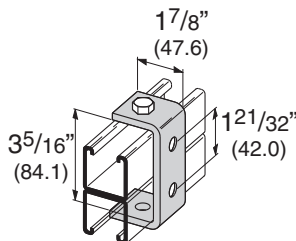

B595 THREE HOLE CLEVIS

- Standard finishes: ZN, GRN
- Wt./C 75 Lbs. (34.0 kg)

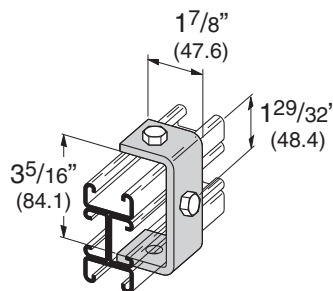

B405 THREE HOLE SUSPENSION CLEVIS

- Standard finishes: ZN, GRN
- Wt./C 75 Lbs. (34.0 kg)

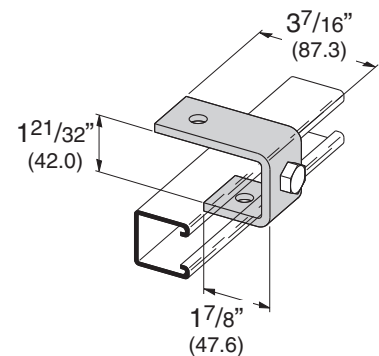

Reference page 72 for general fitting and standard finish specifications.

'U' Fittings

B398-1 THREE HOLE CUP SUPPORT

- Standard finishes: ZN, GRN
- Wt./C 73 Lbs. (33.1 kg)

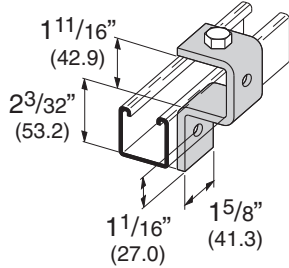

B415 TWO HOLE BUS DUCT CONNECTION

- Standard finishes: ZN, GRN
- Wt./C 56 Lbs. (25.4 kg)

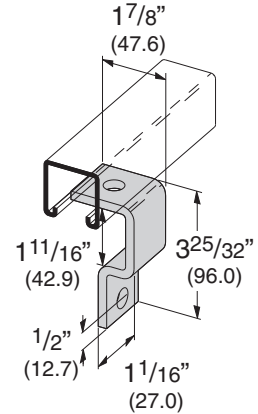

B400 THREE STUD RING CONNECTION

- 1/2"-13 stud protrudes 1" (25.4mm)
- Standard finishes: ZN
- Wt./C 85 Lbs. (38.5 kg)

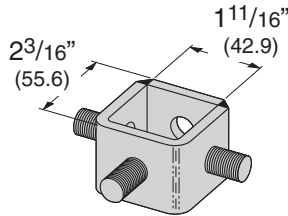

B400-1 ONE STUD RING CONNECTION

- 1/2"-13 stud protrudes 1" (25.4mm)
- Standard finishes: ZN
- Wt./C 53 Lbs. (24.0 kg)

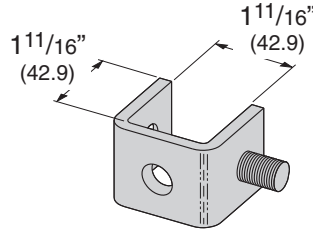

B400-2 ONE STUD RING CONNECTION

- 1/2"-13 stud protrudes 1" (25.4mm)
- Standard finishes: ZN
- Wt./C 40 Lbs. (18.1 kg)

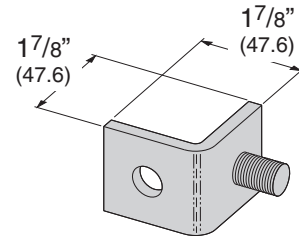

B400-3 TWO STUD RING CONNECTION

- 1/2"-13 stud protrudes 1" (25.4mm)
- Standard finishes: ZN
- Wt./C 59 Lbs. (26.7 kg)

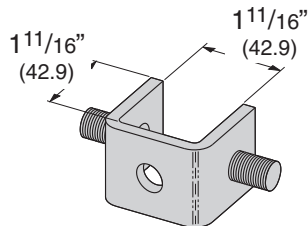

B400-4 TWO STUD RING CONNECTION

- 1/2"-13 stud protrudes 1" (25.4mm)
- Standard finishes: ZN
- Wt./C 59 Lbs. (26.7 kg)

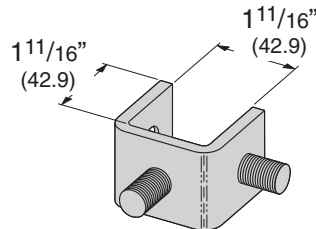

B536 TAPPED U-SUPPORT

- Standard finishes: ZN
- Wt./C 87 Lbs. (39.4 kg)

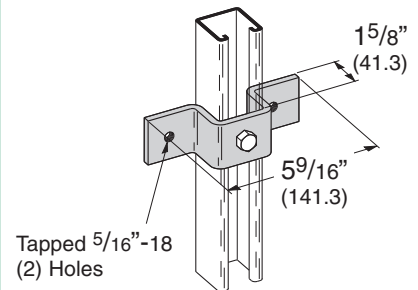

Reference page 72 for general fitting and standard finish specifications.